

TOWN OF BERLIN - ZONING

BERLIN

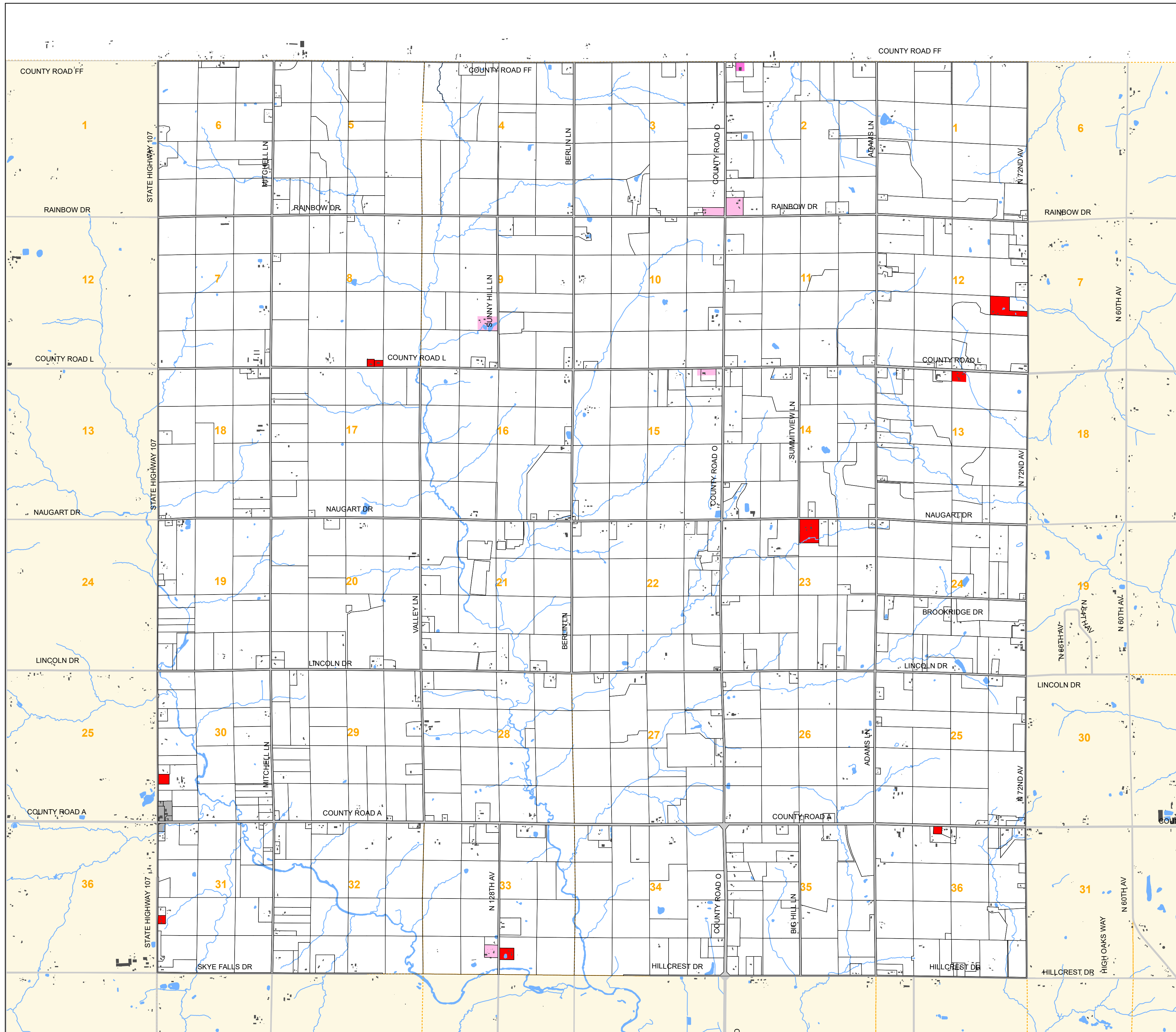
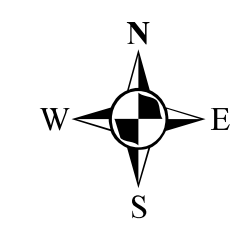

CLASSIFICATIONS

	RS-1/20		A-4
	RS-1/40		A-4-M
	RS-2		AR
	RM		AR/M
	RP		AE
	CV		AE/M
	RC		C-1
	A-1		M-1
	A-2		M-2
	A-3		UV
	A-3-M		

Other Zoning

Features

	Parcels
	Buildings 2010
	Sections Lines (est.)
	Water Features
	Other Municipality

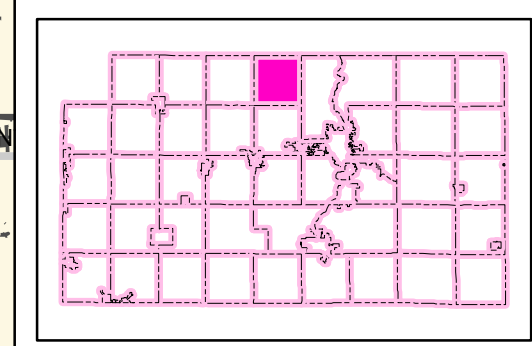

Base Map Features from May 2000/2005/2010 Aerial Photography.

This is NOT a Legal Survey Document. This is current interpretation of Tax Parcel Status

Map Developed by Marathon County Conservation, Planning & Zoning Dept

APPROVAL DATE: 28-JUL-1998
 REVISION DATE: 23-FEB-2011

Town Authoritative Data Source
 Contact Town

Map Print Date: 8/21/2023

Path: P:\gisdata\zoning\independent_townsmaps\berlin_zoning.mxd