

December 11, 2023

Request for Public Comments

ID 9517-04-02 (72)

Town of Holton, Pope Avenue
West Branch of the Big Eau Pleine River Bridge
Marathon County

The Town of Holton in cooperation with the Marathon County Highway Department and the Wisconsin Department of Transportation (WisDOT) is in the process of developing plans to replace the Pope Avenue bridge over the unnamed tributary of the west branch of the Big Eau Pleine River.

The enclosed handout outlines the following information:

- Project location
- Project needs
- Proposed improvements
- Traffic impacts
- Scheduled

The objective of this Public Outreach is to provide adjacent property owners, interested citizens, and public officials with an opportunity to comment on the design for this improvement.

The enclosed project information can also be found on Marathon County's website at:
<https://www.marathoncounty.gov/projects-planning/highway-projects-public-involvement>

Public input/comments

Please submit comments or questions via one of the following methods by **January 8, 2024**.

1. Fill out the comment form attached to the enclosed handout, fold, and mail.
2. Email comments or questions either of the contacts listed in the handout.
3. Call one of the contacts listed in the handout.

If you have any questions, comments or suggestions that may assist in the development of this project, we look forward to hearing from you.

Sincerely,



Stephanie G. Christensen, P.E.
Project Manager
schristensen@emcsinc.com
(715) 318-9017

cc: James Griesbach, Highway Commissioner, Marathon County Highway Department

Enclosure: project handout with tear-off comment form

Public Involvement Handout

**Town of Holton, Pope Avenue
Unnamed Tributary to the West Branch Big Eau Pleine River
Existing Structure: P-37-0960
Proposed Structure: B-37-0476
Local Street
Marathon County**

Project ID: 9517-04-02 (72)



Handout date: December 11, 2023

Thank you for your interest in this project. We look forward to your feedback.

Purpose of handout

The Town of Holton in cooperation with the Marathon County Highway Department and the Wisconsin Department of Transportation (WisDOT) is in the process of developing plans to replace the Pope Avenue bridge over the unnamed tributary of the west branch of the Big Eau Pleine River.

The purpose of this handout is to provide information regarding the proposed improvements, describe the potential impacts it would have on the community, and offer an opportunity for public comment.

Public input/comments

Your comments assist us in developing a project that will serve the needs of the traveling public, as well as the needs of the local community and are welcomed and appreciated throughout the design process. Included at the end of this handout is a comment form that may be used for written comments regarding the proposed improvements. You are encouraged to fill out this form and return using the common form attached. Comments may also be submitted via email or phone to the contact listed below.

Project location

The project is located on Pope Avenue bridge over the unnamed tributary of the west branch of the Big Eau Pleine River.

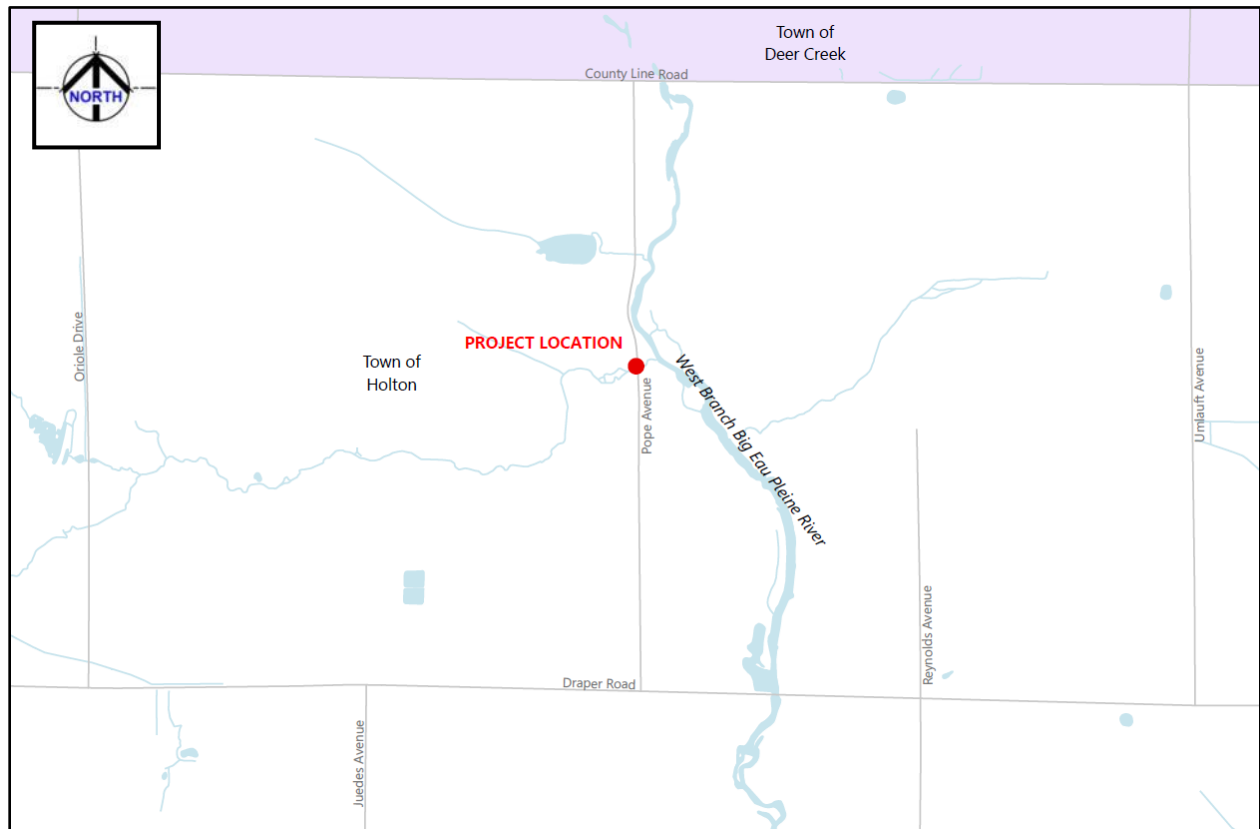

Project purpose and need

The existing single span bridge (P-37-0960) is a single span concrete deck bridge. The bridge was constructed in 1930 and is deteriorated throughout the structure with cracking and spalling (breaking) concrete. The existing concrete railing does not meet modern safety standards.

The existing bridge has reached the end of its useful service life and cannot be economically rehabilitated.



Existing Bridge

Proposed improvements

The project is programmed as a bridge replacement project. The Town of Holton has received federal funding through WisDOT to replace the bridge. The Marathon County Highway Department is administering the design process on behalf of the town.

Proposed improvements include:

- Construction of a single span concrete slab span bridge approximately 44-feet long.
- Reconstruction of approximately 155-feet of roadway approaches.
 - 50-feet of each approach would be paved with asphaltic surface to provide a smooth transition to the bridge and keep roadway aggregate off the bridge.
- Place riprap (stone) to prevent erosion along the river.
- All work is anticipated to occur inside the existing right-of-way.

See a preliminary plans on the following page.

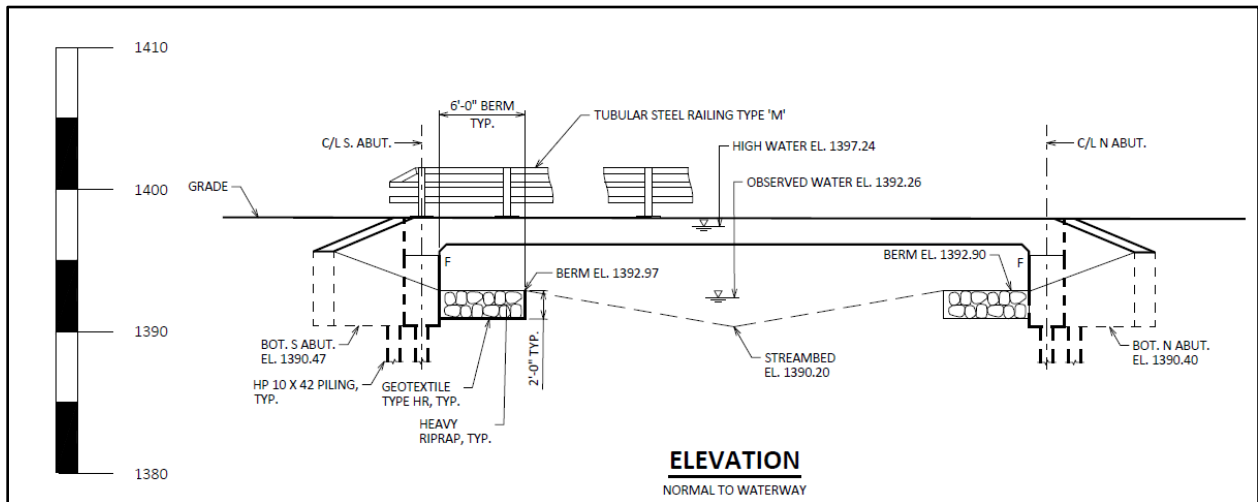
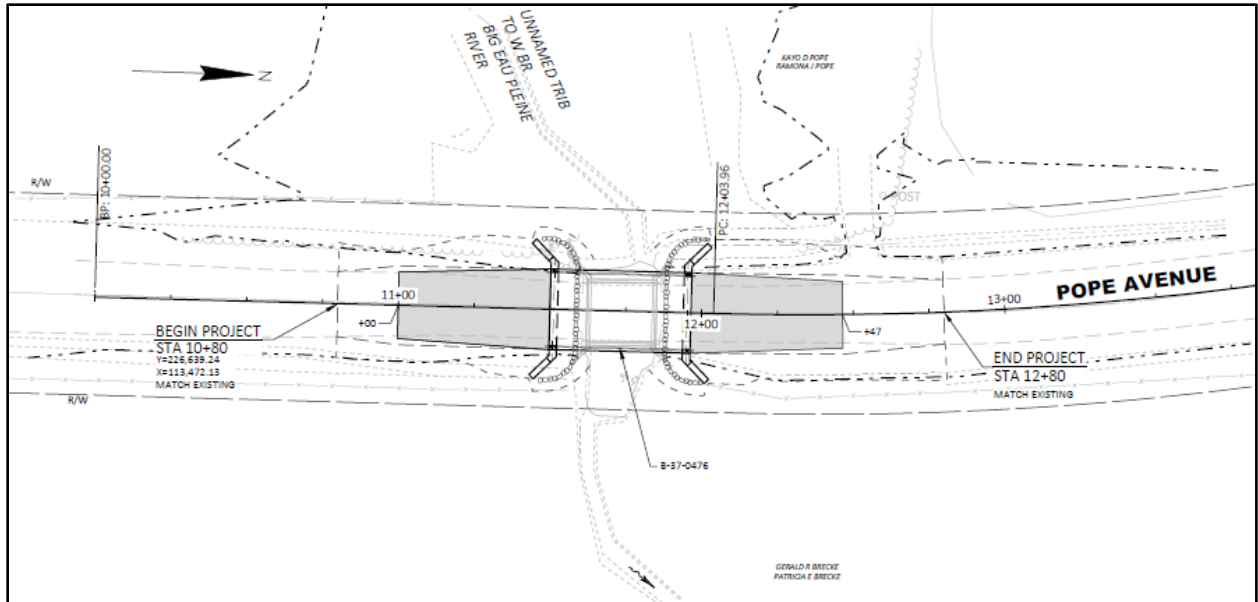

Preliminary Plan of Improvements

Traffic impacts

- Construction is currently scheduled for 2025.
- Work will occur after June 15 due to in-water working restrictions.
- The bridge will be closed for approximately 3 months.
- Local access to property owners and emergency services will be maintained from County Line Road (north of bridge) and Draper Road (south of bridge).

Schedule

- Initial data collection and design development – summer/fall 2023
- Local officials meeting – December 6, 2023
- Public involvement comment period – December 2024/January 2024
- Preliminary plans and reports approved – winter 2023
- Environmental document – winter 2023
- Final plans – August 1, 2024
- Construction – summer 2025

Public input/comments

Please submit comments using one of the following methods so that we receive them by **January 8, 2024**, to be considered during design.

1. Fill out the comment form attached to this document and mail to the project engineer.
2. Email comments or questions to the contact listed below.
3. Call the contact below.

Project contact

James Griesbach
Highway Commissioner
Marathon County Highway Department
James.Griesbach@co.marathon.wi.us
(715) 261-1801

Stephanie Christensen, PE
Project Manager
EMCS, Inc. (designer)
schristensen@emcsinc.com
(715) 318-9017

Page Intentionally Left Blank

Fold here

Place
Stamp
Here

Stephanie Christensen
EMCS, Inc.
500 North 17th Avenue
Wausau, WI 54401

To mail, fold here and tape.