



MARATHON COUNTY HUMAN RESOURCES, FINANCE AND PROPERTY COMMITTEE AGENDA

Date & Time of Meeting: **Tuesday, November 19, 2024, 3:00 p.m.**
Meeting Location: **Assembly Room, Courthouse, 500 Forest Street, Wausau WI 54403**
Committee Members: John Robinson, Chair; Gayle Marshall, Vice-Chair; Kurt Gibbs, Kody Hart, Ann Lemmer, Scott Poole, Jordan Reynolds

Marathon County Mission Statement: Marathon County Government serves people by leading, coordinating, and providing county, regional, and statewide initiatives. It directly or in cooperation with other public and private partners provides services and creates opportunities that make Marathon County and the surrounding area a preferred place to live, work, visit, and do business. (Last updated: 12-20-05)

Committee Mission Statement: Provide leadership for the implementation of the County Strategic Plan, monitor outcomes, review, and recommend to the County Board policies related to human resources initiatives, finance and property of the County.

Persons wishing to attend the meeting by phone may call into the **telephone conference beginning five (5) minutes prior to the start time indicated above using the following number:**

Phone#: 1-408-418-9388 Access Code: 146 235 4571

When you enter the telephone conference, **PLEASE PUT YOUR PHONE ON MUTE!**

The meeting will also be broadcasted on Public Access or at <https://tinyurl.com/MarathonCountyBoard>

1. **Call Meeting to Order**
2. **Pledge of Allegiance**
3. **Public Comment (15 Minutes)** *(Any person who wishes to address the committee during the "Public Comment" portion of the meetings, must provide his or her name, address, and the topic he or she wishes to present to the Marathon County Clerk, or chair of the committee, no later than five minutes before the start of the meeting. All comments must be germane to a topic within the jurisdiction of the committee.)*
4. **Approve Minutes from the November 11, 2024 meeting**
5. **Policy Issues Discussion and Potential Committee Determination**
6. **Operational Functions Required by Statute, Ordinance, Resolution, or Policy**
 - A. Items for Discussion and Possible Action by HRFC
 1. Approve Keeping Tax Deed Parcel off WI Surplus Listing at Parks Dep't Request
 2. Claim Disallowance – Britney Teske
 3. Approve October Claims and Questioned Costs
 4. Approve Wisconsin Public Service Easement for Marathon Park
 5. Approve Wisconsin Public Service Easement for N. 28th Ave in the Village of Maine
 - B. Items for Discussion and Possible Action by HRFC to Forward to County Board
7. **Educational Presentations and Committee Discussion.**
 - A. Review 2025 Budget Process
 - B. Fund Balance Policy Review
 - C. 3rd Quarter Financial Updates
8. **Next Meeting Date & Time, Announcements and Future Agenda Items**
 - A. Committee members are asked to bring ideas for future discussion.
 - B. Next meeting: **Wednesday, December 5, 2024, 1:00 and 3:00 p.m. (joint meetings with INFR and EEED)**
9. **Adjournment**
**Any Person planning to attend this meeting who needs some type of special accommodation in order to participate should call the County Clerk's Office at 261.1500 or email countyclerk@marathoncounty.gov one business day before the meeting.*

SIGNED s/s John Robinson
Presiding Officer or Designee

EMAILED TO: Wausau Daily Herald, City Pages, and other Media Groups
EMAILED BY: _____
DATE & TIME: _____

NOTICE POSTED AT THE COURTHOUSE
BY: _____
DATE & TIME: _____



MARATHON COUNTY
HUMAN RESOURCES, FINANCE AND PROPERTY COMMITTEE and
PUBLIC HEARING ON THE 2025 BUDGET AGENDA with MINUTES

Date & Time of Meeting: **Monday, November 11, 2024, 8:30 a.m.**
Meeting Location: **Courthouse Assembly Room, Courthouse, 500 Forest Street, Wausau WI 54403**

John Robinson	Present
Gayle Marshall	Present
Kurt Gibbs	Present
Kody Hart	Present
Ann Lemmer	Present
Scott Poole	Present
Jordan Reynolds	Present (W)

Staff Present: Sam Fenske, Chris Holman, Jamie Polley, Gerard Klein, Lance Leonhard, Kim Trueblood, Michael Puerner, Judge O'Neill, Laura Yarie, Denise Maxon, Sheila McCarthy, Gary Olsen, Judge Moran, Judge Corbett
Others Present: Supervisors Gisselman, Seubert, Wilhelm, Jensen, DeBroux, Dickinson, Aarrestad, Ungerer, Foote, Drabek

[Meeting Recording](#)

1. **Call Meeting to Order**
2. **Pledge of Allegiance**
3. **Public Comment (15 Minutes) – None**
4. **Budget Hearing**
 - A. Overview of Published Budget by HR Finance & Property Committee Chair Robinson (2:00)
 - B. Administrator’s Budget Message - Document available [HERE](#)
 - C. Administrator’s Presentation of the Budget – Available [HERE](#) (starting at 1:17)
 - D. Overview of Changes Adopted by Committee for Publication – Amendments
 - E. Public Reading of the Proposed 2025 Budget – Clerk Trueblood (9:00)
 - F. Public Input Regarding Proposed 2025 Budget – (10:00) Judge O’Neill, Tom Krueger, Bob Peterson, David Baker, and Pat Snyder spoke regarding the 2025 budget.
 - G. Closure of Public Hearing (20:00)
5. **Approve Minutes from the October 22, 2024 meeting (21:00) – motion by Marshall, second by Poole to approve the minutes as presented. Motion carried on a voice vote unanimously.**
6. **Policy Issues Discussion and Potential Committee Determination**
7. **Operational Functions Required by Statute, Ordinance, Resolution, or Policy**
 - A. Items for Discussion and Possible Action by HRFC
 - B. Items for Discussion and Possible Action by HRFC to Forward to County Board
 1. Accepting Department of Energy Grant Funds (22:00) – motion by Gibbs, second by Lemmer to accept the grant funds. Motion carried on a voice vote unanimously.
 2. Opportunity for Discussion Regarding 2025 Annual Budget and Capital Improvement Plan and Consideration of Potential Amendments (24:00)
 - Amendment #1 – already included in the proposed budget resolution
 - Amendments #2 & 3 – done to clean up the account notations. Motion by Gibbs, second by Hart to approve the amendments and forward to the full board. Motion carried on a voice vote unanimously.
 - Amendment #4 – no motion, forwarded to the board without a recommendation
 - Amendment #5 – motion by Gibbs, second by Lemmer to not recommend to the full board. Motion carried on a voice vote but was not unanimous.
 - Amendment #6 – motion by Marshall, second by Poole to recommend to the full board. Motion carried on a voice vote unanimously.
 - Amendment #7 – motion by Gibbs, second by Lemmer to not recommend to the full board, with the caveat that there is a commitment by both HRFC and INFR to have a discussion around forming a policy to deal with reserves and look at removing the wheel tax in the future. Motion carried on a voice vote, but was not unanimous.
 - Amendment #8 – no motion, forwarded to the board without a recommendation
 3. Review of 2025 Budget Resolution (1:54)
8. **Educational Presentations and Committee Discussion.**
 - A. Revision to Chapter 4, Section 5 of the Employee Policy Manual (1:56)
 - B. Update on Tax Delinquent Properties (1:58)

9. **Next Meeting Date & Time, Announcements and Future Agenda Items**

A. Committee members are asked to bring ideas for future discussion

B. Next meeting: **Wednesday, November 19, 2024, at 3:00 p.m.** There is a need for a joint meeting with Extension, Education, and Economic Development Committee dealing with the UWSP-Wausau campus. There also needs to be a joint meeting with the Infrastructure Committee. Either meeting could be on December 5 with either committee. Chair Robinson will work with other chairs and come up with a schedule.

10. **Adjournment** – Motion by Gibbs, Second by Poole to adjourn. Motion carried on a voice vote unanimously. Meeting adjourned at 5:10 p.m.

Minutes prepared by Kim Trueblood, County Clerk

DRAFT



Kim Trueblood, Marathon County Clerk

Marathon County Courthouse
500 Forest Street
Wausau, WI 54403
715.261.1500 (Telephone)
715.261.1515 (Fax)
Kim.Trueblood@co.marathon.wi.us



MEMORANDUM

TO: Michael Puerner, Corporation Counsel

FROM: Kim Trueblood, County Clerk

DATE: September 18, 2024

RE: Claim – Britney Teske
=====

The attached notice was sent via email by AAA agent Ashley Andrews on 9/18/24.

kjt
c: Risk Management

NBL0122XVT
24003070

WISCONSIN MOTOR VEHICLE CRASH REPORT

MOUNTAIN BAY METRO PD
211 GRAND AVE
ROTHSCHILD, WI 54474
(715) 359-3879

NBL0122XVT

Document Number Override	Primary Crash Document #	Agency Crash Number 198	Investigating Officer/Deputy OFFICER BRADY PAISAR		
Crash Date 08/13/2024	Crash Time 09:01 PM	Date Arrived 08/13/2024	Time Arrived 09:10 PM		
Date Notified 08/13/2024	Time Notified 09:05 PM	Total Units 01	Total Injured 00	Total Killed 00	
<input type="checkbox"/> On Emergency	<input type="checkbox"/> Hit and Run	<input type="checkbox"/> Lane Closure	<input type="checkbox"/> Work Zone	<input type="checkbox"/> Trailer or Towed	<input type="checkbox"/> Reporting Threshold
<input type="checkbox"/> Government Property	<input type="checkbox"/> Active School Zone	School Bus Related NO		Tags	
<input checked="" type="checkbox"/> Reportable	Crash Type DT4000 (STANDARD CRASH)		<input type="checkbox"/> Amended	<input type="checkbox"/> Secondary Crash	

Description

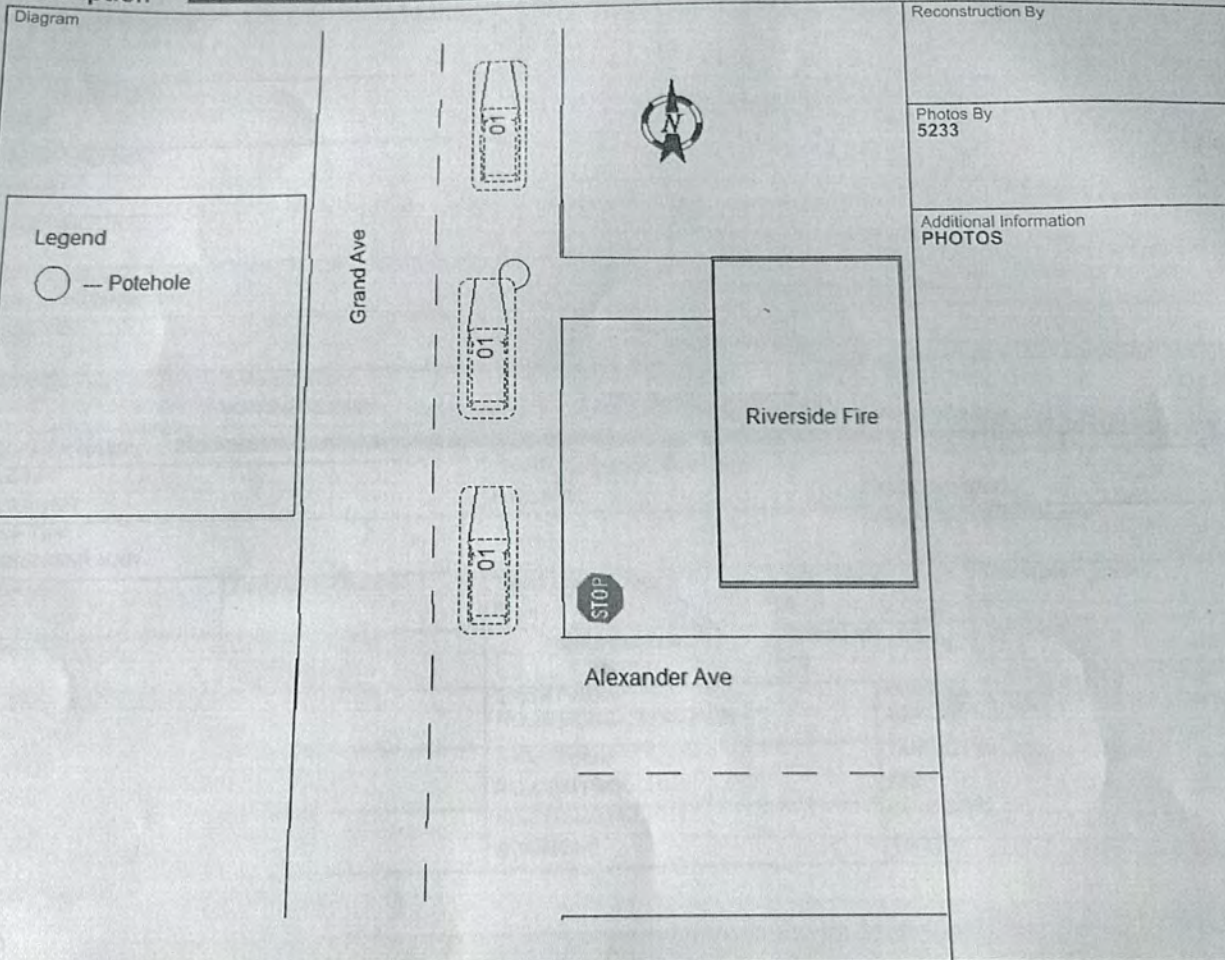

I, a sworn law enforcement officer, agree that I have not added any CJIS data in this report.

ON 08-13-24 AT 9:01 PM UNIT 1 WAS TRAVELING NORTHBOUND ON GRAND AVE NEAR ALEXANDER AVE WHEN A MANHOLE COVER CAME LOSE AND HIT THE VEHICLE ON THE PASSENGER SIDE.

NBL0122XVT
24003070

WISCONSIN MOTOR VEHICLE
CRASH REPORT

MOUNTAIN BAY METRO PD
211 GRAND AVE
ROTHSCHILD, WI 54474
(715) 359-3879

Location

ON BUSINESS STH51 NB 150 FT N OF ALEXANDER AVE (OTHER)	Latitude 44.889428155	Longitude -89.624358926
	X Coordinate 292762.5625	Y Coordinate 4974018
IN THE VILLAGE OF ROTHSCHILD IN MARATHON COUNTY	Structure Type OTHER	

Crash Scene

First Harmful Event OTHER OBJECT - NOT FIXED	First Harmful Event Location ON ROADWAY	
Manner of Collision 00 - NO COLLISION W/VEHICLE IN TRANSPORT	Light Condition DUSK	
Road Surface Condition(s) DRY	Roadway Factor(s) RUT, HOLES, BUMPS	
Environment Factor(s) NONE		
Weather Condition(s) CLEAR	Relation To Trafficway TRAFFICWAY - ON ROAD	
Animal Type	Crash Classification - Jurisdiction NO SPECIAL JURISDICTION	
Crash Classification - Location PUBLIC PROPERTY	Access Control NO CONTROL	Special Study
Tribal Land		
Within Interchange Area NO	Junction Location NON-JUNCTION	Intersection Type NOT AN INTERSECTION

Unit Summary

UNIT 01	Unit Status IN TRANSIT	Vehicle Operating As Classification D CLASS	Unit Type AUTOMOBILE		
	Vehicle Type PASSENGER VAN	Operating As Endorsements			
	Total Occs 1	Train/Bus # Recorded	Total # Citations Issued 0	Total Trailers 0	Total HazMat Types 0
	Insurance? YES	Direction Of Travel NORTHBOUND	<input type="checkbox"/> Pre Crash Tire Mark	Speed Limit 35	Total Lanes 4
	Most Harmful Event: Collision With OTHER OBJECT - NOT FIXED	Special Function NO SPECIAL FUNCTION	Emergency Motor Vehicle Use NOT APPLICABLE		
	Traffic Way TWO-WAY, NOT DIVIDED	Traffic Control NO CONTROL	Traffic Control Inoperative/Missing NO		
	Surface Type BLACKTOP (BITUMINOUS)	Road Curvature STRAIGHT	Road Grade LEVEL		
	Truck Bus or HazMat NO				

Vehicle

UNIT 01 VEHICLE 01	License Plate Number 755MTC	Plate Type AUT	St WI	Country of Issuance UNITED STATES
	Vehicle Identification Number 5TDYK3DC8DS391579	Make TOYT	Year 2013	Model SIENNA
	Color WHI - WHITE	Body Style VN - VAN	Bus Use	
	Initial Contact Point 02 - RIGHT SIDE FRONT	Vehicle Damage 02 - RIGHT SIDE FRONT, 03 - RIGHT SIDE MIDDLE, 04 - RIGHT SIDE REAR		
Extent Of Damage FUNCTIONAL DAMAGE				

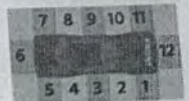

NBL0122XVT
24003070

WISCONSIN MOTOR VEHICLE CRASH REPORT

MOUNTAIN BAY METRO PD
211 GRAND AVE
ROTHSCHILD, WI 54474
(715) 359-3879

UNIT VEHICLE 01 01	Towed Due To Damage TOWED BUT NOT DUE TO DISABLING DAMAG	Vehicle Removed By OPERATOR
	What Driver Was Doing GOING STRAIGHT	Vehicle Factors NOT APPLICABLE
	Driver Prior Action Other	
	Driver Actions 123	
Owner Name BRITNEY R TESKE (715) 574-1801	Owner Address 151891 WISTERIA LN WAUSAU, WI 54401 , US	

UNIT 01 01 02 03 04	Sequence Of Events	
	Event OTHER OBJECT - NOT FIXED	
	Event	
	Event	

UNIT 01	Policy Holder	
	Insurance Company AMERICAN-AUTOMOBILE-INS-CO	INDIVIDUAL BRITNEY TESKE

UNIT INDIVIDUAL 01	Individual		
	DRIVER BRITNEY R TESKE (715) 574-1801	Citations Issued 0	Sex FEMALE
	Address 151891 WISTERIA LN WAUSAU, WI 54401 , US	Date of Birth 02/05/1992	Race WHITE
		Driver License Number T2000769254501	STATE: WISCONSIN COUNTRY: UNITED STATES

UNIT 01	Safety Equipment	
	On Duty Crash	Safety Equipment SHOULDER & LAP BELT
	Row 01 - FRONT ROW	Seat Position 07 - LEFT
	Helmet Use	Helmet Compliance
Eye Protection	Tint Compliance	

UNIT 001	Injury		
	Injury Severity NO APPARENT INJURY	Airbag NON DEPLOYED	
	Ejected NOT EJECTED	Ejection Path NOT EJECTED/NOT APPLICABLE	Trapped/Extricated NOT TRAPPED
	Medical Transport NOT TRANSPORTED	EMS Agency Identifier	EMS Run #
Hospital	Date of Death	Time of Death	

UNIT 001	Distracted By	
	Distracted By Source NOT APPLICABLE (NOT DISTRACTED)	
Distracted By Action NOT DISTRACTED		

NBL0122XVT
24003070

WISCONSIN MOTOR VEHICLE CRASH REPORT

MOUNTAIN BAY METRO PD
211 GRAND AVE
ROTHSCHILD, WI 54474
(715) 359-3879

UNIT INDIVIDUAL 01 001	Non Motorist		Striking Unit #	Location
	Prior Action			
	Action			
	Action Other			To/From School
	Drug & Alcohol		Suspected Alcohol Use NO	Suspected Drug Use NO
	Alcohol Test Given TEST NOT GIVEN		Alcohol Test Type	Alcohol Test Results
	Drug Test Given TEST NOT GIVEN		Drug Test Type	Drug Test Results
	Drug Type			
	Individual Condition APPEARED NORMAL			



Jaime Alberti-Bowers
500 Forest Street
Wausau, Wisconsin 54403

November 8, 2024

RE: Claimant: AAA Group
 Claim Number: GLMA00003667
 Our Insured: Marathon County
 Date of Loss: 8/13/2024

Dear Jaime Alberti-Bowers,

The above referenced claim was filed on November 1, 2024. After a thorough examination of the information, it has been determined that Marathon County has no liability for this claim. Please issue a formal disallowance and provide a copy of this disallowance to WMMIC.

This claim will be closed on the date of receipt of the disallowance.

A copy of this letter has been placed in the claim file for reference. If you should have any further questions, please contact me.

Sincerely,

A handwritten signature in black ink, appearing to read "Pa Vang", is positioned above the typed name and title.

Pa Vang
Liability Claim Representative
Wisconsin Municipal Mutual Insurance Company
(608) 729-5682
pvang@wmmic.com

From: [Bandy, Kyisha](#)
To: [Kelly Schremp](#); [Jaime Alberti](#)
Cc: [Kim Trueblood](#)
Subject: [EXTERNAL] INCIDENT ON ALEXANDER WITH OUR INSURED BRITNEY TESKE OUR CLAIM NUMBER 401953561
Date: Friday, November 1, 2024 1:34:34 PM
Attachments: [image001.png](#)
[FH PHOTOS.pdf](#)
[01953561 DEMAND FOR MARATHON COUNTY.pdf](#)
[ADJUSTER NOTES WITH MARATHON COUNTY.pdf](#)
[POLICE REPORT.pdf](#)
[CAR SEAT INVOICE.pdf](#)
Importance: High

Some people who received this message don't often get email from kqbandy@acg.aaa.com. [Learn why this is important](#)

Hello, Good Day!

I am Kyisha Bandy a subrogation adjuster with AAA Auto Club Member Select insurance.

I am reaching out in hopes of help and the proper avenue to pursue in relation to our subrogation recovery claim for the damages of our insured Britney Teske's Toyota Sienna.

This claim was sent to our subrogation department. Our property damage adjuster Ashley Andrews has been seeking help since about September 2024.

The property adjuster first spoke with someone of the city of Rothschild explaining that our insured Britney Teske was traveling along *Alexander rd.* when a manhole cover came loose and caused damage to our insured's vehicle when it hit our insured's vehicle.

After speaking with someone of Rothschild's city, she (our property adjuster) was advised and referred to Marathon County as the representative of Rothschild, Ryan Vandewalle RVANDEWALLE@ROTHSCHILDWI.COM, stated this road is not owed by the city. (I do have notes if needed, of the communication with Ryan Vandewalle).

So, the property adjuster first reached out to the representative of Marathon County, Kim who referred adjuster to Jaime, who explained this may need to be filed or handled with the City Clerk office in order to get their insurance involved (note is attached). Upon reaching out to the City Clerk office being referred to Kelly, our property adjuster seems to have been told this is not a matter that may not be handled with them.

I have attached our demand for the damages/repairs of our insured's vehicle.

If you could please review or if there is a department that we need to be touch with who has the insurance information we need to seek recovery from or the department that may handle this type of situation (when an individual's property is damage by city/gov/county property) would be very helpful and greatly appreciated.

Again, if needed I do have the notes of our property adjuster the communication with the representatives of the city and county if needed.

Thank you for your time and helping me.

It's Going To Be A Good Year!

Thank You, Have a Great Day!

Kyisha Bandy

Recovery Unit/Subrogation

Claim Representative II

kqbandy@acg.aaa.com

PH: 313-436-7152



The information transmitted is intended only for the person(s) or entity to which it is addressed and may contain confidential and or privileged material and should be treated as a confidential The Auto Club Group communication. If the reader of this message is not the intended recipient, you are hereby notified that your access is unauthorized, and any review, dissemination, distribution, or copying of this message including any attachments is strictly prohibited.



The Auto Club Group
Claim Department
PO Box 8001
Royal Oak, MI 48068-9826

11/1/2024

MARATHON COUNTY
1430 WEST ST
WAUSAU, WI 54401

OUR CLAIM NUMBER: 401953561
OUR INSURED: BRITNEY TESKE
DATE OF LOSS: 8/13/2024
YOUR CLIENT: MARATHON COUNTY ROAD IN ROTHSCHILD CITY
DEMAND TOTAL: \$9,817.76

Dear MARATHON COUNTY OR WHOM IT MAY CONCERN:

We have been informed that you are the liability insurance carrier for the above referenced claimant. Our investigation of the accident indicates that the driver/owner of your insured vehicle is liable for this loss.

Attached please find our documents to support the demand amount listed above.

Please issue your reimbursement check, referencing the above captioned claim number, to:

Auto Club Insurance Association
ATTN: Subrogation Recovery Unit
PO Box 631883
Cincinnati, OH 45263-1883

Should you have any questions or additional information is needed, please do not hesitate to contact me.

Sincerely,

SUBROGATION/RECOVERY UNIT

Kyisha Bandy

Kyisha Bandy

CLAIM REPRESENTATIVE II

313-436-7152

kqbandy@acg.aaa.com

PAYMENT LOG

Claim Number: 401953561
Date of Loss: 08/13/2024
Posting Date From: 00/00/0000
Prepared by: Kyisha Bandy

Posting Date To: 00/00/0000
Print Date: 11/01/2024



Claimant: BRITNEY TESKE
Coverage: Collision
Subclaim #: 001

Pmt #	Posting Date	Check Number	Payee(s)	Remitter	Benefit Type	Loss/Expense	Payment Amount	Payment Status	Payment Category	Service Start Date	Service End Date	EOB	Invoice No.
4	09/25/2024	2723003	TRACEY'S AUTOMOTIVE LLC		Supplemental Repairs	Loss	\$ 958.97	Check Cashed	Disbursement				
3	09/18/2024	2719346	TRACEY'S AUTOMOTIVE LLC		Repair Costs	Loss	\$ 6815.86	Check Cashed	Disbursement				
3	09/18/2024	2719346	TRACEY'S AUTOMOTIVE LLC		Collision Indemnity	Loss	\$ 500.00	Check Cashed	Disbursement				
2	08/28/2024	2000718466	SEDGWICK CLAIMS MANAGEMENT SERVICES INC		Independent Adjuster Fee -- Claim	Expense	\$ 130.00	Check Issued	Disbursement				1720081
1	08/27/2024	2000716690	COORDINATED CLAIM SERVICES LLC		Supplementary Payments - Child Restraint	Loss	\$ 543.01	Check Issued	Disbursement				

PAYMENT LOG

Claim Number: 401953561
Date of Loss: 08/13/2024
Posting Date From: 00/00/0000
Prepared by: Kyisha Bandy

Posting Date To: 00/00/0000
Print Date: 11/01/2024



Claimant: BRITNEY TESKE
Coverage: Car Rental
Subclaim #: 002

Pmt #	Posting Date	Check Number	Payee(s)	Remitter	Benefit Type	Loss/Expense	Payment Amount	Payment Status	Payment Category	Service Start Date	Service End Date	EOB	Invoice No.
1	09/17/2024	2000731108	ENTERPRISE RENT A CAR		Car Rental	Loss	1499.92	Check Issued	Disbursement	08/15/2024	09/13/2024		4465D5DGZ8
							\$						0



Rental Company: ENTERPRISE RENT-A-CAR
 Invoice: D5DGZ80-4465
 Alternate Invoice Number: 5DGZ80

Bill To: AA120G9
 AAA AUTO CLUB GRP (AAA MI)
 ATTN: ASHLEY ANDREWS
 1 Auto Club Drive
 Dearborn, MI 48126

RENTER INFORMATION:
 Renter: TESKE, BRITNEY

RENTAL INFORMATION:
Rental Branch Location:
 ENTERPRISE RENT-A-CAR (4465)
 2210 SHERMAN ST
 WAUSAU, WI 544011701
 (715) 848-8799

ADDITIONAL CLAIM INFORMATION:
 Claim Number :401953561
 Claim Type: Insured
 Vehicle Condition: Non-Driveable
 Date Of Loss: 8/13/24
 Insured Name: BRITNEY TESKE
 Owner's Vehicle: 2013 OTHER|TOYOTA
 OTHER|SIENNA
 Additional Driver:

Repair Facility:
 TRACEY'S AUTOMOTIVE
 XX
 (715) 845-9325

RENTAL DETAIL:

Rental Period: 8/15/24 to 9/16/24 (33 days)
 Billed Period: 8/15/24 to 9/13/24 (30 days)

	Quantity	Rate	Amount
<i>Products and Services</i>			
TIME & DISTANCE	2	46.40	\$92.80
TIME & DISTANCE	24	46.40	\$1,113.60
TIME & DISTANCE	7	57.49	\$402.43
<i>Taxes and Surcharges</i>			
TITLE AND REGISTRATION FEES	7	0.99	\$6.93
TITLE AND REGISTRATION FEES	26	0.99	\$25.74
SALES TAX	1	5.50%	\$90.28
Total Charges:			\$1,731.78
Less Amount Received:			\$231.86
Total Amount Due:			\$1,499.92

VEHICLES RENTED:

Effective Date and Time	Year	Make	Model	VIN	Starting Mileage	Ending Mileage	Mileage	Rate Charged
8/15/24 9:25 AM	2023	CHRY	PACI	2C4RC1BG9PR563868	34117	34468	351	\$57.49
8/22/24 12:00 AM	2022	KIA	SORE	5XYRGDLC2NG085781	52445	52757	312	\$46.40
8/24/24 12:00 AM	2023	CHRY	PACI	2C4RC1BG0PR624248	45130	46389	1259	\$46.40

Rental Invoice

Please Return This Portion with Remittance

Make Payment To:
ENTERPRISE RENT-A-CAR
 P.O. BOX 840086
 KANSAS CITY, MO 64184-0086
 Federal ID: 43-0724835

Total Charges: \$1,731.78
Less Amount Received: \$231.86
Total Amount Due..... **\$1,499.92**

Please include on your check:
 Invoice: D5DGZ80-4465



Toyota 2013 Sienna 4X2 GSL30L-PFTQKA ExpressAlign Total Alignment

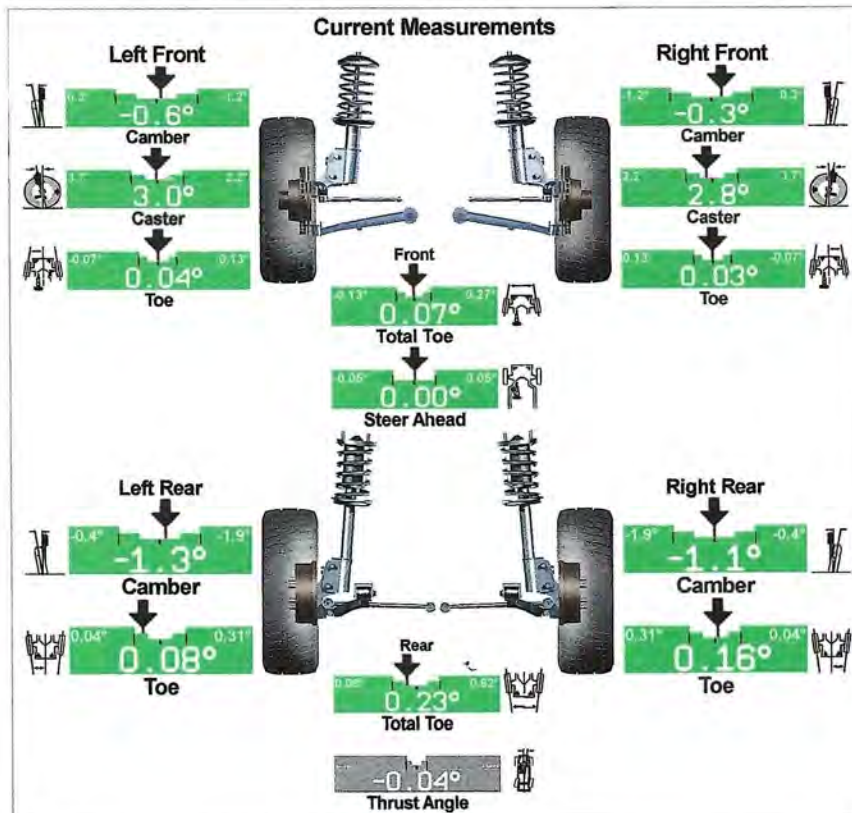
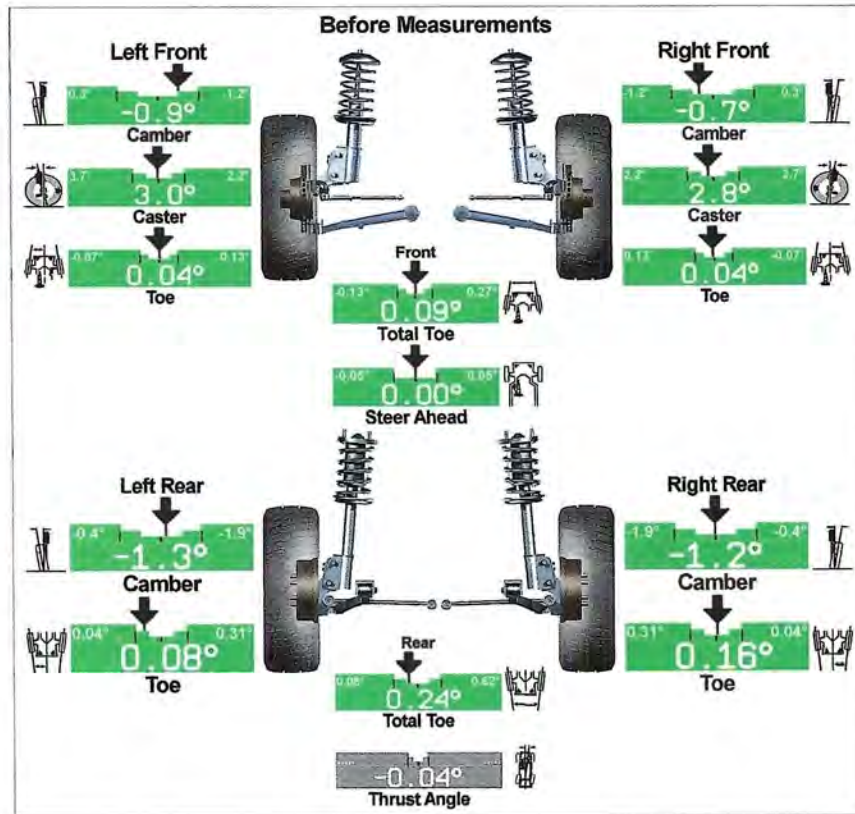

Adjusted camber, set front toe

Sedgwick Appraisals

SUBMIT ALL SUPPLEMENTS
<https://app.vistaclaim.com/supplements>
 2521 Technology Dr, Suite 201
 Elgin, IL 60124
 Phone: (888) 863-0001, FAX:(847) 594-0244
 autosupps@sedgwick.com

Supplement of Record 1 with Summary

Owner: TESKE, BRITNEY

Job Number:

Written By: Hailey Armas

Insured: TESKE, BRITNEY	Policy #:	Claim #: 401953561ZCOL001-01
Type of Loss: Collision	Date of Loss: 8/13/2024 10:00 AM	Days to Repair: 0
Point of Impact: 12 Front		

Owner: TESKE, BRITNEY 151891 WISTERIA LN Wausau, WI 54401 (715) 574-1801 Business	Inspection Location: Tracey's Automotive 802 S 9th Ave Wausau, WI 54401 Other (715) 845-9325 Evening	Repair Facility: Tracey's Automotive 802 S 9th Ave Wausau, WI 54401 (715) 845-9325 Business
------------------------------------------------------------------------------------------------------	----------------------------------------------------------------------------------------------------------------------------	----------------------------------------------------------------------------------------------------------------

VEHICLE

2013 TOYO Sienna Limited FWD w/7-Passenger Seating 4D VAN 6-3.5L Gasoline Electronic Fuel Injection WHITE

VIN: 5TDYK3DC8DS391579	Production Date:	Interior Color:
License: 755MTC	Odometer: 139,279	Exterior Color: WHITE
State: WI	Condition:	

TRANSMISSION

Automatic Transmission

POWER

Power Steering
 Power Brakes
 Power Windows
 Power Locks
 Power Mirrors
 Heated Mirrors
 Power Driver Seat
 Power Passenger Seat
 Memory Package

DECOR

Dual Mirrors
 Privacy Glass
 Console/Storage

Tilt Wheel
 Cruise Control
 Rear Defogger
 Keyless Entry
 Alarm
 Message Center
 Steering Wheel Touch Controls
 Rear Window Wiper
 Telescopic Wheel
 Climate Control
 Dual Air Condition
 Backup Camera
 Parking Sensors
 Dual Power Sliding Doors
 Home Link

RADIO

Auxiliary Audio Connection
 Premium Radio
 Satellite Radio
 CD Changer/Stacker
SAFETY
 Drivers Side Air Bag
 Passenger Air Bag
 Anti-Lock Brakes (4)
 4 Wheel Disc Brakes
 Traction Control
 Stability Control
 Front Side Impact Air Bags
 Head/Curtain Air Bags
 Communications System
 Hands Free Device
 Blind Spot Detection

Heated Seats
 Ventilated Seats
 3rd Row Seat
 Retractable Seats
 Captain Chairs (4)
WHEELS
 Aluminum/Alloy Wheels
PAINT
 Three Stage Paint
OTHER
 Fog Lamps
 Rear Spoiler
 Signal Integrated Mirrors
 California Emissions
TRUCK
 Trailer Hitch

Supplement of Record 1 with Summary

Owner: TESKE, BRITNEY

Job Number:

2013 TOYO Sienna Limited FWD w/7-Passenger Seating 4D VAN 6-3.5L Gasoline Electronic Fuel Injection WHITE

Overhead Console

AM Radio

ROOF

Trailer Package

Wood Interior Trim

FM Radio

Luggage/Roof Rack

Power Trunk/Liftgate

CONVENIENCE

Stereo

Dual Power Sunroofs

Air Conditioning

Search/Seek

SEATS

Intermittent Wipers

CD Player

Leather Seats

Supplement of Record 1 with Summary

Owner: TESKE, BRITNEY

Job Number:

2013 TOYO Sienna Limited FWD w/7-Passenger Seating 4D VAN 6-3.5L Gasoline Electronic Fuel Injection WHITE

Line	Oper	Description	Part Number	Qty	Extended Price \$	Labor	Paint
1		FRONT BUMPER					
2		R&I R&I bumper cover				1.6	
3	* <>	Rpr Bumper cover w/ft prk aid				<u>1.5</u>	3.0
4		Add for Three Stage					2.1
5	* S01	Repl RT Park sensor pearl white	8934148010A4	1	262.32	<u>2.0</u> M	0.2
6		Add for Three Stage					0.1
7		Repl RT Park sensor retainer pearl white	8934833060A2	1	6.44		
8	**	Repl A/M CAPA RT Pad	5385108010	1	37.00	0.1	
9		FRONT LAMPS					
10		R&I RT Headlamp assy w/o SE				0.3	
11	S01	Repl RT Fog lamp assy	8121008020	1	216.47	0.2	
12	S01	Aim fog lamps				0.4	
13		RADIATOR SUPPORT					
14	**	Repl A/M CAPA Splash shield type 1 w/o SE	5144108030	1	195.00	0.3	
15		FENDER					
16	**	Repl A/M CAPA RT Fender liner w/o SE	5380508010	1	99.00	0.4	
17	*	Blnd RT Fender w/o antenna (HSS)					<u>1.0</u>
18		ROOF					
19		R&I RT Side rail				0.4	
20		R&I RT Drip molding				0.5	
21	*	R&I Headliner clip tan Note: access for luggage rack				<u>2.0</u>	
22		PILLARS, ROCKER & FLOOR					
23		R&I RT Rocker molding w/o SE				0.8	
24	#	Blnd Roof Rail					1.5
25		FRONT DOOR					
26	#	Rpr Rt Inner door frt				3.0	
27		R&I RT Surround w'strip gray				Incl.	
28		Repl RT Outer panel	6711108020	1	477.50	7.0	2.1
29		Overlap Major Non-Adj. Panel					-0.2
30		Add for Three Stage					0.8
31		Add for Edging					0.5
32		Add for Inside					0.5
33		R&I RT Corner trim					
34	*	R&I RT Belt molding				<u>Incl.</u>	
35		R&I RT Mirror assy w/heated, w/memory beige				Incl.	
36		R&I RT Door glass Toyota				0.6	
37		R&I RT Handle, outside black molded				Incl.	
38		R&I RT R&I trim panel				Incl.	
39		R&I RT R&I door assy				Incl.	

Supplement of Record 1 with Summary

Owner: TESKE, BRITNEY

Job Number:

2013 TOYO Sienna Limited FWD w/7-Passenger Seating 4D VAN 6-3.5L Gasoline Electronic Fuel Injection WHITE

40	SIDE LOADING DOOR						
41	*	Rpr	RT Outer panel			<u>7.0</u>	2.2
42			Overlap Major Non-Adj. Panel				-0.2
43			Add for Three Stage				0.8
44	#	Rpr	Rt Rear door inner shell			2.0	0.5
45	*	R&I	RT Belt molding			<u>0.3</u>	
46		R&I	RT Handle, outside w/o painted flat black			0.3	
47		R&I	RT R&I trim panel			0.4	
48		R&I	RT R&I door assy			1.5	
49	SIDE PANEL						
50	*	Rpr	RT Side panel w/blind spot			<u>1.5</u>	2.6
51			Overlap Major Adj. Panel				-0.4
52			Add for Three Stage				0.9
53		R&I	RT Wheelhouse liner			0.3	
54		R&I	RT Side glass Toyota, w/o power, w/o sunshade w/o privacy			0.5	
55		R&I	RT Qtr trim panel XLE, Limited w/o rear DVD, w/o JBL gray			0.8	
56	#	Repl	Glass Kit	1	25.00		
57	REAR LAMPS						
58		R&I	RT Tail lamp assy w/o SE			0.2	
59	REAR BUMPER						
60		R&I	R&I bumper cover			0.8	
61	* <>	Rpr	Bumper cover w/park sensors			<u>2.5</u>	3.0
62			Overlap Major Non-Adj. Panel				-0.2
63			Add for Three Stage				1.1
64	*	R&I	Park sensor retainer inner pearl white			<u>0.2</u>	
65	#	Subl	Four wheel alignment	1	129.00	X	
66	#	Subl	Hazardous waste removal	1	3.00	T	
67	#	Repl	Cover Car	1	5.00	T	
68	#	Repl	Corrosion protection primer	1	10.00	T	
69	#	Repl	Flex additive	1	7.00	T	
70	#	S01	Tow bill +25%	1	182.50		
71	#	S01	Inspect vehicle for damage	1			1.0 M
72	#	S01	Passenger Side Siding Door not opening	1	100.00		
Note: Get door open and working temporarily until body shop can repair							
SUBTOTALS					1,755.23	40.4	21.9

Supplement of Record 1 with Summary

Owner: TESKE, BRITNEY

Job Number:

2013 TOYO Sienna Limited FWD w/7-Passenger Seating 4D VAN 6-3.5L Gasoline Electronic Fuel Injection WHITE

ESTIMATE TOTALS

Category	Basis	Rate	Cost \$
Parts			1,601.23
Body Labor	37.4 hrs @	\$ 70.00 /hr	2,618.00
Paint Labor	21.9 hrs @	\$ 70.00 /hr	1,533.00
Mechanical Labor	3.0 hrs @	\$ 125.00 /hr	375.00
Paint Supplies	21.9 hrs @	\$ 50.00 /hr	1,095.00
Miscellaneous			154.00
Subtotal			7,376.23
Sales Tax	\$ 7,247.23 @	5.5000 %	398.60
Total Cost of Repairs			7,774.83
Deductible			500.00
Total Adjustments			500.00
Net Cost of Repairs			7,274.83

Supplement of Record 1 with Summary

Owner: TESKE, BRITNEY

Job Number:

2013 TOYO Sienna Limited FWD w/7-Passenger Seating 4D VAN 6-3.5L Gasoline Electronic Fuel Injection WHITE

SUPPLEMENT SUMMARY

Line	Oper	Description	Part Number	Qty	Extended Price \$	Labor	Paint
Changed Items							
5		Repl RT Park sensor pearl white	8934148010A4	1	-262.32	-0.1	-0.2
5	*	S01 Repl RT Park sensor pearl white	8934148010A4	1	262.32	2.0 M	0.2
Added Items							
11	S01	Repl RT Fog lamp assy	8121008020	1	216.47	0.2	
12	S01	Aim fog lamps				0.4	
70	#	S01 Tow bill +25%		1	182.50		
71	#	S01 Inspect vehicle for damage		1		1.0 M	
72	#	S01 Passenger Side Siding Door not opening		1	100.00		
NOTE: Get door open and working temporarily until body shop can repair							
SUBTOTALS					498.97	3.5	0.0

CHANGES TO ADJUSTMENTS

TOTALS SUMMARY

Category	Basis	Rate	Cost \$
Parts			498.97
Body Labor	0.5 hrs @	\$ 70.00 /hr	35.00
Mechanical Labor	3.0 hrs @	\$ 125.00 /hr	375.00
Subtotal			908.97
Sales Tax	\$ 908.97 @	5.5000 %	49.99
Additional Supplement Taxes			0.01
Total Supplement Amount			958.97
NET COST OF SUPPLEMENT			958.97

Supplement of Record 1 with Summary

Owner: TESKE, BRITNEY

Job Number:

2013 TOYO Sienna Limited FWD w/7-Passenger Seating 4D VAN 6-3.5L Gasoline Electronic Fuel Injection WHITE

CUMULATIVE EFFECTS OF SUPPLEMENT(S)

Estimate	6,815.86	Karl Basinski
Supplement S01	958.97	Hailey Armas
Workfile Total:	\$ 7,774.83	
TOTAL ADJUSTMENTS:	\$ 500.00	
NET COST OF REPAIRS:	\$ 7,274.83	

Disclaimer:

*** THIS ESTIMATE/SUPPLEMENT IS SUBJECT TO AUDIT AND REVISION BY THE INSURANCE COMPANY ***

*** THIS IS NOT AN AUTHORIZATION TO REPAIR. ALL REPAIR COSTS ARE THE RESPONSIBILITY OF THE VEHICLE OWNER, WHO ULTIMATELY MUST AUTHORIZE ALL REPAIRS. NO ESTIMATES OR SUPPLEMENTS WILL BE HONORED WITHOUT PRIOR INSPECTION AND AUTHORIZATION. ***

*** COPY OF THIS APPRAISAL/SUPPLEMENT ONLY IS NOT AN ACCEPTANCE OF COVERAGE OR LIABILITY. ALL ISSUES OF COVERAGE OR LIABILITY ARE TO BE DETERMINED BY THE INSURANCE COMPANY. ***

Fraud Disclaimer:

ANY PERSON WHO KNOWINGLY PRESENTS A FALSE OR FRAUDULENT CLAIM FOR THE PAYMENT OF A LOSS IS GUILTY OF A CRIME AND MAY BE SUBJECT TO FINES AND CONFINEMENT.

Alternative Parts Disclaimer:

THIS ESTIMATE MAY HAVE BEEN PREPARED BASED ON THE USE OF AUTOMOBILE PARTS NOT MADE BY THE ORIGINAL MANUFACTURER. PARTS USED IN THE REPAIR OF YOUR VEHICLE BY OTHER THAN THE ORIGINAL MANUFACTURER ARE REQUIRED TO BE AT LEAST EQUAL IN LIKE KIND AND QUALITY IN TERMS OF FIT, QUALITY AND PERFORMANCE TO THE ORIGINAL MANUFACTURER PARTS THEY ARE REPLACING. SUCH PARTS CAN BE IDENTIFIED BY THE LETTER "A" ON THIS ESTIMATE. IF THE USE OF AN AFTERMARKET PART VOIDS THE EXISTING WARRANTY ON THE PART BEING REPLACED OR ON ANY OTHER PART, THE AFTERMARKET PART SHALL HAVE A WARRANTY EQUAL TO OR BETTER THAN THE REMAINDER OF THE EXISTING WARRANTY. THE AFTERMARKET PARTS ARE WARRANTED BY THE MANUFACTURER OR DISTRIBUTOR OF THE PART AND NOT THE MANUFACTURER OF THE VEHICLE.

MOTOR VEHICLE REPAIR PRACTICES ARE REGULATED BY CHAPTER ATCP 132, WIS. ADM. CODE, ADMINISTERED BY THE BUREAU OF CONSUMER PROTECTION, WISCONSIN DEPT. OF AGRICULTURE, TRADE AND CONSUMER PROTECTION, P.O. BOX 8911, MADISON, WISCONSIN 53708-8911.

THIS ESTIMATE HAS BEEN PREPARED BASED ON THE USE OF ONE OR MORE REPLACEMENT PARTS SUPPLIED BY A SOURCE OTHER THAN THE MANUFACTURER OF YOUR MOTOR VEHICLE. WARRANTIES APPLICABLE TO THESE REPLACEMENT PARTS ARE PROVIDED BY THE MANUFACTURER OR DISTRIBUTOR OF THE REPLACEMENT PARTS RATHER THAN BY THE MANUFACTURER OF YOUR MOTOR VEHICLE.

Supplement of Record 1 with Summary

Owner: TESKE, BRITNEY

Job Number:

2013 TOYO Sienna Limited FWD w/7-Passenger Seating 4D VAN 6-3.5L Gasoline Electronic Fuel Injection WHITE

Estimate based on MOTOR CRASH ESTIMATING GUIDE and potentially other third party sources of data. Unless otherwise noted, (a) all items are derived from the Guide ARM8531, CCC Data Date 09/17/2024, and potentially other third party sources of data; and (b) the parts presented are OEM-parts. OEM parts are manufactured by or for the vehicle's Original Equipment Manufacturer (OEM) according to OEM's specifications for U.S. distribution. OEM parts are available at OE/Vehicle dealerships or the specified supplier. OPT OEM (Optional OEM) or ALT OEM (Alternative OEM) parts are OEM parts that may be provided by or through alternate sources other than the OEM vehicle dealerships with discounted pricing. Asterisk (*) or Double Asterisk (**) indicates that the parts and/or labor data provided by third party sources of data may have been modified or may have come from an alternate data source. Tilde sign (~) items indicate MOTOR Not-Included Labor operations. The symbol (<>) indicates the refinish operation WILL NOT be performed as a separate procedure from the other panels in the estimate. Non-Original Equipment Manufacturer aftermarket parts are described as Non OEM, A/M or NAGS. Used parts are described as LKQ, RCY, or USED. Reconditioned parts are described as Recond. Recored parts are described as Recore. NAGS Part Numbers and Benchmark Prices are provided by National Auto Glass Specifications. Labor operation times listed on the line with the NAGS information are MOTOR suggested labor operation times. NAGS labor operation times are not included. Pound sign (#) items indicate manual entries.

Some 2024 vehicles contain minor changes from the previous year. For those vehicles, prior to receiving updated data from the vehicle manufacturer, labor and parts data from the previous year may be used. The CCC ONE estimator has a list of applicable vehicles. Parts numbers and prices should be confirmed with the local dealership.

The following is a list of additional abbreviations or symbols that may be used to describe work to be done or parts to be repaired or replaced:

SYMBOLS FOLLOWING PART PRICE:

m=MOTOR Mechanical component. s=MOTOR Structural component. T=Miscellaneous Taxed charge category. X=Miscellaneous Non-Taxed charge category.

SYMBOLS FOLLOWING LABOR:

D=Diagnostic labor category. E=Electrical labor category. F=Frame labor category. G=Glass labor category. M=Mechanical labor category. S=Structural labor category. (numbers) 1 through 4=User Defined Labor Categories.

OTHER SYMBOLS AND ABBREVIATIONS:

Adj.=Adjacent. Algn.=Align. ALU=Aluminum. A/M=Aftermarket part. Blnd=Blend. BOR=Boron steel. CAPA=Certified Automotive Parts Association. CFC=Carbon Fiber. D&R=Disconnect and Reconnect. HSS=High Strength Steel. HYD=Hydroformed Steel. Incl.=Included. LKQ=Like Kind and Quality. LT=Left. MAG=Magnesium. Non-Adj.=Non Adjacent. NSF=NSF International Certified Part. O/H=Overhaul. Qty=Quantity. Refn=Refinish. Repl=Replace. R&I=Remove and Install. R&R=Remove and Replace. Rpr=Repair. RT=Right. SAS=Sandwiched Steel. Sect=Section. STS=Stainless Steel. Subl=Sublet. UHS=Ultra High Strength Steel. N=Note(s) associated with the estimate line.

CCC ONE Estimating - A product of CCC Intelligent Services Inc.

The following is a list of abbreviations that may be used in CCC ONE Estimating that are not part of the MOTOR CRASH ESTIMATING GUIDE:

BAR=Bureau of Automotive Repair. EPA=Environmental Protection Agency. NHTSA= National Highway Transportation and Safety Administration. PDR=Paintless Dent Repair. VIN=Vehicle Identification Number.

Supplement of Record 1 with Summary

Owner: TESKE, BRITNEY

Job Number:

2013 TOYO Sienna Limited FWD w/7-Passenger Seating 4D VAN 6-3.5L Gasoline Electronic Fuel Injection WHITE

PARTS SUPPLIER LIST

Line	Supplier	Description	Price
8	Keystone-Complete-A-Appleton 5085 WREN DRIVE APPLETON WI 54913 (800) 422-1995 (920) 731-3030	#TO1291116C A/M CAPA RT Pad	\$ 37.00
14	Keystone-Complete-A-Appleton 5085 WREN DRIVE APPLETON WI 54913 (800) 422-1995 (920) 731-3030	#TO1228174C A/M CAPA Splash shield type 1 w/o SE	\$ 195.00
16	Keystone-Complete-A-Appleton 5085 WREN DRIVE APPLETON WI 54913 (800) 422-1995 (920) 731-3030	#TO1249163C A/M CAPA RT Fender liner w/o SE	\$ 99.00

Tracey's Automotive LLC

802 South 9th Avenue
 Wausau, WI. 54401
 Phone: 715-845-9325 Fax: 715-845-3815
 Here To Serve You For The NEXT 25 Years!

INVOICE

41972

Org. Est. # 081489

INVOICE

Printed Date: 09/13/2024 Work Completed: 09/13/2024

Teske, Britney
 225497 Swan Avenue
 Wausau, WI 54401
 Cellular 715-574-1801

2013 Toyota - Sienna Limited - 3.5L, V6 (211CI) VIN(K)
 Lic # : 755-MTC Odometer In : 139279
 VIN # : 5TDYK3DC8 DS391579

Part Description / Number	Qty	Sale	Ext	Labor Description	Ext
Park Assist Sensor - Right Front, Pearl White 89341-48010-A4	1.00	262.20	262.20	INSPECT VEHICLE FOR DAMAGE Steering wheel is crooked to the left, vehicle will need an alignment, checked front steering and suspension components, no loose parts found, checked and verified all fluid levels are full and no visible leaks, passenger side fog light popped out, lower shield is loose and hanging, remove and zip tie, right front park assist sensor popped out, temporarily secured with zip ties, rear bumper cover is torn, popped together as temporary fix	125.00
Park Assist Sensor Retainer - Right Front, Pearl White 89348-33060-A2	1.00	6.44	6.44	REMOVE & REPLACE RIGHT FRONT PARK ASSIST SENSOR & RETAINER, RIGHT FRONT LOWER BUMPER COVER SUPPORT RAIL, RADIATOR SUPPORT SPLASH SHIELD, RIGHT FRONT FENDER LINER, RIGHT FRONT FOG LIGHT & BULB	225.00
Bumper Cover Support Rail - Right Lower 53851-08010	1.00	37.00	37.00	ALIGNMENT Four wheel alignment check, adjusted front camber and front toe into specification	129.00
Radiator Support Splash Shield 51441-08030	1.00	195.00	195.00	Customer is responsible for checking tire wear	
Inner Fender Liner - Right Front 53805-08010	1.00	99.00	99.00	PASSENGER SIDE SIDING DOOR NOT OPENING Get door open and working temporarily until body shop can repair	100.00
Fog Light Assembly w/ Bulb - Right Front 81210-08020	1.00	216.47	216.47	JOE RADER TOWING	171.00
Screws & Nylon Nuts 2	1.00	30.00	30.00		
Retainers 2	1.00	30.00	30.00		
Shop Supplies, Zipties 5	1.00	20.00	20.00		

Org. Estimate 993.22 Revisions 0.00 Current Estimate 993.22

Labor:	579.00
Parts:	896.11
Sublet:	171.00
SubTotal:	1,646.11
Tax:	90.54
Total:	1,736.65
Bal Due:	\$1,736.65

[Payments -]

Vehicle Received: 9/5/2024

Customer Number : 4039

I hereby authorize the above repair work to be done along with the necessary material and hereby grant you and/or your employees permission to operate the car or truck. An express mechanic's lien is hereby acknowledged on above car or truck to secure the amount of repairs thereto. Warranty work has to be performed in our shop & cannot exceed the original cost of repair. All parts removed will be discarded unless instructed otherwise. NOT RESPONSIBLE FOR LOSS OR DAMAGE TO CARS OR ARTICLES LEFT IN CARS IN CASE OF FIRE, THEFT OR ANY OTHER CAUSE.

Signature _____ Date _____

Email Address: traceysautomotive@gmail.com

Joe Rader Towing LLC

4701 N 32ND AVE
Wausau, WI 54401
(715) 212-4722
(715) 574-2105

PD.
✓ # 6206

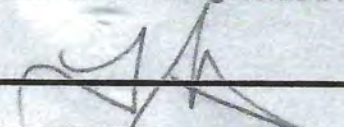
DATE	8-12-24	TIME	4:30	A.M.	REQUESTED BY	owner
LOCATION OF VEHICLE						
NAME				PHONE		
ADDRESS				ZIP		
MILEAGE		SERVICE TIME		EXTRA PERSON		
FINISH	033	FINISH		FINISH		
START		START		START		
TOTAL	026	TOTAL		TOTAL		
YEAR	13	MAKE / MODEL / COLOR	TOYOTA CORAZ		DRIVER	
STATE	WI	LIC. NO.	55MTC		VEHICLE I.D. NO.	
				STDK 3068DS 391579		
<input type="checkbox"/> SLING/HOIST TOW <input type="checkbox"/> WHEEL LIFT <input checked="" type="checkbox"/> FLAT BED/RAMP <input type="checkbox"/> START <input type="checkbox"/> LOCK OUT			<input type="checkbox"/> FLAT TIRE <input type="checkbox"/> OUT OF GAS <input type="checkbox"/> WRECK <input type="checkbox"/> RECOVERY		SPECIAL EQUIPMENT <input type="checkbox"/> SINGLE LINE WINCHING <input type="checkbox"/> DUAL LINE WINCHING <input type="checkbox"/> SNATCH BLOCKS <input type="checkbox"/> SCOTCH BLOCKS <input type="checkbox"/> DOLLY	
VEHICLE TOWED TO						
Tracy's						
REMARKS				MILEAGE CHARGE		
<p>DAMAGE RELEASE: I have been advised that my vehicle may be damaged if winched, towed, unlocked or left on unattended premises. I recognize the difficulty involved and I agree not to hold the towing service responsible for such damage should it result.</p> 				21.00		
				TOWING CHARGE		
				25.00		
				LABOR CHARGE		
				4.00		
OPERATOR'S SIGNATURE				STORAGE CHARGE		
AUTHORIZED SIGNATURE				TOTAL		
				146.00		

90772

Road Service



carpet

Claim Reference Id: 401953561ZCOL001-01

File Name: 20240819_132037.jpg

File Date: 08/20/2024

Label: carpet

Note:

Photo Location:

Photo Taken By: SEDGWICK

Estimate Indicator:

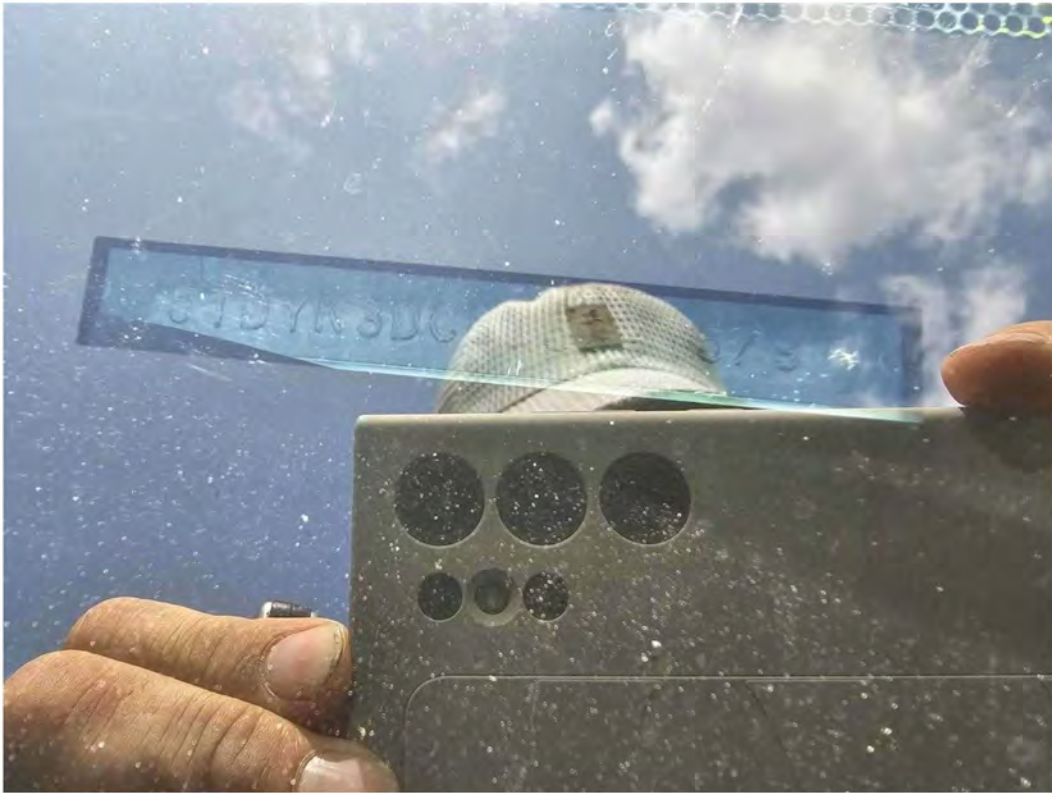

dash vin

Claim Reference Id: 401953561ZCOL001-01

File Name: 20240819_132026.jpg

File Date: 08/20/2024

Label: dash vin

Note:

Photo Location:

Photo Taken By: SEDGWICK

Estimate Indicator:



frt seats

Claim Reference Id: 401953561ZCOL001-01

File Name: 20240819_132036.jpg

File Date: 08/20/2024

Label: frt seats

Note:

Photo Location:

Photo Taken By: SEDGWICK

Estimate Indicator:



interior

Claim Reference Id: 401953561ZCOL001-01

File Name: 20240819_132033.jpg

File Date: 08/20/2024

Label: interior

Note:

Photo Location:

Photo Taken By: SEDGWICK

Estimate Indicator:



left frt

Claim Reference Id: 401953561ZCOL001-01

File Name: 20240819_132011.jpg

File Date: 08/20/2024

Label: left frt

Note:

Photo Location:

Photo Taken By: SEDGWICK

Estimate Indicator:



left inner door trim

Claim Reference Id: 401953561ZCOL001-01

File Name: 20240819_132034.jpg

File Date: 08/20/2024

Label: left inner door trim

Note:

Photo Location:

Photo Taken By: SEDGWICK

Estimate Indicator:



left rear

Claim Reference Id: 401953561ZCOL001-01

File Name: 20240819_132127.jpg

File Date: 08/20/2024

Label: left rear

Note:

Photo Location:

Photo Taken By: SEDGWICK

Estimate Indicator:



license

Claim Reference Id: 401953561ZCOL001-01

File Name: 20240819_132155.jpg

File Date: 08/20/2024

Label: license

Note:

Photo Location:

Photo Taken By: SEDGWICK

Estimate Indicator:



measurement

Claim Reference Id: 401953561ZCOL001-01

File Name: 20240819_132220.jpg

File Date: 08/20/2024

Label: measurement

Note:

Photo Location:

Photo Taken By: SEDGWICK

Estimate Indicator:



mileage

Claim Reference Id: 401953561ZCOL001-01

File Name: 20240819_132109.jpg

File Date: 08/20/2024

Label: mileage

Note:

Photo Location:

Photo Taken By: SEDGWICK

Estimate Indicator:



rt frt wheel skirt

Claim Reference Id: 401953561ZCOL001-01

File Name: 20240819_132233.jpg

File Date: 08/20/2024

Label: rt frt wheel skirt

Note:

Photo Location:

Photo Taken By: SEDGWICK

Estimate Indicator:



rt rear

Claim Reference Id: 401953561ZCOL001-01

File Name: 20240819_132148.jpg

File Date: 08/20/2024

Label: rt rear

Note:

Photo Location:

Photo Taken By: SEDGWICK

Estimate Indicator:



sunroof

Claim Reference Id: 401953561ZCOL001-01

File Name: 20240819_132046.jpg

File Date: 08/20/2024

Label: sunroof

Note:

Photo Location:

Photo Taken By: SEDGWICK

Estimate Indicator:



veh badges

Claim Reference Id: 401953561ZCOL001-01

File Name: 20240819_132152.jpg

File Date: 08/20/2024

Label: veh badges

Note:

Photo Location:

Photo Taken By: SEDGWICK

Estimate Indicator:



MFD. BY: TOYOTA MOTOR MANUFACTURING, INDIANA, INC. TIRES,
 GAWR: 2715KG (5995LB) WITH P235/55R18 COLD TIRE,
 GAWR: FRT. 1405KG (3100LB) RIMS, AT 240KPA (35PSI)
 18X7 J RIMS, AT 240KPA (35PSI)
 RR. 1405KG (3100LB) WITH P235/55R18 COLD TIRE,
 18X7 J RIMS, AT 240KPA (35PSI)
 FEDERAL MOTOR VEHICLE SAFETY STANDARDS IN EFFECT
 THIS VEHICLE CONFORMS TO ALL APPLICABLE
 VEHICLE SAFETY AND THEFT PREVENTION STANDARDS IN EFFECT
 THE DATE OF MANUFACTURE SHOWN ABOVE.
 MPV
 5TDYK3DC8D391579



C/IR: 070/LA42
 A/TM: -01A/U660E
 GSL30L-PFTQKA
 MADE IN U.S.A.
 802

vin tag

Claim Reference Id: 401953561ZCOL001-01

File Name: 20240819_132043.jpg

File Date: 08/20/2024

Label: vin tag

Note:

Photo Location:

Photo Taken By: SEDGWICK

Estimate Indicator:



Account No. 31075G

AAAM-MI

EM

Attention : Aaami Bot

THE AUTO CLUB GROUP

Metro Reporting Customer Support 1-800-245-6686 or help@metroreporting.com

Metropolitan Reporting Bureau
BOX 926, William Penn Annex
Philadelphia, PA 19105-0926
FAX (800) 343-9047

Type of Report: AUTO ACCIDENT

INSURED : BRITNEY TESKE
CLAIM NUMBER: 401953561
POLICY NUM. :
DATE OF LOSS: 08/13/24
LOSS STREET : 18 ALEXANDER AVE
LOSS CITY : ROTHSCHILD WI
POLICE DEPT.: MOUNTAIN BAY METRO POLICE DEPA
REPORT NUM. : 24-003070
PCT./DIST. : UNK
DESC.OF OTHER: COLL - INSURED STRUCK AND DAMAGED OBJECT

THANK YOU FOR THE ORDER! Any questions or problems please feel free to contact
PH. (800) 245-6686 or Help@metroreporting.com

NOTICE: The report/information provided to the end user (the Customer) most likely contains consumer identification information governed by the Federal Drivers Privacy Protection Act of 1994 (18 U.S.C. 2721 et seq.) (DPPA), the Gramm-Leach-Bliley Act (15 U.S.C. 6801 et seq.) (GLB), and the Fair Credit Reporting Act (15 U.S.C. 1681 et seq.) (FCRA), including all auto crash reports & all reports and information provided by state DMV'S.

Customer shall not use the information provided herein for any purpose that would violate the privacy obligation policy and any other terms and provisions of the DPPA, GLB or FCRA, or any similar federal, state or local statutes, rules, or regulations. The Customer is responsible for maintaining compliance; as such do not share report/information outside of your company. Any violation of these Laws may subject you to civil and/or criminal penalties.

Customer understands that results/data received are not proprietary, as such are being provided by a third-party source and therefore the accuracy of such results/data is not guaranteed.



3332576203

NBL0122XVT
24003070

WISCONSIN MOTOR VEHICLE
CRASH REPORT

MOUNTAIN BAY METRO PD
211 GRAND AVE
ROTHSCHILD, WI 54474
(715) 359-3879

NBL0122XVT

Document Number Override		Primary Crash Document #		Agency Crash Number 198		Investigating Officer/Deputy OFFICER BRADY PAISAR	
Crash Date 08/13/2024		Crash Time 09:01 PM		Date Arrived 08/13/2024		Time Arrived 09:10 PM	
Date Notified 08/13/2024		Time Notified 09:05 PM		Total Units 01		Total Injured 00	Total Killed 00
<input type="checkbox"/> On Emergency	<input type="checkbox"/> Hit and Run	<input type="checkbox"/> Lane Closure	<input type="checkbox"/> Work Zone	<input type="checkbox"/> Trailer or Towed	<input type="checkbox"/> Reporting Threshold		
<input type="checkbox"/> Government Property	<input type="checkbox"/> Active School Zone		School Bus Related NO		Tags		
<input checked="" type="checkbox"/> Reportable		Crash Type DT4000 (STANDARD CRASH)			<input type="checkbox"/> Amended	<input type="checkbox"/> Secondary Crash	

Description

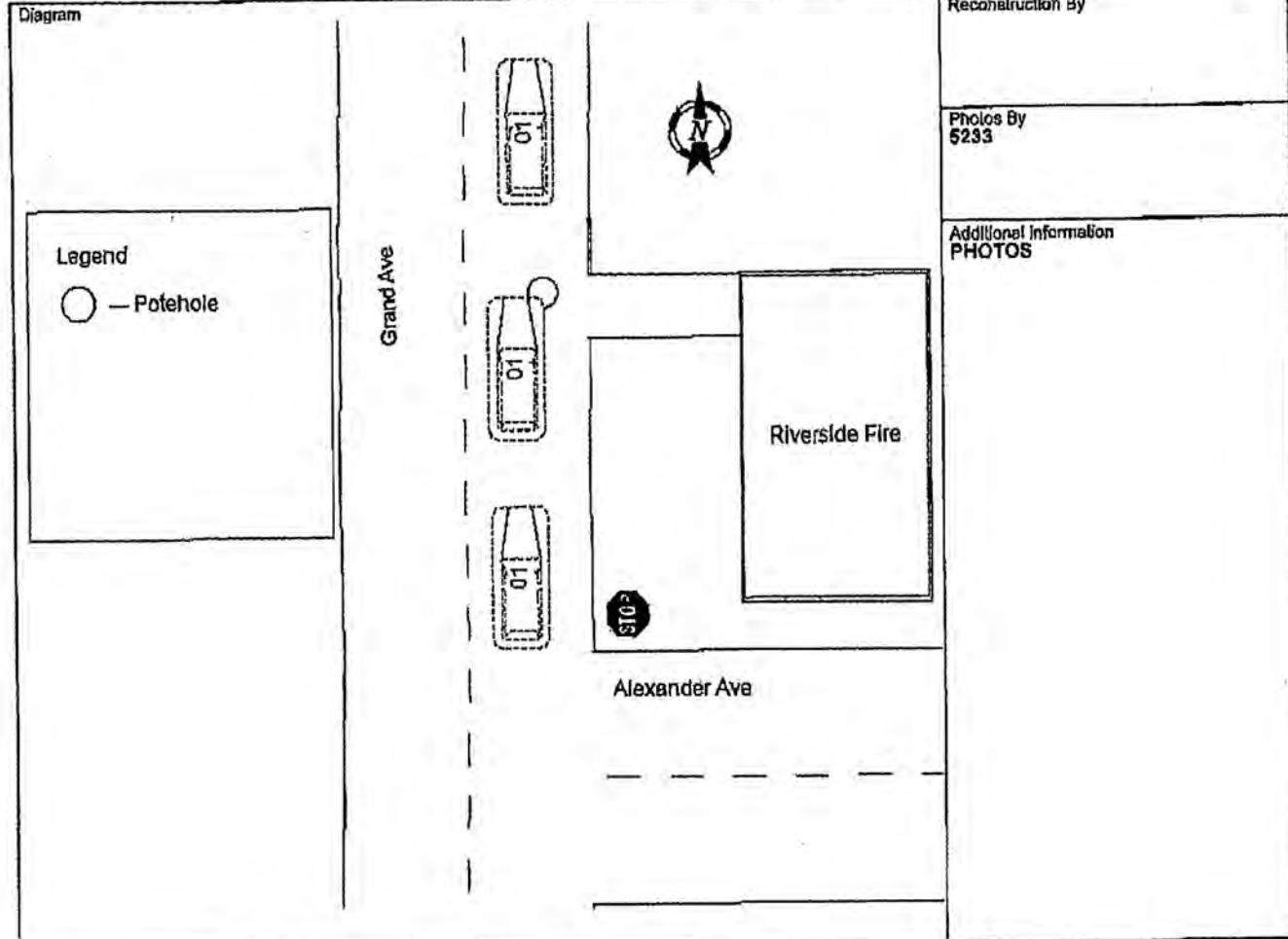

I, a sworn law enforcement officer, agree that I have not added any CJIS data in this report.

ON 08-13-24 AT 9:01 PM UNIT 1 WAS TRAVELING NORTHBOUND ON GRAND AVE NEAR ALEXANDER AVE WHEN A MANHOLE COVER CAME LOSE AND HIT THE VEHICLE ON THE PASSENGER SIDE.

NBL0122XVT
24003070

WISCONSIN MOTOR VEHICLE
CRASH REPORT

MOUNTAIN BAY METRO PD
211 GRAND AVE
ROTHSCHILD, WI 54474
(715) 359-3879

Location

ON BUSINESS STH61 NB 150 FT N OF ALEXANDER AVE (OTHER) IN THE VILLAGE OF ROTHSCHILD IN MARATHON COUNTY	Latitude	Longitude
	44.889428165	-89.624358926
	X Coordinate	Y Coordinate
	282762.5625	4974018
	Structure Type	
	OTHER	

Crash Scene

First Harmful Event	First Harmful Event Location	
OTHER OBJECT - NOT FIXED	ON ROADWAY	
Manner of Collision	Light Condition	
00 - NO COLLISION W/VEHICLE IN TRANSPORT	DUSK	
Road Surface Condition(s)	Roadway Factor(s)	
DRY	RUT, HOLES, BUMPS	
Environment Factor(s)		
NONE		
Weather Condition(s)		
CLEAR		
Animal Type	Relation To Trafficway	
	TRAFFICWAY - ON ROAD	
Crash Classification - Location	Crash Classification - Jurisdiction	
PUBLIC PROPERTY	NO SPECIAL JURISDICTION	
Tribal Land	Access Control	Special Study
	NO CONTROL	
Within Interchange Area	Junction Location	Intersection Type
NO	NON-JUNCTION	NOT AN INTERSECTION

Unit Summary

UNIT 01	Unit Status	Vehicle Operating As Classification		Unit Type		
	IN TRANSIT	D CLASS		AUTOMOBILE		
	Vehicle Type	Train/Bus # Recorded			Operating As Endorsements	
	PASSENGER VAN					
	Total Occs	Total # Citations Issued	Total Trailers	Total HazMat Types		
	1	0	0	0		
	Insurance?	Direction Of Travel	Pre Crash Tire Mark	Speed Limit	Total Lanes	
	YES	NORTHBOUND	<input type="checkbox"/>	35	4	
	Most Harmful Event: Collision With	Special Function		Emergency Motor Vehicle Use		
	OTHER OBJECT - NOT FIXED	NO SPECIAL FUNCTION		NOT APPLICABLE		
Traffic Way	Traffic Control		Traffic Control Inoperative/Missing			
TWO-WAY, NOT DIVIDED	NO CONTROL		NO			
Surface Type	Road Curvature		Road Grade			
BLACKTOP (BITUMINOUS)	STRAIGHT		LEVEL			
Truck Bus or HazMat						
NO						

Vehicle

UNIT 01 VEHICLE	License Plate Number	Plate Type	St	Country of Issuance	
	755MTC	AUT	WI	UNITED STATES	
	Vehicle Identification Number	Make	Year	Model	
	5TDYK3DC8DS391579	TOYT	2013	SIENNA	
	Color	Body Style	Bus Use		
	WHI - WHITE	VN - VAN			
Initial Contact Point	Vehicle Damage				
02 - RIGHT SIDE FRONT	02 - RIGHT SIDE FRONT, 03 - RIGHT SIDE MIDDLE, 04 - RIGHT SIDE REAR				
Extent Of Damage					
FUNCTIONAL DAMAGE					



NBL0122XVT
24003070

WISCONSIN MOTOR VEHICLE
CRASH REPORT

MOUNTAIN BAY METRO PD
211 GRAND AVE
ROTHSCHILD, WI 54474
(715) 359-3879

UNIT	Towed Due To Damage TOWED BUT NOT DUE TO DISABLING DAMAG	Vehicle Removed By OPERATOR
	What Driver Was Doing GOING STRAIGHT	Vehicle Factors
	Driver Prior Action Other	NOT APPLICABLE
01	Driver Actions 123	
	Owner Name BRITNEY R TESKE (715) 574-1801	Owner Address 151891 WISTERIA LN WAUSAU, WI 54401 , US
UNIT	Sequence Of Events	
	Event OTHER OBJECT - NOT FIXED	
	Event	
	Event	
	Event	
UNIT	Policy Holder	
	Insurance Company AMERICAN-AUTOMOBILE-INS-CO	INDIVIDUAL BRITNEY TESKE
UNIT	Individual	
	DRIVER BRITNEY R TESKE (715) 574-1801	Citations Issued 0
		Sex FEMALE
		Date of Birth 02/05/1992
	Race WHITE	
	Address 151891 WISTERIA LN WAUSAU, WI 54401 , US	Driver License Number T2000769264501 STATE: WISCONSIN COUNTRY: UNITED STATES
01	Safety Equipment	
	On Duty Crash	Safety Equipment SHOULDER & LAP BELT
	Row 01 - FRONT ROW	Seat Position 07 - LEFT
	Helmet Use	Helmet Compliance
	Eye Protection	Tint Compliance
	Injury	Injury Severity NO APPARENT INJURY
	Ejected NOT EJECTED	Ejection Path NOT EJECTED/NOT APPLICABLE
	Trapped/Extricated NOT TRAPPED	
	Medical Transport NOT TRANSPORTED	EMS Agency Identifier
	EMS Run #	
	Hospital	Date of Death
	Time of Death	
	Distracted By	Distracted By Source NOT APPLICABLE (NOT DISTRACTED)
	Distracted By Action NOT DISTRACTED	

NBL0122XVT
24003070

WISCONSIN MOTOR VEHICLE CRASH REPORT

MOUNTAIN BAY METRO PD
211 GRAND AVE
ROTHSCHILD, WI 54474
(715) 359-3879

UNIT INDIVIDUAL 01 001	Non Motorist		Striking Unit #	Location
	Prior Action			
	Action			
	Action Other			To/From School
	Drug & Alcohol		Suspected Alcohol Use NO	Suspected Drug Use NO
	Alcohol Test Given TEST NOT GIVEN		Alcohol Test Type	Alcohol Test Results
	Drug Test Given TEST NOT GIVEN		Drug Test Type	Drug Test Results
	Drug Type			
	Individual Condition APPEARED NORMAL			

CONTACT-MARATHON COUNTY By Email Communication/Correspondence Ashley Andrews 09/18/2024 16:43:31

From: Jaime Alberti <Jaime.Alberti@marathoncounty.gov>
Sent: Wednesday, September 18, 2024 4:26 PM
To: Andrews, Ashley N. <ANAndrews@acg.aaa.com>
Subject: [EXTERNAL] FW: 401953561 Britney Teske

Ashley:

Since we are a government agency, you will need to comply with Wis. Stat. § 893.80, which sets forth the process regarding claims against governmental bodies. Once the claim is filed with our County Clerk, we will provide a copy of the claim to our insurance company who will then investigate the matter and respond with their findings.

Thank you.

Jaime Alberti-Bowers

Paralegal/Risk Analyst PH: (715) 261-1138

FAX: (715) 261-1133

www.marathoncounty.gov

Jaime.Alberti@marathoncounty.gov

CONTACT-MARATHON COUNTY By Email Communication/Correspondence Ashley Andrews 09/19/2024 13:22:06 ZCOL BRITNEY TESKE 001

From: Kelly Schrepf <Kelly.Schrepf2@co.marathon.wi.us>
Sent: Thursday, September 19, 2024 1:05 PM
To: Andrews, Ashley N. <ANAndrews@acg.aaa.com>
Subject: Re: [EXTERNAL] 401953561 Britney Teske

I do not believe this pertains to the Marathon County Clerk of Court's office.

Kelly

MY RESPONSE:

From: Andrews, Ashley N. <ANAndrews@acg.aaa.com>
Sent: Thursday, September 19, 2024 1:21 PM
To: Kelly Schrepf <Kelly.Schrepf2@co.marathon.wi.us>
Subject: Re: [EXTERNAL] 401953561 Britney Teske

so if Marathon is not responsible and Rothschild is not, then who is? Have you reviewed the police report



CLAIM 401953561

Invoice IN0190436

08/21/2024

CCS 623685

AMOUNT DUE CCS: \$543.01

Insurance Company

Insured / Claimant

State: WI

AAA North
Ms. Ashley Andrews
Fax:
Customer:000000000752

Insured: BRITNEY TESKE
Vehicle:
VIN #:
Opened: 08/15/2024 Shipped / Installed: 08/21/2024

Equipment

QTY	Unit	Description & Condition	CCS Price	Labor	Total
1		Graco TURBO LX BACKLESS LATCH Car Seat () null	\$36.90	\$0.00	\$36.90
1	Each	UPPAbaby MESA V2 Car Seat () New	\$324.00	\$0.00	\$324.00
1		Graco TURBO LX BACKLESS LATCH Car Seat-1 () null	\$36.90	\$0.00	\$36.90
1		Graco TURBO LX BACKLESS LATCH Car Seat-2 () null	\$36.90	\$0.00	\$36.90
			\$434.70	\$0.00	\$434.70
			Shipping		\$80.00
			Tax: 5.5000% (Equip, Labor, S&H)		\$28.31
			Total Entitled		\$543.01
			Total Due CCS		\$543.01

Visit the CCS website at: www.ccsclaims.com for additional claim information or call us at: 800-227-8997.

Please Remit to Coordinated Claim Services, LLC (CCS) Upon Receipt: \$543.01

Fed. Tax ID 36-4266294

Please pay via Electronic Funds Transfer

If EFT is unavailable, Mail to:

Coordinated Claim Services, L.L.C. (CCS)

P.O. Box 1173

Deerfield, IL 60015

CCS assists with the replacement of Child Seats, Motorcycle Helmet/Safety Apparel & Car Audio along with vehicle contents such as phones and tablets.

3326752

Easement

THIS INDENTURE is made this _____ day of _____, _____, by and between **Marathon County, Wisconsin**, ("Grantor") and **WISCONSIN PUBLIC SERVICE CORPORATION**, a Wisconsin Corporation, along with its successors and assigns, (collectively, "Grantee") for good and valuable consideration, the receipt and sufficiency of which are hereby acknowledged, Grantor, owner of land, hereby grants and warrants to, Grantee, a permanent easement upon, within, beneath, over and across a part of Grantor's land hereinafter referred to as "easement area" more particularly described as follows:

Part of the North two hundred twenty (220) feet of the East one hundred seventy-three (173) feet of the Southeast Quarter of the Northeast Quarter (SE1/4-NE1/4) of Section 16, Township 29 North, Range 7 East, **Village of Maine, County of Marathon, State of Wisconsin**, as shown on the **attached Exhibit "A"**.

Return to:
Wisconsin Public Service Corp.
Real Estate Dept.
P.O. Box 19001
Green Bay, WI 54307-9001

Tax Parcel Identification Number (PIN)

146-2907-161-0994

- 1. Purpose: GAS** - The purpose of this easement is to construct, install, operate, maintain repair, replace and extend underground utility facilities, pipeline or pipelines with valves, tieovers, main laterals and service laterals, together with all necessary and appurtenant equipment under and above ground, including cathodic protection apparatus used for corrosion control, as deemed necessary by Grantee, for the transmission and distribution of natural gas and all by-products thereof, or any liquids, gases, or substances which can or may be transported or distributed through a pipeline, including the customary growth and replacement thereof. Trees, bushes, branches and roots may be trimmed or removed so as not to interfere with Grantee's use of the easement area.
- 2. Access:** Grantee shall have the right to enter on and across any of the Grantor's property outside of the easement area as may be reasonably necessary to gain access to the easement area and as may be reasonably necessary for the construction, installation, operation, maintenance, inspection, removal or replacement of the Grantee's facilities.
- 3. Buildings or Other Structures:** Grantor agrees that no structures will be erected in the easement area or in such close proximity to Grantee's facilities as to create a violation of all applicable State of Wisconsin electric and gas codes or any amendments thereto.
- 4. Elevation:** Grantor agrees that the elevation of the ground surface existing as of the date of the initial installation of Grantee's facilities within the easement area will not be altered by more than 4 inches without the written consent of Grantee.
- 5. Restoration:** Grantee agrees to restore or cause to have restored Grantor's land, as nearly as is reasonably possible, to the condition existing prior to such entry by Grantee or its agents. This restoration, however, does not apply to any trees, bushes, branches or roots which may interfere with Grantee's use of the easement area.

- 6. Exercise of Rights:** It is agreed that the complete exercise of the rights herein conveyed may be gradual and not fully exercised until sometime in the future, and that none of the rights herein granted shall be lost by non-use.
- 7. Binding on Future Parties:** This grant of easement shall be binding upon and inure to the benefit of the heirs, successors and assigns of all parties hereto.
- 8. Easement Review:** Grantor acknowledges receipt of materials which describe Grantor's rights and options in the easement negotiation process and furthermore acknowledges that Grantor has had at least 5 days to review this easement document *or* voluntarily waives the five day review period.

[REMAINDER OF PAGE LEFT BLANK]

TEMPORARY EXHIBIT "A"

NOT TO SCALE
FOR REFERENCE ONLY



12 FOOT WIDE EASEMENT

LOT 1

06N103-26

****Temporary Exhibit ****
****Final Exhibit will be sent for approval at a later date ****

N 26TH AV

3325153

Easement

THIS INDENTURE is made this _____ day of _____, _____, by and between **Marathon County** ("Grantor") and **WISCONSIN PUBLIC SERVICE CORPORATION**, a Wisconsin Corporation, along with its successors and assigns (collectively, "Grantee") for good and valuable consideration, the receipt and sufficiency of which are hereby acknowledged, Grantor, owner of land, hereby grants and warrants to, Grantee, a permanent easement upon, within, beneath, over and across a part of Grantor's land hereinafter referred to as "easement area" more particularly described as follows:

**COPY FOR
YOUR RECORD**

Part of the Parcel described in the attached Exhibit B, as shown on the attached Exhibit A.

Return to:
Wisconsin Public Service Corp.
Real Estate Dept.
P.O. Box 19001
Green Bay, WI 54307-9001

Tax Parcel Identification Number
(PIN)

291-2907-352-0998

- 1. Purpose: GAS** - The purpose of this easement is to construct, install, operate, maintain repair, replace and extend underground utility facilities, pipeline or pipelines with valves, tieovers, main laterals and service laterals, together with all necessary and appurtenant equipment under and above ground, including cathodic protection apparatus used for corrosion control, as deemed necessary by Grantee, for the transmission and distribution of natural gas and all by-products thereof, or any liquids, gases, or substances which can or may be transported or distributed through a pipeline, including the customary growth and replacement thereof. Trees, bushes, branches and roots may be trimmed or removed so as not to interfere with Grantee's use of the easement area.
- 2. Access:** Grantee shall have the right to enter on and across any of the Grantor's property outside of the easement area as may be reasonably necessary to gain access to the easement area and as may be reasonably necessary for the construction, installation, operation, maintenance, inspection, removal or replacement of the Grantee's facilities.
- 3. Buildings or Other Structures:** Grantor agrees that no structures will be erected in the easement area or in such close proximity to Grantee's facilities as to create a violation of all applicable State of Wisconsin electric and gas codes or any amendments thereto.

4. **Elevation:** Grantor agrees that the elevation of the ground surface existing as of the date of the initial installation of Grantee's facilities within the easement area will not be altered by more than 4 inches without the written consent of Grantee.
 5. **Restoration:** Grantee agrees to restore or cause to have restored Grantor's land, as nearly as is reasonably possible, to the condition existing prior to such entry by Grantee or its agents. This restoration, however, does not apply to any trees, bushes, branches or roots which may interfere with Grantee's use of the easement area.
 6. **Exercise of Rights:** It is agreed that the complete exercise of the rights herein conveyed may be gradual and not fully exercised until sometime in the future, and that none of the rights herein granted shall be lost by non-use.
 7. **Binding on Future Parties:** This grant of easement shall be binding upon and inure to the benefit of the heirs, successors and assigns of all parties hereto.
 8. **Easement Review:** Grantor acknowledges receipt of materials which describe Grantor's rights and options in the easement negotiation process and furthermore acknowledges that Grantor has had at least 5 days to review this easement document *or* voluntarily waives the five day review period.
-

[REMAINDER OF PAGE LEFT BLANK]

WITNESS the hand and seal of the Grantor the day and year first above written

Marathon County
Organization name

Sign Name
Print name & title

Sign Name
Print name & title

STATE)
OF _____)
)SS
COUNTY)
OF _____)

This instrument was acknowledged before me this _____ day of _____, _____, by the above-named Marathon County, to me known to be the Grantor(s) who executed the foregoing instrument on behalf of said Grantor(s) and acknowledged the same

Sign Name
Print Name

Notary Public, State of
My Commission expires:

This instrument drafted by: Nick Curran
Wisconsin Public Service Corporation

REMS Entity ID	WR Number	Document ID	REMS Formatted Number
1480521	WMIS-3419154	3325153	INT11-480-521

TEMPORARY EXHIBIT "A"
NOT TO SCALE
FOR REFERENCE ONLY



Proposed 12 Foot Wide Easement

EXHIBIT "B"

Property Description from Marathon County Register of Deeds Document number #1493816

Parcel Identification Number: #291-2907-352-0998

= 1493816

1493816

"Marathon Park" is described as follows:

The Northeast quarter (NE 1/4) of the Northeast quarter (NE 1/4), and the north eighty (80) feet of the Southeast quarter (SE 1/4) of the Northeast quarter (NE 1/4) of Section thirty-four (34) and the Northwest quarter (NW 1/4) of the Northwest quarter (NW 1/4) and the North eighty (80) feet of the Southwest quarter (SW 1/4) of the Northwest quarter (NW 1/4) of Section Thirty-five (35) all in Township Twenty-nine (29) North of Range Seven (7) East, excepting the right-of-way of the Chicago & Northwestern Railway Company, and that portion of said land lying South of said right-of-way.

Pin#	37.291.4.2907.341.0999	✓ NE NE & SE NE
Tax Key#	59.342907.1	
Pin#	37.291.4.2907.352.0998	✓ NW NW & SW NW
Tax Key#	59.352907.6	