

C.T.H. "C" TOWN OF SPENCER

P.R.A. DISTRICT OFFICE	PROJECT	SHEET NUMBER	TOTAL SHEETS
WIS. 5N			

BENCH MARKS			
1	0+35	SPIKE IN P. POLE NW COR.	450.00
2	11+00	" " " " 50' L	454.06
3	26+28	" " " " T. POLE 50' R	431.60
4	39+35	TOP SW ABUT. OF BRIDGE	423.84
5	43+41	" " " " " " " "	426.99

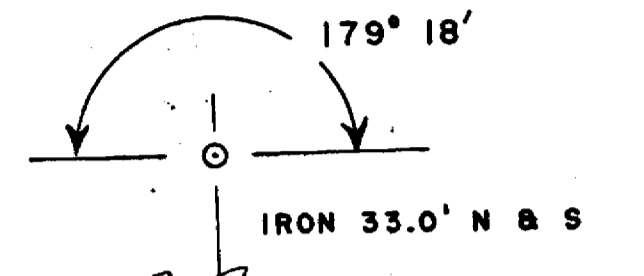
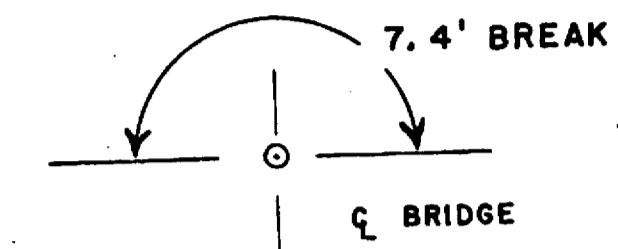
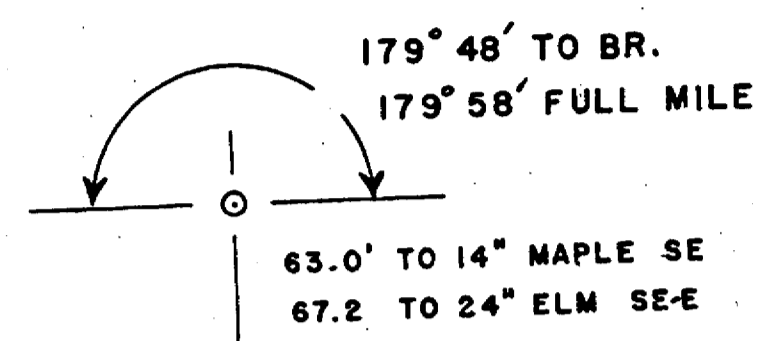
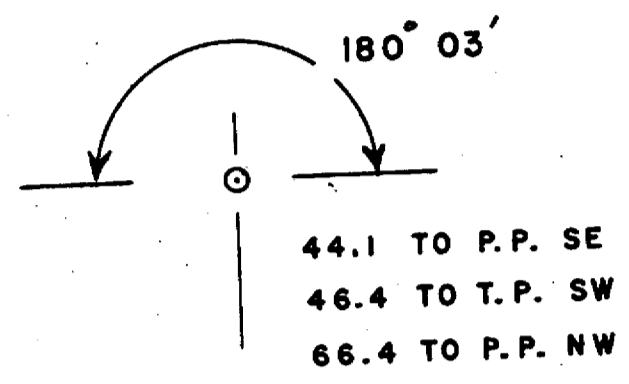

SEC. 3  
T26N  
R2E

SEC. 10  
T26N  
R2E

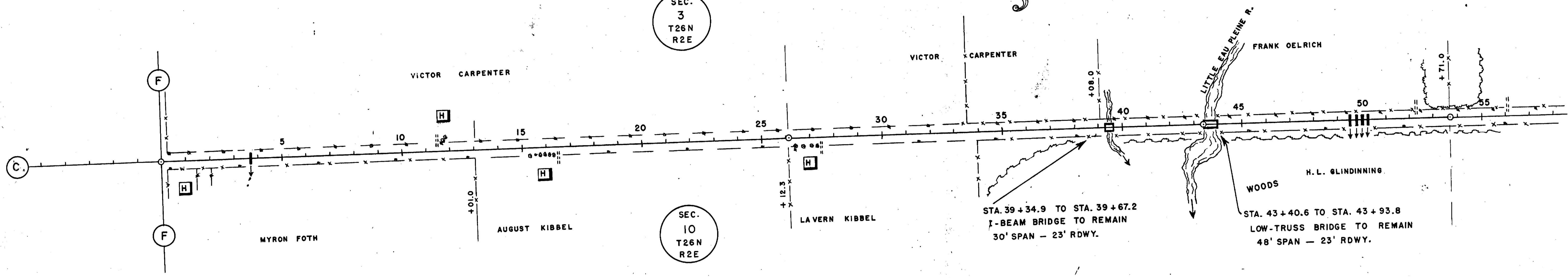

STA. 39+34.9 TO STA. 39+67.2  
I-BEAM BRIDGE TO REMAIN  
30' SPAN - 23' RDWY.

STA. 43+40.6 TO STA. 43+93.8  
LOW-TRUSS BRIDGE TO REMAIN  
48' SPAN - 23' RDWY.

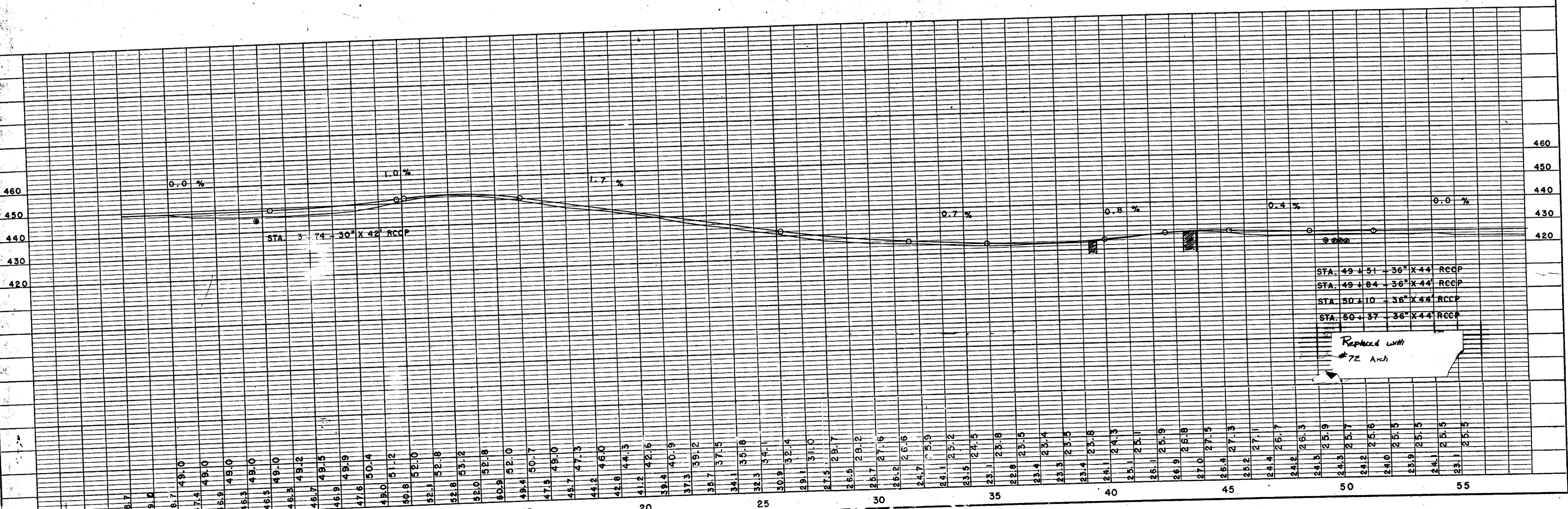

P.R.A. DISTRICT OFFICE	PROJECT	SHEET NUMBER	TOTAL SHEETS
WIS. 5N			

BENCH MARKS			
6	65 + 71	SPIKE IN P. POLE 35' R	423.02
7	78 + 27	3RD FEN. POST R	431.89
8	89 + 44	P. POLE 40' R	444.44
9	105 + 90	P. POLE 35' R	435.20

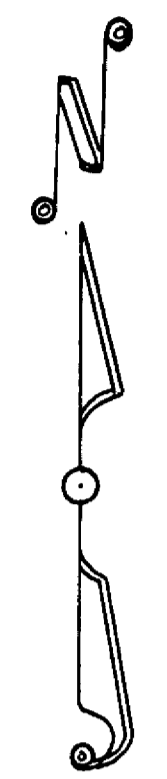
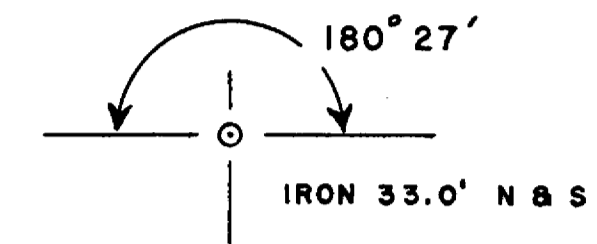
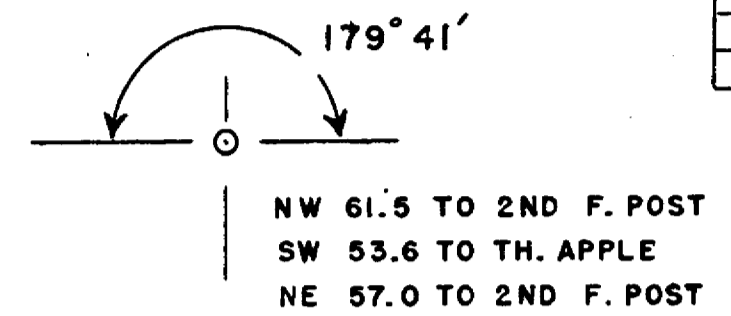
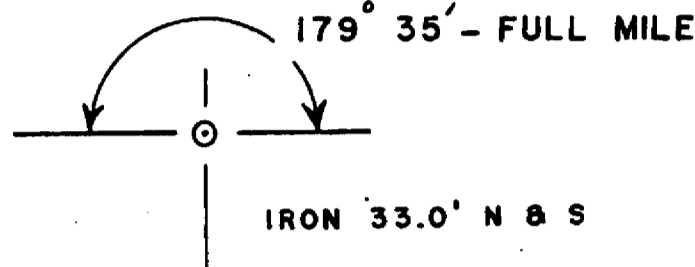

SEC.  
2  
T26N  
R2E

SEC.  
11  
T26N  
R2E

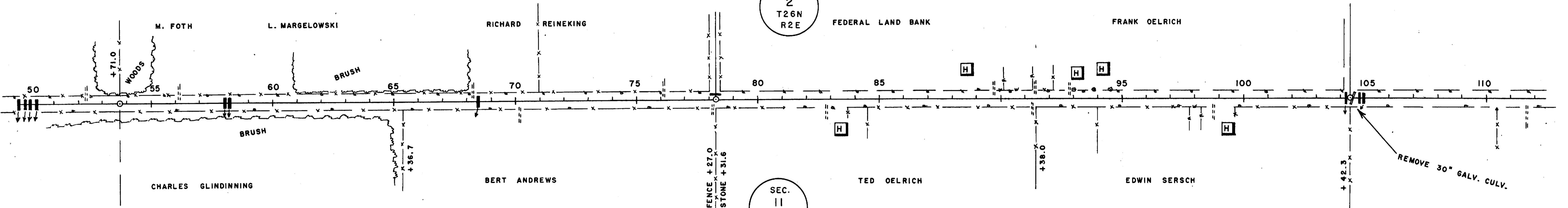

Replaced with #72 Arch

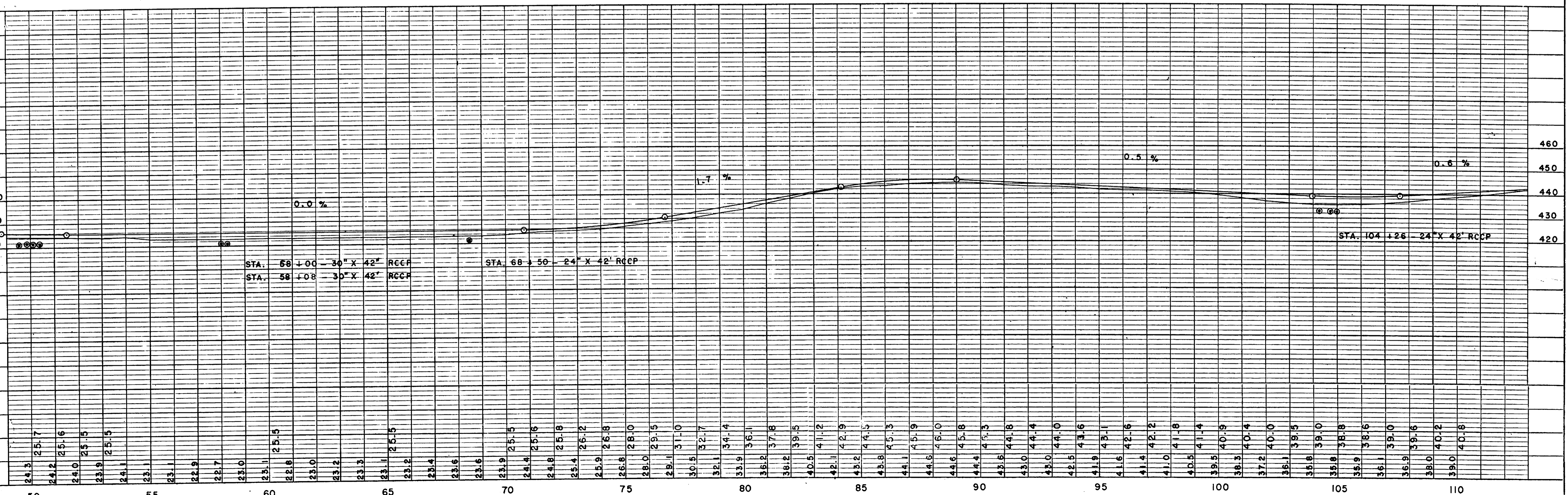



P.R.A. DISTRICT OFFICE	PROJECT	SHEET NUMBER	TOTAL SHEETS
WS, 5 N			

BENCH MARKS			
9	105+90	SPIKE IN P. POLE 35' R	435.20
10	124+53	12" BOX ELD. 80' L	452.19
11	125+15	P. POLE 35' R	449.48
12	145+20	NE COR. SHED 90' R	463.56
13	146+84	12" MAPLE 30' L	463.95

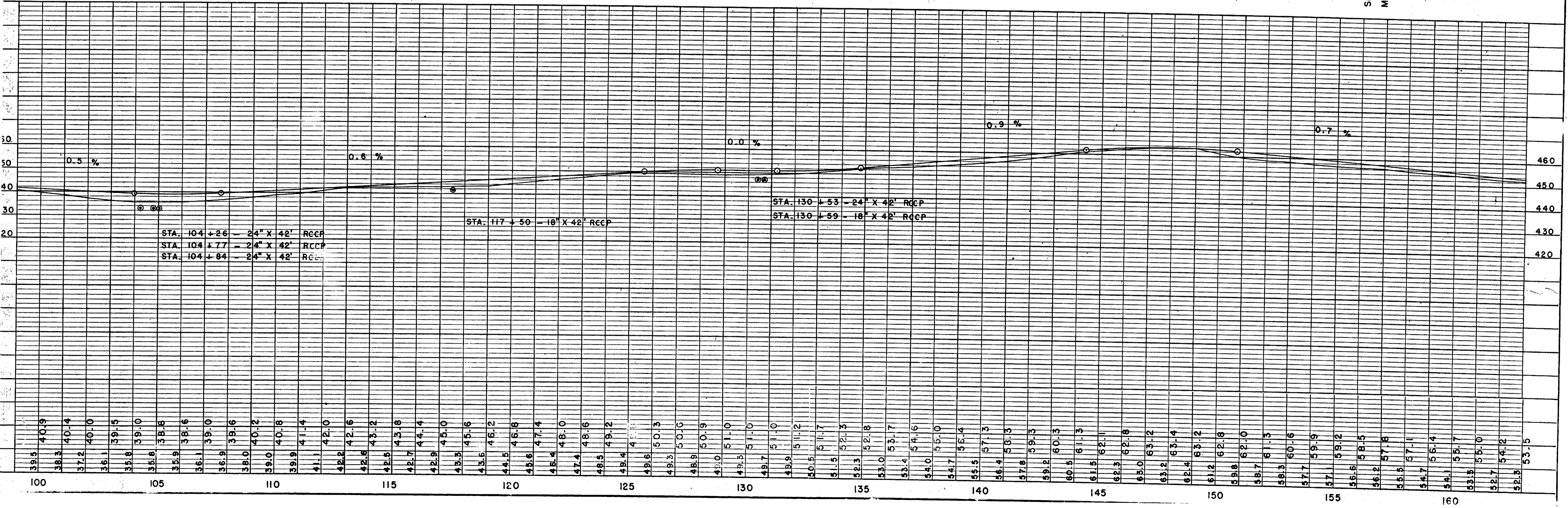
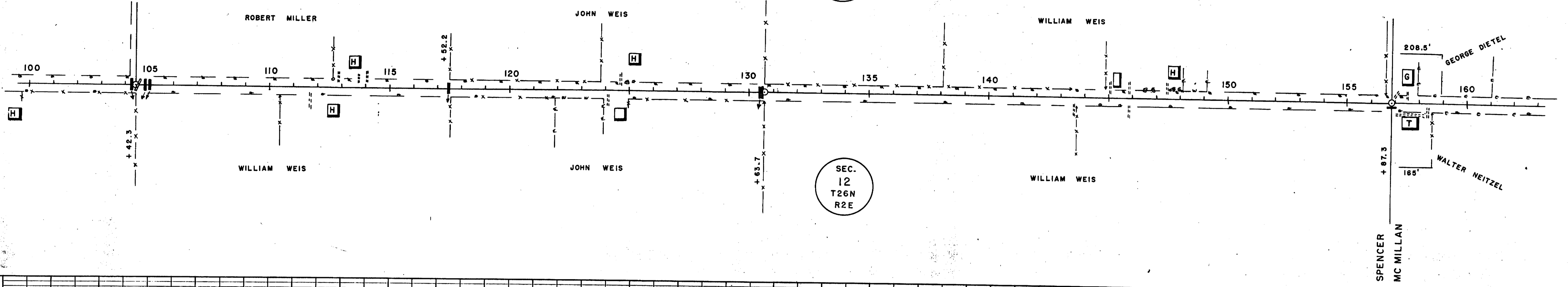
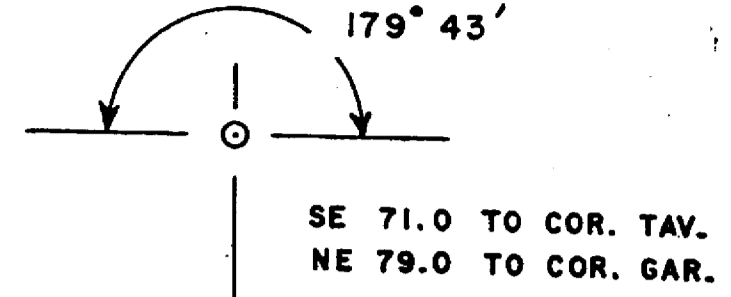
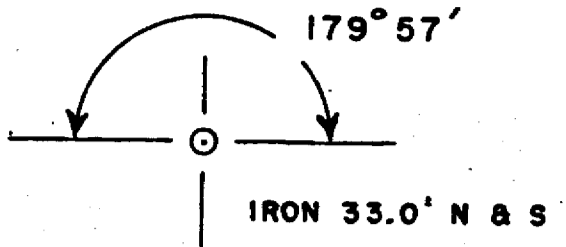
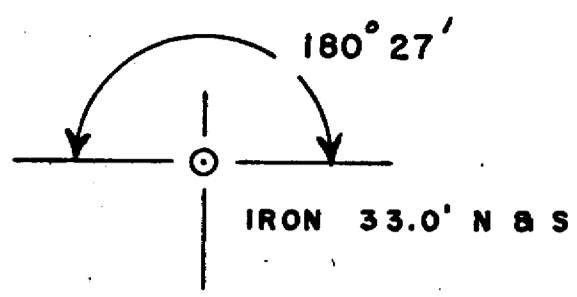



FED. ROAD DIST. NO.	STATE	PROJ. NO.	SHEET NO.	TOTAL SHEETS
4	WISC.			

DIVISION JOB NO. \_\_\_\_\_

BENCH MARKS				
14	157+00	SPIKE IN P. POLE	130' L	454.43
15	157+45	W. SILL GAR. DOOR	L	454.83
16	172+85	TOP SW ABUT. BR.	R	446.98
17	182+00	SPIKE IN 10" ELM	50' L	450.63
18	191+55	24" ELM	120' L	466.52
19	195+50	12" OAK	25' L	466.61

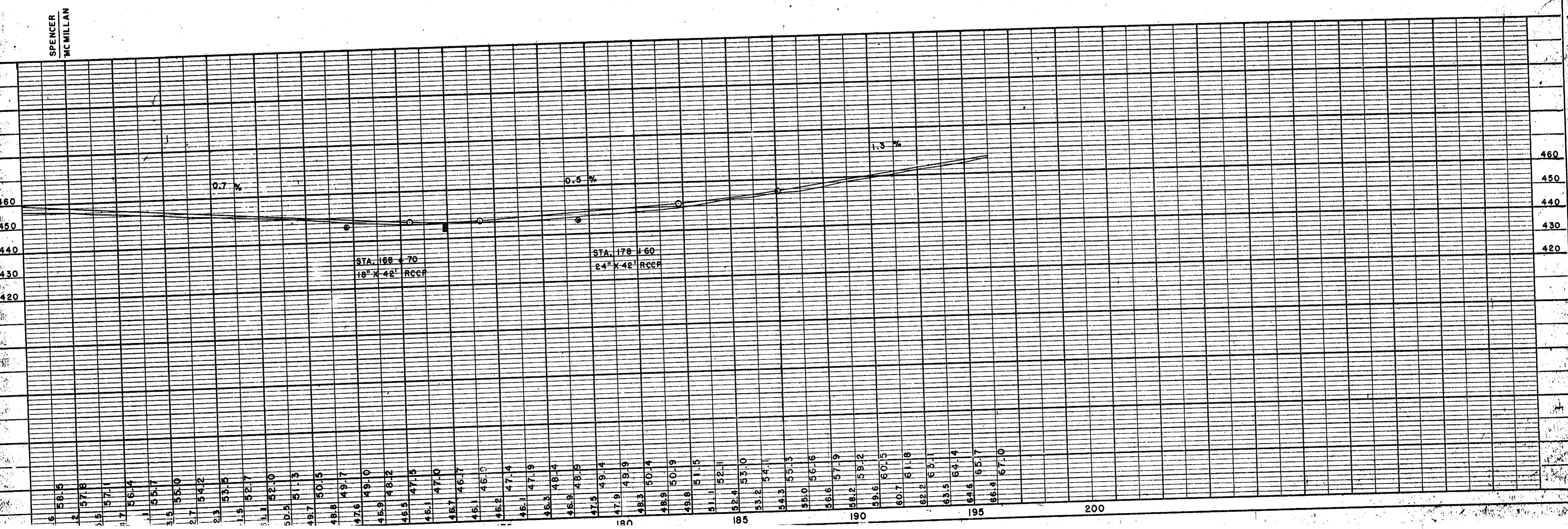
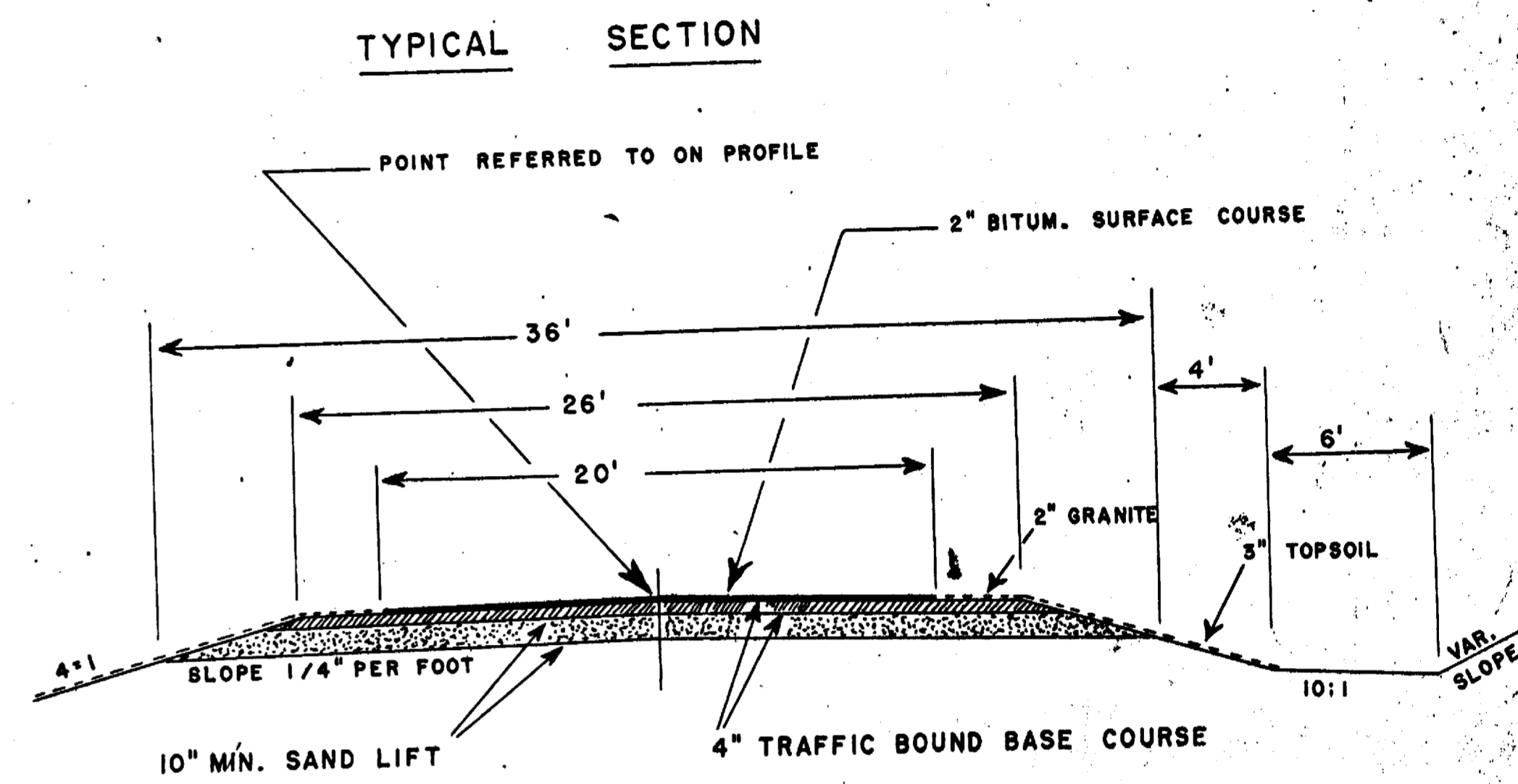
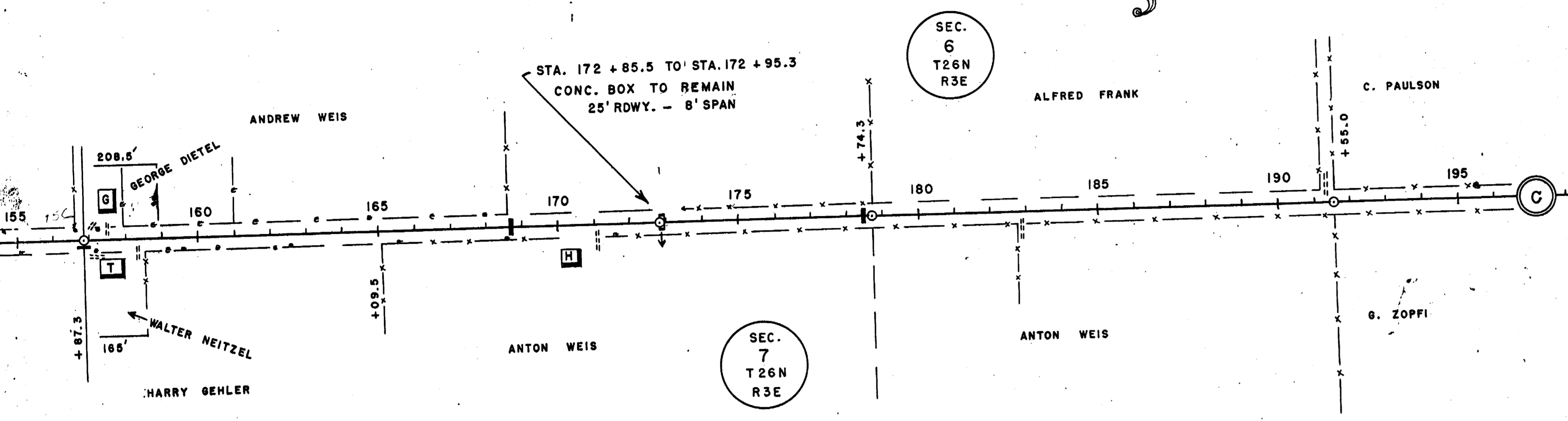
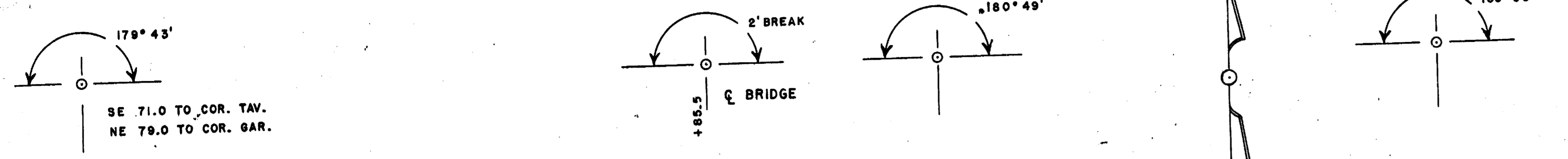

SPENCER  
MCMILLAN