

Map Date: 8/10/2023

Path: O:\Common\gisdata\address_stuff\Uniform_Address_Maps\address_map_book_18_18.mxd



State & US	Sections (est.)
County	City/Village
Local	Hydrants
Streams & Rivers	Inset Areas
Municipal Boundary Line	

TOWN OF JOHNSON



This map shows the approximate relative location of property boundaries but was not prepared by a professional land surveyor.
 This map is provided for informational purposes only and may not be sufficient or appropriate for legal, engineering, or surveying purposes.
 This is NOT a legal survey document!
 Marathon County assumes NO legal responsibility for the accuracy of the information contained herein.
 This map is to be used for reference only!

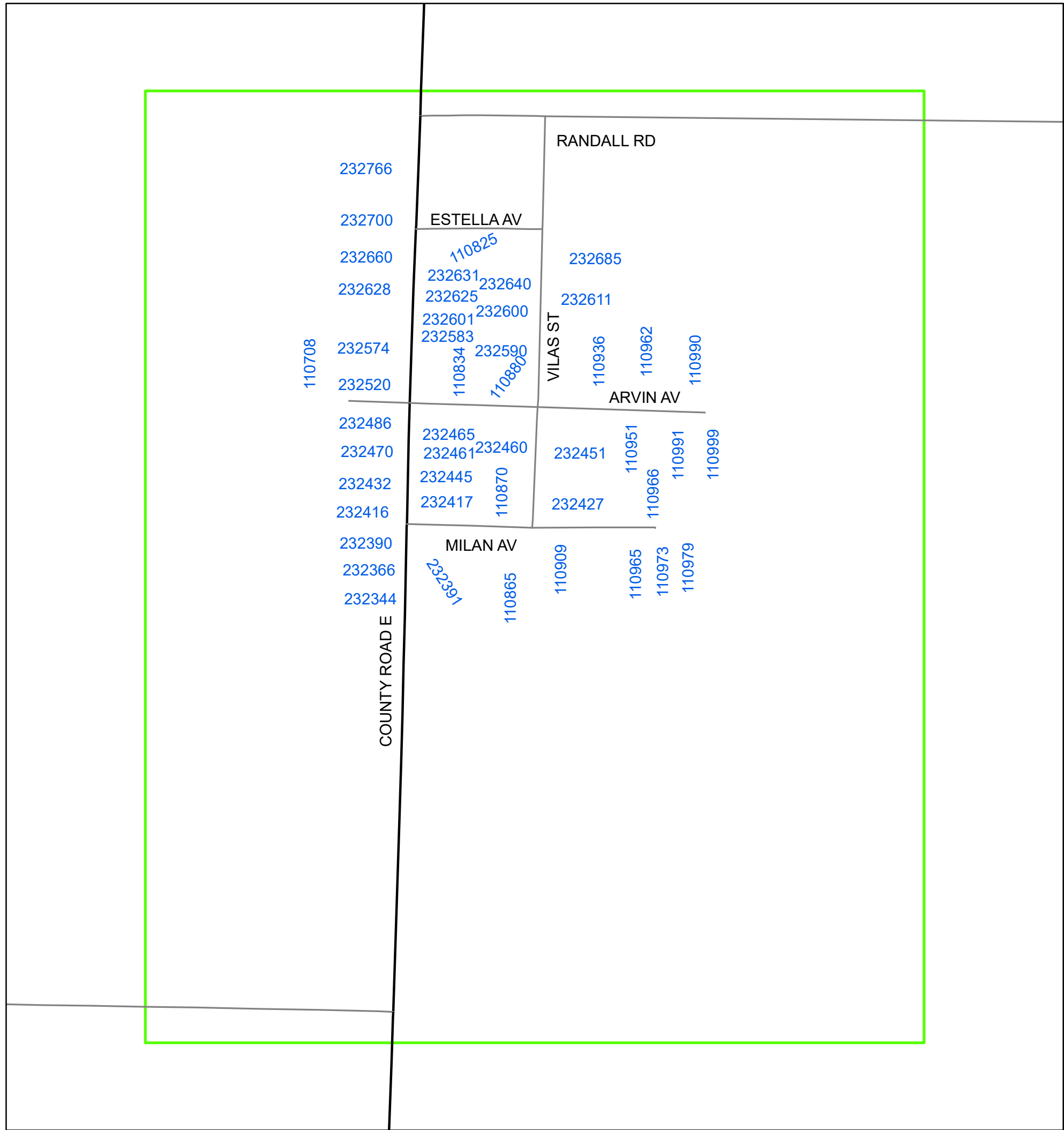

MILAN

