

- State & US
- County
- Local
- Streams & Rivers
- Municipal Boundary Line
- Sections (est.)
- City/Village
- Hydrants
- Inset Areas

TOWN OF REID



This map shows the approximate relative location of property boundaries but was not prepared by a professional land surveyor.
 This map is provided for informational purposes only and may not be sufficient or appropriate for legal, engineering, or surveying purposes.
 This is NOT a legal survey document!
 Marathon County assumes NO legal responsibility for the accuracy of the information contained herein.
 This map is to be used for reference only!

Map Date: 8/11/2023

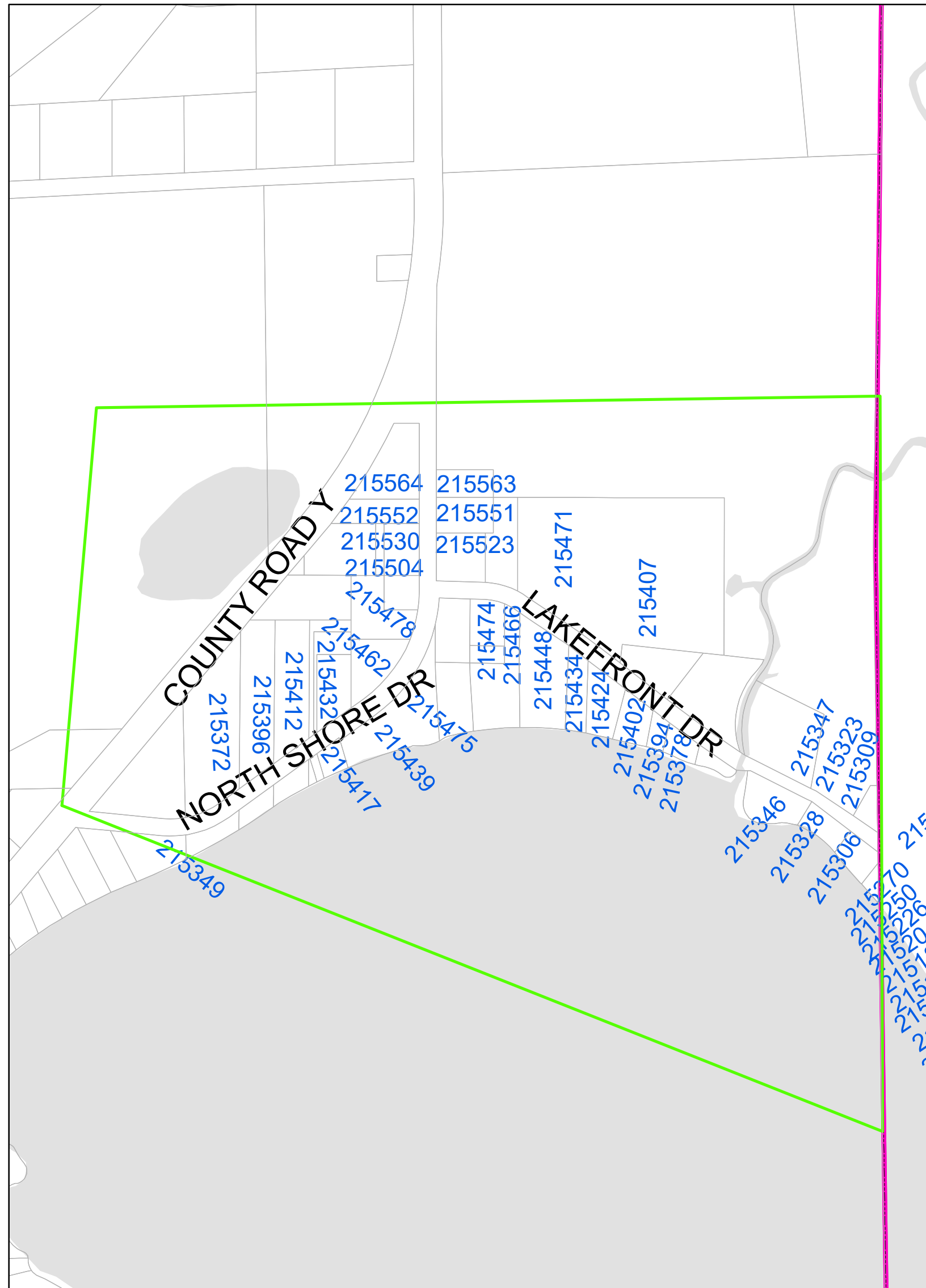

PIKE LAKE AREA