



## MARATHON COUNTY PARK COMMISSION AGENDA

**Date and Time of Meeting:** Tuesday, June 27, 2023 at 10:30am

**Meeting Location:** 212 River Dr. Wausau WI 54403, Room 5

The meeting site identified above will be open to the public. Persons wishing to attend the meeting by phone may call into the telephone conference beginning ten minutes prior to the start time indicated above using the following number: 1-408-418-9388 Access code: 2490 568 4174. When you enter the telephone conference, PLEASE PUT YOUR PHONE ON MUTE!

### **Park Commission Members -**

Commissioners: Dawn Herbst, Jean Maszk, Allen Opall, Rick Seefeldt, Kelly Zagrzebski, Lou Larson, Vacant

***Marathon County Mission Statement:** Marathon County Government serves people by leading, coordinating, and providing county, regional, and statewide initiatives. It directly or in cooperation with other public and private partners provides services and creates opportunities that make Marathon County and the surrounding area a preferred place to live, work, visit, and do business. (Last updated: 12-20-05)*

***Parks, Recreation and Forestry Department Mission Statement:** Adaptively manage our park and forest lands for natural resource sustainability while providing healthy recreational opportunities and unique experiences making Marathon County the preferred place to live, work, and play.*

### **Agenda Items**

- 1. Call to Order**
- 2. Public Comment Period – Not to Exceed 15 Minutes – Any Person Who Wishes to Address the Commission Must Provide, Name, Address and the Topic to the President of the Commission No Later than Five Minutes Before the Start of the Meeting. Topics must be relevant to the Committee’s area of jurisdiction.**
- 3. Approval of the Minutes of the May 30, 2023 Park Commission Meeting**
- 4. Policy Issues for Discussion and Committee Determination**
  - A. Discussion and Possible Action by Committee
    1. Proclamation Designating July as Park and Recreation Month
    2. Establishing an Archery Hunting Season in Big Eau Pleine Park
- 5. Operational Functions Required by Statute, Ordinance or Resolution:**
  - A. Discussion and Possible Action by Committee
    1. None
  - B. Discussion and Possible Action by Committee to Forward to the Environmental Resource Committee for its Consideration
    1. Updates to Chapter 19 of the Marathon County General Code
- 6. Policy Issues for Discussion and Committee Determination for Consideration by Environmental Resources Committee**
  - A. Discussion and Possible Action Considering the Potential Sale of County Parkland

**7. Educational Presentations/Outcome Monitoring Reports**

- A. Project Update (SunnyVale Softball, Shooting Range, Big Eau Pleine, Playgrounds, Kayak Launch)
- B. Marathon Park Water Project Update
- C. State of Wisconsin Proclamation: Great Outdoors Month
- D. Thank You Letter from Sporting Heritage Youth Day

**8. Announcements**

- A. Next Meeting Date & Time, Location – Tuesday, August 1, 2023 at 10:30am, 900 Pardee St. Wausau, WI 54401 Followed by a Joint Meeting with the Fair Board.
- B. Future Agenda Items – Bat HCP Enrollment Program,

**9. Adjourn**

Signed /s/ Jamie Polley  
Presiding Officer or Her  
Designee

*Any person planning to attend this meeting who needs some type of special accommodation in order to participate should call the County Clerk's Office at 715-261-1500 or e-mail [countyclerk@co.marathon.wi.us](mailto:countyclerk@co.marathon.wi.us) one business day before the meeting.*

FAXED TO DAILY HERALD

THIS NOTICE POSTED AT THE

COURTHOUSE

(Email/Fax City Pages, Marshfield News, Midwest Radio Group)

Date June 22, 2023 Time 1:45 p.m.

By Jodi Luebbe

Date \_\_\_\_\_ Time \_\_\_\_\_

By \_\_\_\_\_

**AGENDA SUMMARY**

4A1. Discussion and Possible Action Establishing an Archery Hunting Season in Big Eau Pleine Park  
Big Eau Pleine Park is the County's largest County Park consisting of 1,453 acres that is surrounded by water on three sides and farmland or hardwoods on the fourth. The forest of the park is one that is managed by our County Forestry staff for safety, forest health and regeneration. About six (6) years ago the County Forester set up a deer exclusion area to monitor the effects of deer browse on forest regeneration. The negative impact the deer are having on the forest regeneration is very evident through the pictures that have been taken each year (attached). Staff can see sugar maple seedlings are growing inside the fence although they are not visible in the pictures since they take a while to grow. The vegetation outside of the fence is eaten down very low. In addition, the County has had requests over the years from the landowners to the north asking to allow deer hunting in the park due to the large number of deer in the area and the amount of crop damage they see each year.

Having a deer hunt in the park is a topic that has been discussed by staff over the past few years. Staff recently met with the Wildlife Biologist of the WI DNR to discuss options. If the Commission chooses to consider allowing a deer hunt in the park this year, there are a few options to consider. The County could offer a special hunt that would specify the dates, number of tags available, what can be harvested, etc. This process would have citizens apply for tags and if more applications were received then the number of tags that exist there would be a lottery. The other option is to open the park (or a portion of the park) to archery hunting during the regular archery season. This would allow any person with an archery tag the ability to hunt in the park and both bucks and does could be harvested.

There are pros and cons to each option. A special hunt would require a high amount of administrative work on both the county and the DNR and could limit the impact on the deer herd. A special hunt however would allow the County to have more control and get accurate data on what was harvested. A regular season hunt would be recommended to follow the same guidelines of the State Park System with an opening date of November 15. This would minimize the impact on the other uses of the park. A regular hunt would potentially yield a higher impact on the deer herd. Per the DNR Wildlife Biologist it is important to control the deer herd to reduce the spread of disease, reduce the damage to crops and increase forest regeneration for a healthy forest.

The Park Commission is asked to determine if a deer hunt is desirable. If it is determined that a deer hunt is desirable the Park Commission is asked to set the process and update the ordinance to allow archery hunting in Big Eau Pleine. If the Park Commission chooses a special deer hunt, staff will gather all the details from the DNR and bring the final details for approval to the August meeting. If the Park Commission chooses to follow the rules of the State Parks no further information is needed and action can be taken.

5B1. Discussion and Possible Action by Committee to Forward to the Environmental Resource Committee for its Consideration Updates to Chapter 19 of the Marathon County General Code  
Attached are proposed changes to Chapter 19 of the Marathon County General Code. Updates to the code include clarifying the smoking regulations as it pertains to parks and park facilities and adding fat tire biking. As usual staff is working to mirror the city and the county park ordinances where possible. The smoking regulations mirror the City park ordinance. In addition, fat tire biking is currently allowed in Big Eau Pleine Park however not addressed in the park ordinance. Other minor grammatical changes are also included.

One additional change that is included in the draft updates is the hunting regulation. Based on the action taken in item 4A1, this update will be recommended, changed or deleted during the meeting.

The Park Commission is asked to approve the ordinance revisions and recommend approval of the changes to the Environmental Resources Committee.

**6A. Discussion and Possible Action Considering the Potential Sale of County Parkland**

The Department has recently been approached by a citizen to purchase county owned land near DC Everest Park that is adjacent to their property. In researching this property, it was donated to the County in 2002 in conjunction with the County purchasing the adjacent property. The property does not have any park dedication stipulation however it was purchased to potentially relocate the parking lot for DC Everest Park in the event that the park could be expanded to include additional green space and increase the uses of the park per attached Resolution R-30-02.

A similar request was made in late 2002 where the Park Commission choose not to divest in the entire property but negotiated the sale of 10' of the property to the adjacent landowner for access to his parcel. There is potential in the future for park expansion as the Eagles Club property falls within the park acquisition boundaries and would significantly enhance the park and the public's access to Lake Wausau. The parcel in question currently is used for dock storage and if the park is enhanced could serve as a parking area for the park.

Staff recommends that the Park Commission choose not to divest of this county owned property and plan to utilize it in the future to enhance the park.

**7A. Project Update**

SunnyVale Softball: Sunnyvale Softball Complex hosted the Wausau Slugfest last weekend and was very successful.

Shooting Range: culvert replacement is complete including paving by the Highway Department

Big Eau Pleine: disc golf tee pads complete

Playgrounds: Bluegill and Mission need soil restoration  
Cherokee needs chips and border  
Eau Claire Dells is fully operational.

Kayak launch: The new ADA launch funded by the Lake Wausau Association has been installed at DC Everest Park.

**7B. Marathon Park Water Project**

The Main contractor is complete, concrete work is complete, plumber is working on building hook-ups, and paving will be completed soon. Parks staff is working to complete the site restoration.

**DRAFT**  
**MARATHON COUNTY PARK COMMISSION**

Date and Time of Meeting: May 30, 2023 at 10:30am Location: Room 5 at 212 River Dr., Wausau WI 54403

Park Commissioners present: Dawn Herbst, Lou Larson, Jean Maszk, Rick Seefeldt, Kelly Zagrzebski  
Excused: Allen Opall

Staff present: Jamie Polley - Parks, Recreation and Forestry Director, Marcus Aumann - Assistant Director -  
Community Services-(via web-ex), Andy Sims – Assistant Director - Operations

**1. Call to Order** – President Seefeldt called the Park Commission meeting to order at 10:30 am. Official notice and the agenda for the meeting was posted publicly in accordance with the State statutes.

**2. Public Comment** – none brought forward

**3. Approval of the Minutes of the February 28, 2023 Park Commission Meeting – Motion** by Maszk, second by Herbst to approve the May 2, 2023 meeting minutes with the change that it was President Seefeldt that called the meeting to order not Vice-President Herbst. Motion **carried** by voice vote, vote reflected as 5-0.

**4. Policy Issues for Discussion and Committee Determination**

A. Discussion and Possible Action by Committee - None

**5. Operational Functions Required by Statute, Ordinance or Resolution:**

A. Discussion and Possible Action by Committee - None

B. Discussion and Possible Action by Committee to Forward to the Environmental Resource Committee for its Consideration – None

**6. Policy Issues for Discussion and Committee Determination for Consideration by Environmental Resources Committee**

A. Discussion regarding 2024 Annual Budget and Policy Recommendations from the Committee

1. Review of Mandatory / Discretionary Program Document, 2. Review of Rates and Fees Document, 3. Review of 5-Year Departmental Expense/Levy Document - Polley explained that part of the County Board's new budget process involves going through an extensive education process. One area of education is mandated versus non-mandated services and another area is levy support. From a budgetary standpoint not every dollar in the budget is the same. If a dollar is cut in one department that is 50% levy funded it doesn't have the same impact on the tax levy (necessarily) as if a dollar is cut from a department that is 90% levy funded.

Polley discussed a levy support analysis (sustainability plan) the Department had put together explaining how it would like to move forward with the goals of finding ways to reduce dependence on tax levy dollars for operations and capital projects and increasing efficiencies in the department. The Department does not have mandated services but some things it does are supported by State statute and ordinances. While it is not mandated, it provides a lot of services that are of benefit to the County and have a positive impact. It makes the area a desirable place to live and work and has a tremendous effect on the economy and economic development. Another reason the levy support analysis was put together was to look at increasing costs and growing responsibilities without increased staffing. The Department wants to maintain quality services and facilities while meeting demands and wants around parks and recreation. Staff feels it's efficient in the way staff and projects are managed with the amount of property it maintains but can always improve. Polley discussed the efficiencies of being a joint City and County department. She discussed the plan giving information on historical collective budget changes, legislative changes, the largest operational additions, operational removals, the Department's three enterprise funds, the current fee philosophy, current operations, current staffing, and the positive impacts of parks and recreation to the community. Staff is always looking at ways to modify its operations, fees, and searches for sponsorships and grants. It questions investing in revenue sources such as what facilities are missing from the community and what things it could expand on. Polley discussed three actionable steps the Department has created to pursue for the coming years to help aid it in the direction of continued resource stewardship. She also mentioned that the State if desired, could provide additional

funding or support for conservation and recreation by taking several steps to modify existing legislation. Questions were answered and discussion followed.

## **7. Educational Presentation/Outcome Monitoring Reports for Discussion**

A. Wausau/Marathon County Parks & Recreation Foundation Update – Polley reported that the Foundation has been working on the Great Pinery Heritage Waterway Trail. Signs will be installed at various locations. A national park service grant was received to help with marketing, mapping, and finding an overall manager of the trail. The Foundation is also working on updating its bylaws and a Memorandum of Understanding with Ironbull. It has updated its grant application process at the Community Foundation making them more visible on their website and has confirmed that the Wausau and Marathon County park system is given priority for grants with consideration for others after that.

B. Capital Improvement Projects Submitted – Polley discussed the capital projects that were submitted for review for 2024 and are in order of priority include Nine Mile Septic System Replacement, Dells of Eau Claire Restroom/Shower Facility, Dump Station Installation and Camper Cabins, Arena Architectural Study, Eastgate Hall Improvements, Big Eau Pleine Restroom/Shower Facility, Cherokee Restroom Replacement, Site Planning and Architectural Study for Marathon Park Junction and Family Area.

C. Project Update – Sports Complex – four field markers received new bases and were straightened after extensive settling. This work was completed prior to the MC United Spring Cup Tournament. The Spring Cup Tournament was a very successful tournament for the soccer organization as well as the community. Thousands of people enjoyed the complex either as a player, spectator, volunteer or referee. Shooting Range – Emergency culvert repair was needed after the culvert was washed out. This work closed the range for one day. Staff is completing the upgrades to the Archery Range to close out the grant that enabled the improvements including the elevated shooting platform. Playgrounds – Bluegill Bay – Playground installation complete, waiting for border to be poured and engineered wood fibers (EWF) Cherokee – Playground installation scheduled for week of 5/29 Mission Lake – Playground installed, waiting on border and EWF Sunnyvale Softball – Batting cage installed.

D. Marathon Park Water Project – Polley reported the watermain has been replaced and is now looped through the park from Garfield Ave. to Stewart Ave. The next step is to install the laterals off the watermain. Once the contracted work is complete parks staff will complete the site restoration.

## **8. Announcements**

A. Next Meeting Date & Time, Location – Tue., June 27, 2023 at 10:30am, 212 River Dr., Rm 5, Wausau, WI 54403 or webex.

B. Future Agenda Items – Big Eau Pleine Special Deer Hunt, Bat HCP Enrollment Program, Ordinance Updates

**9. Adjourn - Motion** by Herbst, second by Zagrzebski to adjourn the meeting at 11:50am. Motion **carried** by voice vote, vote reflected as 5-0.



# STATE of WISCONSIN



## OFFICE of the GOVERNOR

# Proclamation

*WHEREAS*; Wisconsin is proud to have 50 state parks, 15 state forests, 44 state trails, 84,000 miles of rivers and streams, more than 15,000 lakes, more than 800 miles of Great Lakes shoreline, 4 national parks and trails, and countless recreation areas, local parks, and green spaces; and

*WHEREAS*; from hunting and fishing to boating and paddling to snowboarding and skiing, outdoor recreation is a fundamental part of the state's culture and heritage, improving the quality of life, drawing visitors from all over the world, supporting tens of thousands of jobs, and serving as a major economic driver for communities across Wisconsin; and

*WHEREAS*; with an economic impact estimated at \$8.7 billion annually, Wisconsin's outdoor recreation industry is a top marketable driver of tourism in the state and a major economic driver for local communities, directly supporting local businesses and nearly 90,000 jobs across various sectors; and

*WHEREAS*; since its inception in 2019, the Office of Outdoor Recreation has proven to be an important resource for residents and visitors, federal, state, and local agencies, the recreation and tourism industries, recreationists and outdoor enthusiasts, businesses, and other partners to connect the dots to bolster outdoor recreation in the state and make outdoor recreation opportunities more accessible for all to enjoy; and

*WHEREAS*; enjoyment of the great outdoors is provides all Wisconsinites with the opportunity to reflect on the state's long-standing, proud history of conservation and environmental stewardship and to renew the shared commitment of protecting Wisconsin's vast and valuable natural resources; and

*WHEREAS*; this month, the state of Wisconsin celebrates the long-standing partnerships that help make Wisconsin's outdoor recreation industry the best it can be, encourages folks and families to get outside and explore, and commits to ensuring outdoor recreation in the state thrives for years and generations to come;

*NOW, THEREFORE*, I, Tony Evers, Governor of the State of Wisconsin,  
do hereby proclaim June 2023, as

## GREAT OUTDOORS MONTH

throughout the State of Wisconsin and I commend this observance  
to all our state's residents.



IN TESTIMONY WHEREOF, I have hereunto set my hand and caused the Great Seal of the State of Wisconsin to be affixed. Done at the Capitol in the City of Madison this 31<sup>st</sup> day of May 2023.

TONY EVERS  
GOVERNOR

By the Governor:

SARAH GODLEWSKI  
Secretary of State



# BIG EAU PLEINE COUNTY PARK

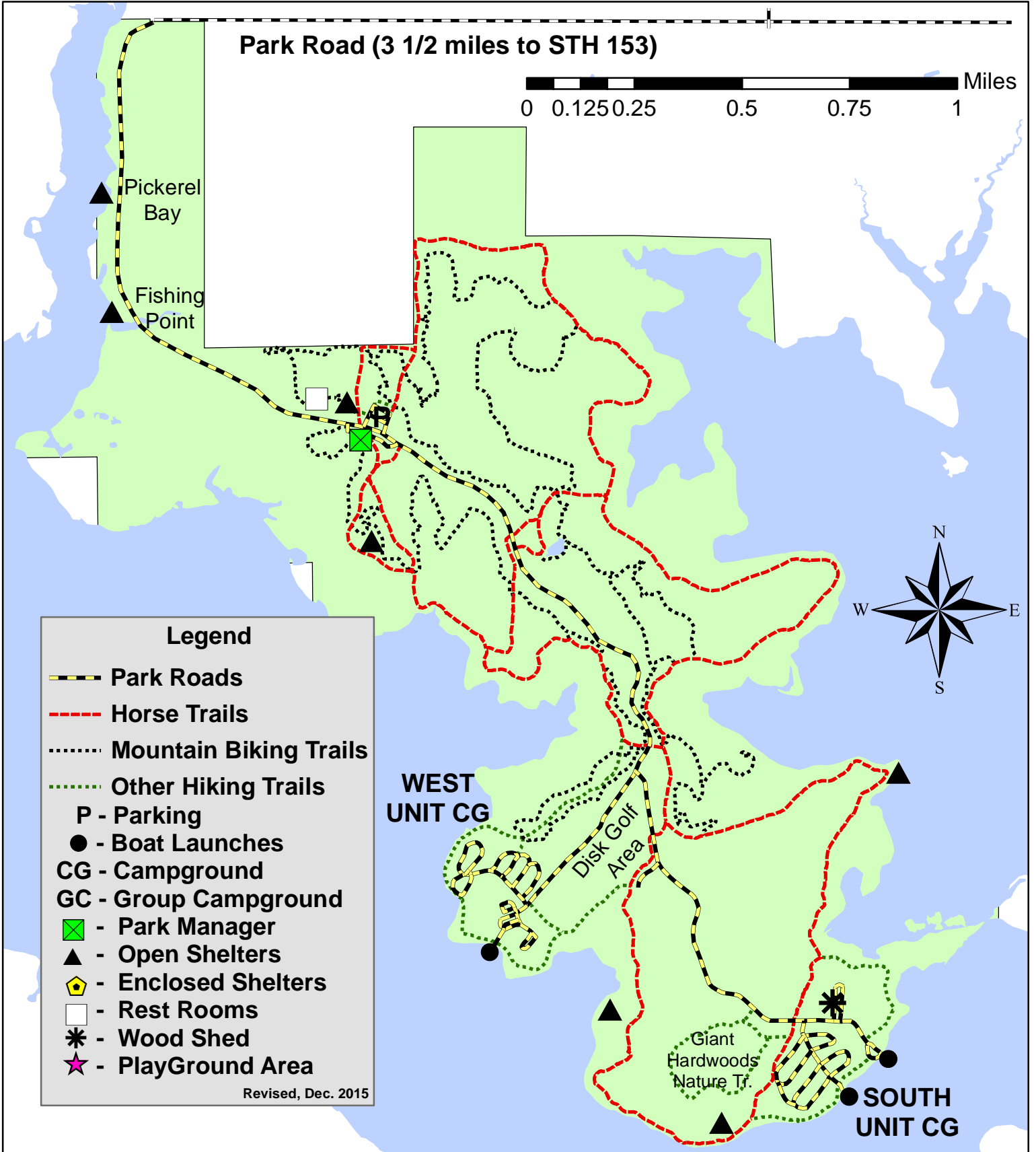

## West Unit CG

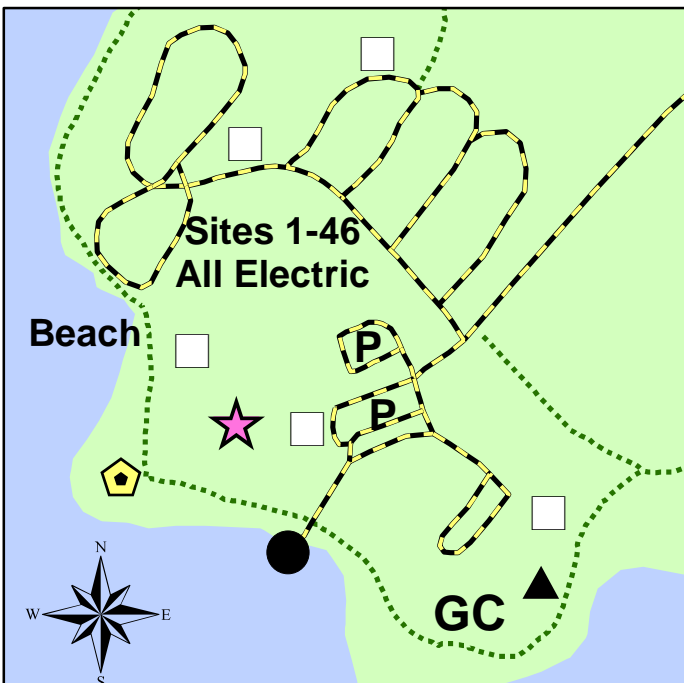

## South Unit CG

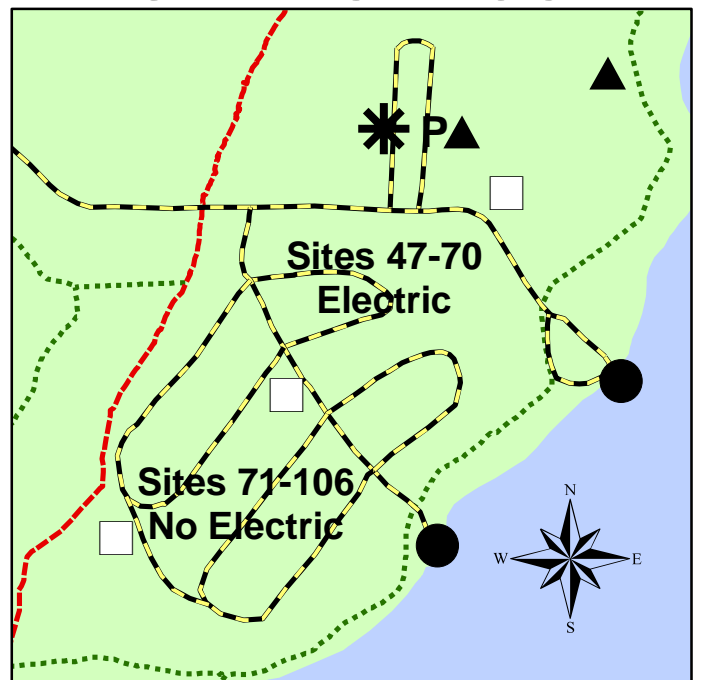









# Rib Mountain State Park

## Hunting and Trapping Map

PUB PR-2210  
Rev. 11/21/2014



Deer hunting by archery and muzzleloader only during the traditional 9 day gun and 10 day muzzleloader seasons in this area. You may use any legal firearm for small game hunting and for the 4-day antlerless deer hunt.

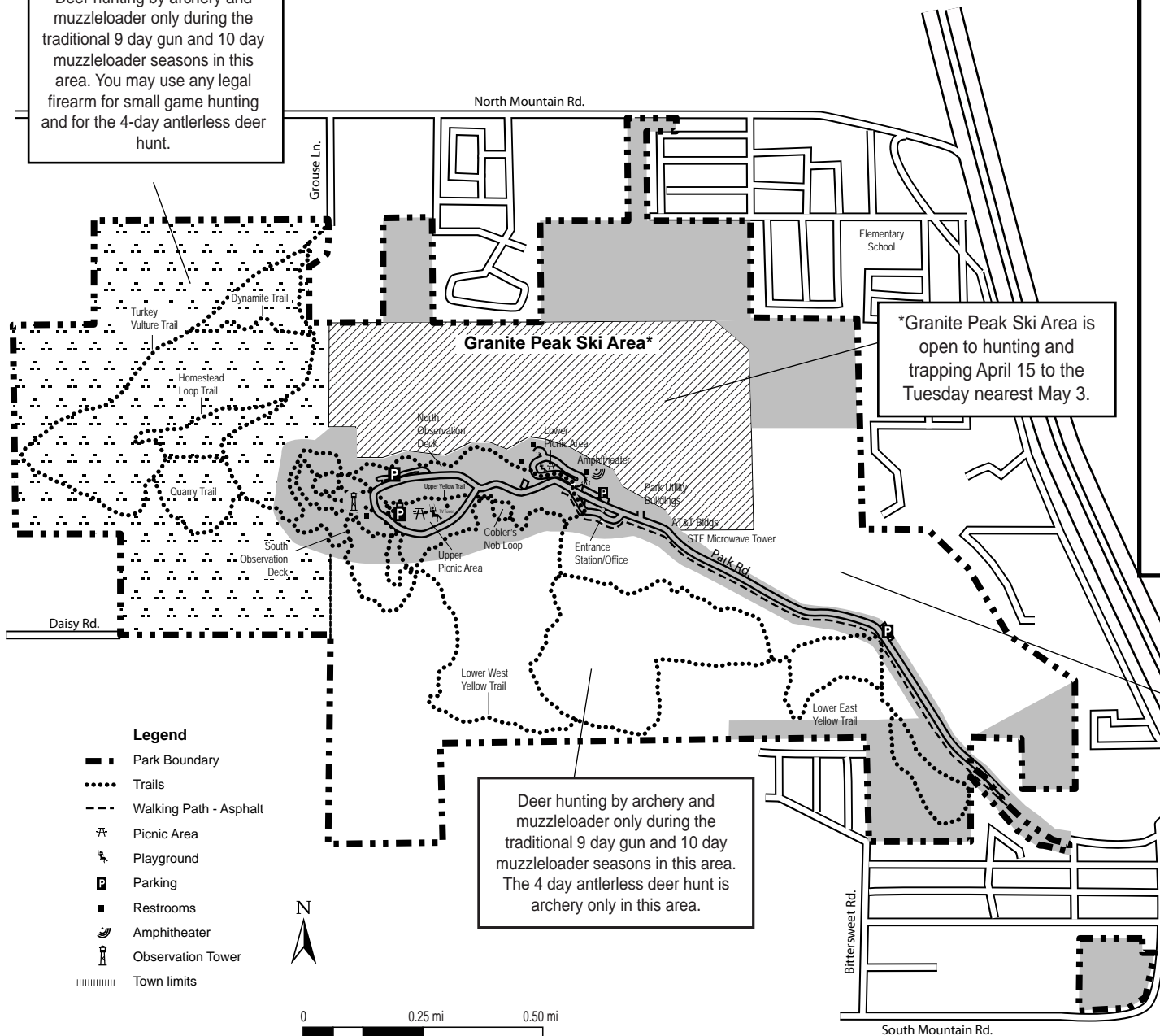

### Season Structure

- Closed
- Open (A, B and C apply)
- Open (A, B and C apply)
- Granite Peak (D applies)

**A. Fall/Winter (Deer Hunting):** The traditional 9 day deer hunting season, the muzzleloader season, the 4 day antlerless deer hunting season and the archery deer hunting season that fall between Nov. 15 through the Sunday nearest Jan. 6 are allowed in the open areas of the property. See map for weapon restrictions in each area.

**B. Fall/Winter (All Hunting and Trapping other than Deer Hunting):** Small game hunting and trapping are allowed in the open areas of the property from Nov. 15 - Dec. 15., except that hunting with legal archery methods is allowed through the Sunday nearest Jan. 6. Trapping is not permitted in closed areas as noted on this map or within 100 yards of any designated use area, including trails. See map for weapon restrictions in each area.

**C. Spring:** Archery hunting and limited trapping are allowed April 1 through the Tuesday nearest May 3.

**D. Spring:** Archery hunting and limited trapping are allowed in the Granite Peak Ski Area April 15 through the Tuesday nearest May 3.

\*Granite Peak Ski Area is open to hunting and trapping April 15 to the Tuesday nearest May 3.

Deer hunting by archery and muzzleloader only during the traditional 9 day gun and 10 day muzzleloader seasons in this area. The 4 day antlerless deer hunt is archery only in this area.

Deer hunting by archery and muzzleloader only during the traditional 9 day gun and 10 day muzzleloader seasons in this area. The 4 day antlerless deer hunt is archery only in this area.

- #### Legend
- Park Boundary
  - Trails
  - Walking Path - Asphalt
  - Picnic Area
  - Playground
  - Parking
  - Restrooms
  - Amphitheater
  - Observation Tower
  - Town limits



See Wisconsin State Parks and Trails Hunting and Trapping Rules and Regulations page for more details. Updates will be posted at the park office. *Map is not to scale.*



# Wisconsin State Parks and Trails Hunting and Trapping Rules and Regulations

Hunting and trapping are allowed in most state parks and on some linear trails each year from November 15 – December 15. Hunting with legal bow and crossbow methods is allowed Dec. 15 through the Sunday nearest January 6. Also, hunting and trapping are allowed April 1 through the Tuesday nearest May 3. Some parks and trails have weapons restrictions, variances in season dates, or are closed or have areas closed to hunting and trapping. For questions on specific parks, check with the park office and consult the park's hunting map (see reverse) for specific dates and allowable activities.

For more information on hunting rules, regulations and season dates, please see the DNR website at [dnr.wi.gov](http://dnr.wi.gov), and search keyword: regulations.

## Park Regulations and General Information

- Park vehicle admission stickers are required on all motorized vehicles that enter a state park. Hunters are encouraged to purchase stickers before opening morning to avoid delays at the office or self-registration stations.
- Hunters are responsible for parking in designated parking areas and other approved areas. All parking and traffic regulations apply during the hunting seasons. Off-road motor vehicle operation is prohibited.
- Non-hunting visitors are also enjoying the park during hunting and trapping seasons; they may or may not be wearing blaze orange. Make sure you know where closed areas, campgrounds, buildings, and trails are located to avoid user conflicts. Hunters should be especially aware of gun safety and be certain of your target and what is beyond it.
- Fishing with bow and spears is allowed no closer than 100 yards from a designated swimming beach or boat launch.
- Please see the DNR website or check hunting regulations regarding hunting blinds on state lands.
- All state regulations relating to baiting apply.
- Fires are permitted for campers in designated campfire rings only. No fires are permitted while hunting. Be sure all smoking material is extinguished.
- Certain exemptions from rules are allowed for Class A and certain Class B disabled permit holders.
- Local ordinances may apply within the boundaries of DNR property prohibiting actions such as the discharge of firearms. Please contact local officials for additional details.
- Please respect private lands within or near the state park while enjoying the outdoors.
- **You are responsible for undertaking your recreational activity in a safe and legal manner.**

## It is Illegal to:

- Hunt within 50 feet of a roadway's center or discharge a firearm, bow, crossbow, or air gun from or across a paved park road.
- Discharge a firearm, bow, crossbow, or air gun from, on, or across a state trail corridor or state park area which is closed to hunting.
- Shoot a firearm within 100 yards of a building devoted to human occupancy on lands you do not own without permission.
- Hike or snowshoe on designated cross-country ski trails when the ski trails are snow covered.
- Take, catch, kill, hunt, trap or pursue any wild animal or bird, or discharge any firearm on state park lands closed to hunting.
- Target shoot in a state park.
- Damage trees on state land. Cutting shooting lanes, marking trees, and use of screw-in tree-stands or steps are considered damaging and are illegal.

## Trapping:

- Trapping is allowed in all areas open to hunting, except within 100 yards of a designated trail or other designated use area, such as a campground and a picnic area, as shown on the property's map. Trapping is prohibited in all closed areas. No person may place a trap on dry land unless the trap is an enclosed trigger trap. Completely submerged water set traps are also allowed.

## Hunting and Trapping Hours

- Standard park hours are 6 am – 11 pm. Only registered campers who are in the campground or who are traveling to their campsites and those actively involved in fishing may be in the park after 11 p.m.
- Hunters can enter a state park one hour prior to the daily start of hunting hours. When DNR regulations do not establish daily opening and closing times, hunters and trappers may enter the park one hour prior to sunrise.



**ORDINANCE #O-\_\_-23**

**AMENDMENTS TO CHAPTERS 16 AND 19 OF MARATHON COUNTY GENERAL CODE**

**WHEREAS**, Chapter 16 of the Marathon County General Code of Ordinances sets forth regulations and rules relative to County Forests within Marathon County; and

**WHEREAS**, Chapter 19 of the Marathon County General Code of Ordinances sets forth regulations and rules relative to County Parks within Marathon County; and

**WHEREAS**, the Parks, Recreation and Forestry Department seeks to annually review these ordinance chapters to determine whether any sections require updates; and

**WHEREAS**, on June 27, 2023, the Park Commission approved the attached amendments to Chapter 19 of the Marathon County Code of Ordinances; and

**WHEREAS**, on June 27, 2023, the Forestry and Recreation Committee approved the attached amendments to Chapter 16 of the Marathon County Code of Ordinances; and

**WHEREAS**, on June 27, 2023, the Environmental Resources Committee approved the attached amendments to Chapters 16 and 19 of the Marathon County Code of Ordinances and forwarded the amendments on to the County Board for consideration and adoption.

**NOW, THEREFORE, BE IT RESOLVED** that the Board of Supervisors of the County of Marathon does hereby ordain as follows:

To amend Chapters 16 and 19 of the Marathon County General Code of Ordinances as indicated in the attached documents.

**BE IT FURTHER RESOLVED** that this ordinance shall take effect upon passage and publication as required by law.

Dated the \_\_\_\_ day of July, 2023.

**ENVIRONMENTAL RESOURCES COMMITTEE**

\_\_\_\_\_  
\_\_\_\_\_  
\_\_\_\_\_

Fiscal Impact: None. These code amendments do not make an appropriation; increase or decrease an existing appropriation; increase or decrease a fiscal liability; or create, increase, or decrease any anticipated revenue.

## Chapter 19 PARKS AND RECREATION

### MARATHON COUNTY PARKS

#### Sec. 19.01. General administration and terms.

- (1) *Terms.*
  - (a) *Park Commission.* The term "Park Commission", composed of seven members, ~~is~~ refers to the committee of jurisdiction for Marathon County parklands, hereafter referred to as the "Commission" under this subchapter.
  - (b) *County park.* The terms "County park" and "park" mean all lands and water previously and subsequently acquired by the County for park or recreational purposes or placed under the jurisdiction of the Commission and including without limitation, parks, beaches, and privately owned lands, the use of which has been granted or leased to the County for park, recreational or like public purposes under this subchapter.
- (2) *Scope.*
  - (a) The provisions of this subchapter shall apply to all lands, structures and property owned, leased or administered by the County and under the management, supervision and control of the Commission, except that Marathon Park shall be subject to the right of the Marathon County Agricultural Society to hold an annual fair.
  - (b) The Commission is organized pursuant to §§ 27.02 through 27.05, 27.075 and 27.08, Wis. Stats., and any subsequent amendments thereto.
- (3) *Director.* The Wausau and Marathon County Parks, Recreation, and Forestry Department, whose head shall be the Director, shall be the administrative or executive agency of the Commission. The Director shall be the authorized agent of the Commission as referred to in this subchapter.
- (4) *Closing hours.* No person shall enter or be in any County park between 11:00 p.m. and 6:00 a.m., except registered campers in or en route to designated campgrounds; persons transporting watercraft to and from designated boat landings are permitted at any hour.
- (5) *Fees, charges and deposits.*
  - (a) *Fee schedule.* No person shall use any facility, shelter, land or area for which a fee or charge has been established by the Commission without payment of such a fee or charge.
  - (b) *Deposits.* Shelters or facilities will be reserved upon completion and approval of a use agreement; payment of the rental fee; and payment of the security deposit and/or key deposit if applicable. The key and security deposit will be subject to retention, in whole or part, by the Commission, if the key is not returned; the shelter or facility has been subjected to abuse; inadequately cleaned; or used in violation of current facility use regulations.
- (6) *Additional rules, permits, exceptions.*



- 
- (a) *Additional rules.* Rules and regulations may be made governing the use and enjoyment of all lands, structures and property owned, leased or administered by the County and under the management, supervision and control of the Commission. Any person who shall violate such rules or regulations or who refuses to subject himself or herself thereto may be excluded from the use of such facilities. No person shall disregard posted rules and regulations or engage in any activity contrary to posted notice.
  - (b) *Permits.* Any person to whom a permit has been issued by the Director shall be bound by the provisions of all ordinances of Marathon County as fully as though the same were inserted in each permit. Any permit issued by the department must be displayed as directed by the Commission.
  - (c) *Exceptions.* Nothing in this chapter shall prohibit or hinder the Commission, its Director, Supervisors, Park Managers, ~~Employees~~Rangers or other authorized agents or any law enforcement officers from performing their official duties.
- (7) *Public utilities and private construction.*
- (a) *Public utilities.* The location of all sewers and receivers, gas pipes, water pipes, stopcock boxes, hydrants, lamp posts, telegraph, telephone and electric power posts and lines, manholes, conduit and pumps within any park or parkway shall be subject to the jurisdiction and control of the Commission; and their construction, erection, repair or relocation shall be undertaken only after written permission is received from the Commission.
  - (b) *Private construction.*
    - 1. No curb, whether stone, concrete or grass, shall be cut for the purpose of constructing a private driveway across any parkway border nor for any other purpose, without written permission of the Commission.
    - 2. The location, width, grade and construction of all paths, driveways and roadways across any sidewalk border along any parkway shall be subject to the approval of and constructed only after written permission is obtained from the Commission.
    - 3. Every person who receives a permit to open a trench, cut a curb or deposit materials in or upon any park or parkway shall at all times after such work has been commenced or materials deposited and until the same has been completed and all accumulations of materials resulting from such work have been removed so guard and protect the same that persons driving or passing along the roadway or sidewalk in the vicinity of the place where the work is being done shall not be likely to meet with any accident therefrom; and shall from sunset to sunrise while such work is in progress cause the same to be securely fenced and guarded by a warning light or lights placed in a conspicuous position and so secured that the same shall not be extinguished.

(O-7-01; O-8-03; O-16-13; O-4-19; O-05-21)

## **Sec. 19.02. Public meetings and sales.**

- (1) *Public meetings.*
  - (a) Any person desiring to hold a public meeting of any kind in any park shall first obtain a permit from the Commission or its authorized agent. The permit shall be applied for not less than 48 hours prior to the scheduled event.
  - (b) Permits will be granted for the purpose of holding any lawful public assembly in accordance with published regulations governing the reasonable use of parks.
- (2) *Sales.* No person shall sell or offer for sale any goods, merchandise or service in any park, except as authorized by the Commission and when holding proper licenses.

---

Created: 2023-06-12 09:30:48 [EST]

(Supp. No. 50)

- 
- (3) *Soliciting boat rides.* No person shall use in any manner the dock, pier, wharf, boat landing, mooring facilities in or the waters in or immediately adjacent to any County park for the purpose of soliciting rides of any kind unless authorized by the Commission.
  - (4) *Posting bills or advertising.* No person shall distribute or post bills or advertisements in any park without written consent of the Commission.

(O-7-01; O-4-19)

### Sec. 19.03. Personal conduct and nuisances.

- (1) *Personal conduct.* No person shall engage in violent, abusive, indecent, profane, boisterous, unreasonably loud or otherwise disorderly conduct under circumstances in which the conduct tends to cause or provoke a disturbance in any County park.
- (2) *Property of others.* No person shall disturb, molest or remove the property or personal effects of others.
- (3) *Unreasonable noise.* No person shall make or cause to be made any unreasonably loud sounds or noises under circumstances which tend to annoy or disturb others. No person shall operate any sound truck, loudspeaker, generator, chainsaw, or other device that produces excessive, loud or unusual noises within any County park except upon written permit issued by the Commission or its authorized agent upon such terms and conditions as will ensure that the public peace and order will not be unreasonably disturbed.
- (4) *Jumping and diving.* No person shall jump, dive, or otherwise launch themselves from any bridge, approach, rope or other device similar to a rope swing thereto into any body of water within any County park.
- (5) *Swimming and wading.* No person shall swim or wade within 50 feet of boat launch ramps at any County park except for the express purpose of launching or landing watercraft.
- (6) *Docks and piers.* No person shall use docks or piers adjacent to any boat landing in any manner as to obstruct or hinder the launching, landing, loading or unloading of watercraft.
- (7) *Obstructing.* No person shall knowingly obstruct an ~~employee-ranger~~ or any law enforcement officer while the ~~employee-ranger~~ or law enforcement officer is doing any act in an official capacity and with lawful authority. Obstruct includes without limitation knowingly giving false information with intent to mislead the ~~employee-ranger~~ or law enforcement officer in the performance of duty including the issuance of any citation.

~~(8) *Smoking.* No person may smoke in, or within 50 feet of, the following areas of a County park or outdoor areas of County property or within an area of up to fifty (50) feet of those areas in listed under this section as designated by the Director or his or her designee and posted pursuant to 19.01-6(a):~~

~~(a) Playgrounds.~~

~~(b) Sports fields and sports field seating areas.~~

~~(c) Swimming areas and all inside fenced areas surrounding swimming areas.~~

~~(d) Marathon County Sports Complex located at 602 E Kent Street.~~

~~(e) Those park areas temporarily posted as no smoking by the Director or his or her designee during Parks Department sponsored events.~~

~~(f) Those park areas temporarily posted as no smoking by the Director or his or her designee during an approved event held within the park area and for which no smoking has been requested by the event organizer or sponsor.~~

(O-7-01; O-8-03; O-16-13; O-05-21)

---

Created: 2023-06-12 09:30:48 [EST]

(Supp. No. 50)

---

**Sec. 19.04. Destruction, entry, cleaning and refuse.**

(1) *Destruction and entry.*

- (a) *Deface, remove or destroy.* No person shall disturb, molest, deface, remove or destroy any trees, shrubs, plants, or other natural growth, or natural or archeological feature; disturb or remove shoreline rip-rap; carve on any rocks, archaeological or geological features, signs, walls or structures; drive nails in trees or move, deface or vandalize in any manner any structures including buildings, signs, fences, tables or other County property. Edible fruits, nuts, wild mushrooms and wild asparagus may be picked or gathered without a permit, except on State Natural Areas.
- (b) *Prospecting prohibited.*
  - 1. In this subsection, the term "prospecting" means exploring for the presence of rocks, minerals or fossils by means of relocation, removal or displacement of soil or other organic or inorganic materials.
  - 2. No person may collect, or engage in prospecting for, rocks, minerals, or fossil materials located on any Marathon County Park land or the bed of any body of water located thereon.
- (c) *Entry and manipulation.* No person shall enter in any way any building, installation or area that may be under construction or locked or closed to public use or molest or manipulate any water control structure, dam or culvert or enter or be upon any building, installation or area after the posted closing time or before the posted opening time or contrary to posted notice in any County park.

(2) *Cleaning and refuse.*

- (a) *Washing.* The washing of cars, persons, pets, cooking utensils or clothing is prohibited in any lakes, streams or on any picnic grounds, playgrounds, beaches, recreation areas, boat landings, parking lots or roadways or within 50 feet of any pump, fountain or drinking water outlet in any County park. The washing of persons, cooking utensils and clothing shall be permitted at designated campgrounds or at other authorized and posted locations.
- (b) *Fish and game cleaning.* No person shall clean, butcher, scale or skin any fish, game, livestock or poultry in any County park except that fish may be cleaned at designated fish cleaning tables provided for such purposes. Refuse from such cleaning operations shall be suitably wrapped or packaged and deposited in the refuse containers provided for that purpose.
- (c) *Refuse.*
  - 1. No person shall deposit or leave any garbage, sewage, or other waste material upon any body of water or other area in any County park except in an appropriate solid waste or recycling container.
  - 2. No person shall upset or turn over the contents of any solid waste or recycling container in any County park.
  - 3. Charcoal residue or wood ash shall be left in a grate or fireplace until cool or placed in receptacles provided for such purposes.
  - 4. No person shall deposit or leave any residential or commercial belongings or waste material in any waste receptacle or other area in any County park.
- (d) *Dispensing beverages.* No vendor shall dispense beverages in any cup, glass, flask, bottle or other container made of glass or other shatterable material designed or used for holding a beverage at any outdoor fair, game, attraction, event, or public function. This prohibition does not apply to vendors at any of the above-listed activities serving sit-down meals where the beverage containers are washed



---

and reused. All beverage vendors at any of the above-listed activities shall use recyclable beverage containers and provide adequate collection facilities for the recycling of all beverage containers so used.

(O-7-01; O-8-03; O-17-14; O-05-21; O-38-22)

### **Sec. 19.05. Vehicles.**

(1) *Vehicular traffic.*

- (a) No person shall operate any vehicle at a speed in excess of 15 mph or contrary to official traffic signs in any County park or County trail unless governed by § 7.125 of Marathon County Code of Ordinances.
- (b) No person shall operate a motor vehicle in an abusive, boisterous, unreasonably loud or otherwise disorderly manner under circumstances which tend to cause or provoke a disturbance. Such conduct shall include, but not be limited to, conduct which tends to disturb, annoy or endanger one or more persons because of unnecessary or deliberate spinning of wheels, squealing of tires, revving of engine, blowing the horn, causing engine to backfire or causing vehicle while commencing to move or in motion to raise one or more of its wheels, tracks or skis off the ground or operate at an unreasonable or imprudent speed in any County park.
- (c) No person shall operate or park any motor vehicle except as provided in this subchapter, upon any bridle path, hiking trail, beach area, playground, picnic area or any other area other than established roads, parking areas, boat ramps and service areas or contrary to posted notice or within any park seasonally closed to vehicular traffic.
- (d) No person shall operate a snowmobile as defined in § 340.01(58a), Wis. Stats., in any County park, except on snowmobile trails approved by or for events authorized by the Commission.
- (e) No person shall operate an ATV or UTV as defined in § 340.01(2g), Wis. Stats., in any County park, except on established roads.
- (f) No other motorized vehicles other than an ATV or UTV shall be operated on a designated ATV/UTV trail on park property or County trail with the exception of authorized personnel in the performance of their duties.
- (g) No person may operate a motorized vehicle on County property when rules pertaining to the operation of motorized vehicles are posted by the Commission or its authorized agent.

(2) *Parking.*

- (a) No person shall park, stop or leave standing, whether attended or unattended, any vehicle, obstruction or watercraft:
  - 1. In any manner as to block, obstruct or limit the use of any road, trail, sidewalk, parking lot, boat landing, waterway or winter sport facility.
  - 2. Outside of any area provided for such purposes when it is practical to use such areas.
  - 3. Contrary to posted notice.
- (b) No person shall park, stop or leave standing any vehicle, whether attended or unattended, whether temporarily or otherwise, in areas reserved, by official traffic signs indicating the restriction, for vehicles displaying registration plates or identification cards which designates the vehicle as a vehicle used by a physically disabled person as defined in § 346.505, Wis. Stats.
- (c) No person shall park, stop or leave standing any vehicle, whether attended or unattended, whether temporary or otherwise, in areas designated as fire lanes with signs or marked curbs.

---

Created: 2023-06-12 09:30:48 [EST]

(Supp. No. 50)

- 
- (d) The forfeiture for a violation of paragraph (a) shall be \$10.00. The forfeiture for a violation of paragraph (b) or (c) shall be \$30.00. In the event that the violator fails to appear in court on the date and time indicated on the citation, or fails to enter a "not guilty" plea by mail by the court date, or fails to stipulate to the violation by posting the forfeiture required in the office of the Marathon County Clerk of Courts, at the address indicated on the citation by the court date, said forfeiture shall be ordered by the court in default and shall be increased by the amount of \$30.00 as a penalty for failure to pay in a timely fashion, for a total forfeiture of \$40.00 for a violation of paragraph (a) and \$60.00 for a violation of paragraph (b) or (c).
  - (e) The provisions of § 345.28, Wis. Stats., and any subsequent amendments thereto, are specifically adopted and incorporated herein by reference. If the alleged violator fails to pay the amount of the forfeiture as provided herein, or to appear in court, the County may take any or all of the actions authorized under § 345.28, Wis. Stats.
  - (f) The registered owner of a vehicle is deemed to have authorized the parking of a vehicle found parked in violation of this subsection.
- (3) *Abandoned vehicles.* No person shall leave any vehicle unattended without approval of the Commission or its authorized agent for more than 48 hours under such circumstance as to cause the vehicle to reasonably appear to have been abandoned. An abandoned vehicle shall constitute a public nuisance and be subject to removal at the owner's expense. Removal of the vehicle shall not relieve the owner or the operator of the vehicle from any penalty incurred because of such violation.

(O-7-01; O-8-03; O-05-21; O-38-22)

#### **Sec. 19.06. Fires, fireworks, firearms, projectiles.**

- (1) *Fires.*
  - (a) *Marathon Park.*
    - 1. Except for cooking with charcoal, gas or liquid fuel on commercially manufactured portable metal grills or stoves, there shall be no open fires in Marathon Park, except as provided in paragraph 3.
    - 2. Portable metal grills and stoves acceptable in Marathon Park shall include only commercially manufactured devices intended for cooking. Homemade devices or manufactured portable fire places or other manufactured devices, which have been modified by the user, shall not be used.
    - 3. Fires other than those provided for in paragraph 1 may be made by permit only. Said permit must be obtained from the Wausau City Fire Department pursuant to the Wausau Municipal Code.
  - (b) *Other County Parks.*
    - 1. No person shall start, tend or maintain any fire or burn any refuse except at designated fireplaces, fire rings or permanent grills within any county park other than Marathon Park.
    - 2. Fires for cooking or heating may be made in portable metal stoves, heaters, grills or fireplaces at picnic areas or designated campgrounds.
  - (c) No person shall abandon any fire or leave any fire unattended or throw away any matches, cigarettes, cigars, pipe ashes or embers without first extinguishing them. No person shall start, tend or use in any manner any fire contrary to posted notice in any county park.
- (2) *Fireworks.* No person shall possess or discharge any fireworks regulated by § 167.10(1), Wis. Stats. in any County park except that exhibitions of fireworks given under the direction or by the permission of the Commission or its authorized agent are permitted.

---

Created: 2023-06-12 09:30:48 [EST]

---

(3) *Firearms.*

- (a) No person shall discharge any firearm as defined in § 167.31(1)(c), Wis. Stats., or airgun as defined in § 939.22, Wis. Stats., or any bow in any County park, except that portion of Shooting Range Park north of Four Mile Creek where the use of firearms, airguns or bows is permitted on designated ranges in accordance with posted regulations.
- (b) Unless other facts and circumstances that indicate a criminal or malicious intent on the part of the person apply, a person is not in violation of, and may not be charged with a violation of, this section for loading, carrying, or going armed with a firearm, without regard to whether the firearm is loaded or is concealed or openly carried.
- (c) This section does not apply and may not be enforced if the actor's conduct is justified or, had it been subject to a criminal penalty, would have been subject to a defense described in § 939.45, Wis. Stats.
- (d) No person, except a law enforcement officer, shall enter any building, facility, or location open to the public that is restricted by state law or posted as a no firearms or concealed weapons location while possessing, carrying, or concealing a firearm or weapon, whether with or without a state permit.

(4) *Shooting range park.*

- (a) No person shall discharge any firearm, airgun or bow in any area within Shooting Range Park not specifically designated for such use or contrary to posted regulations or contrary to verbal orders given by the Rangemaster on duty. This paragraph shall apply to any person discharging any firearm at a rate of fire deemed unsafe in the judgment of the Rangemaster, including bump firing to simulate the discharge of automatic firearms.
- (b) No person shall possess or discharge any fully automatic or machine gun or load or discharge any firearm deemed unsafe in the judgment of the Rangemaster or load any firearm with or discharge any armor piercing or incendiary ammunition at Shooting Range Park. This paragraph shall not apply to authorized military or law enforcement training exercises.
- (c) No person shall engage in any sport or activity while in possession of an uncased firearm, airgun or bow which, in the judgment of any law enforcement officer or the Rangemaster, constitutes a safety hazard.

(5) *Throwing or shooting projectiles.* No person shall throw or shoot an arrow, knife, stone, paintball or other projectile, by hand or any other means, in any County park. This subsection shall not apply to arrows used on archery ranges authorized by the Commission.

(O-17-98; O-7-01; O-8-03; O-10-11; O-16-13)

**Sec. 19.07. Animals.**

(1) *Animals in public facilities.*

- (a) *Restricted.* No person having immediate custody, care or control of a dog or other animal, shall permit said animal to enter and/or remain in any public park building, bathing beach, the Marathon County Sports Complex, the Marathon Park Amphitheater or playground safety surface area in any County park, except assistance dogs or animals being used or trained to assist emergency services workers or as authorized by the Commission or their designee.
- (b) *Definitions.* The following terms shall have the meanings indicated:  
*Assistance dog.* Any dog that has been or is being trained as a guide dog, hearing dog, or service dog. Such terms are further defined as follows:



---

*Guide dog.* Any dog that has been or is being specially trained to aid a particular blind or visually impaired person.

*Hearing dog.* Any dog that has been or is being specially trained to aid a particular deaf or hard of hearing person.

*Service dog.* Any dog that has been or is being specially trained to aid a person with a disability other than sight or hearing.

- (2) *Animals running at large.* No person shall allow a dog or other animal to run at large in any County park. The animal shall be considered as running at large unless it is on a leash no more than 16 feet in length, is in or upon a vehicle, is in or on the property of its owner or another who does not object to the presence of such animal, or is part of a 4-H project, is on a display for judging purposes, is in an itinerant or transient carnival, circus or other like show, is in a dog or cat show or trial, or is part of the program of a public or private educational institution as authorized by the Commission or in designated areas as set by the Commission.
- (3) *Howling animals.* No person shall own, keep, possess or harbor a dog or other animal in any County park which by frequent or habitual howling, yelping, barking or wailing disturbs other persons.
- (4) *Animal feces.*
- (a) The owner or person having immediate care, custody or control of a dog or other animal shall promptly remove and dispose of, in a sanitary manner, any feces left or deposited by the animal upon any County park.
  - (b) No person shall permit a dog or other animal to be in any County park unless such person has, in his immediate possession, an appropriate means of removing animal feces.
- (5) *Horses.*
- (a) No person shall ride or use a horse or other beast of burden in any manner in any County park, except on designated bridle trails or for events authorized by the Commission.
  - (b) No person shall ride or use a horse or other beast of burden in a careless, negligent or reckless manner so as to create a nuisance or to endanger the life, property or person of others.
- (6) *Hunting and trapping.*
- (a) *Restricted.* No person shall take, catch, kill, hunt, trap, pursue or otherwise disturb any wild animals or birds in any County park, except
    - 1. ~~that~~ waterfowl, as that term is defined herein, may be hunted from a blind, as that term is defined herein, in accordance with applicable State statutes and applicable provisions of the Wisconsin Administrative Code setting forth regulations of the Department of Natural Resources, placed below the ordinary high watermark, as that term is defined herein, at Big Eau Pleine and Ashley Parks. A blind may be established not more than seven days prior to the opening of the waterfowl hunting season and must be removed by the owner within seven days after the close of the season. Any blind on park property used in hunting waterfowl must bear the name, address, and phone number of the owner affixed permanently to the blind in lettering one inch square or larger.
    - 2. Archery hunting is permitted in areas of Big Eau Pleine Park, north of the fork in the road leading to each campground, only during the open season from November 15 through the Sunday nearest January 6. Archery hunters must be 50 feet from a designated trail. Access to the park for the purpose of hunting is allowed starting at 6 a.m. or one hour prior to shooting hours until 11 p.m.
  - (b) *Definitions.* The following terms shall have the meanings indicated:
    - Blind.* Any permanent structure used in hunting waterfowl, which is not removed at the end of hunting hours each day.

Formatted: Indent: First line: 0"

---

*Ordinary high watermark.* The point on the bank or shore up to which the presence and action of surface water is so continuous as to leave a distinctive mark, such as by erosion, destruction or prevention of terrestrial vegetation, predominance of aquatic vegetation or other easily recognized characteristic. Where the bank or shore at any particular place is of such character that it is difficult or impossible to ascertain where the point of ordinary high-water is, recourse may be had to the opposite bank of a stream or to other places on the shore of a lake or flowage to determine whether a given stage of water is above or below the ordinary high watermark.

*Waterfowl.* Includes wild geese, brant, wild ducks, rails, coots, gallinules, jacksnipe, woodcock, plovers, sandpipers and wild swan.

- (c) *Penalty.* Violations of this subsection shall be punishable as provided in § 19.14 of this chapter relating to hunting and trapping violations.

(O-15-90; O-7-01; O-8-03; O-16-13; O-13-15; O-05-21; O-40-21)

### Sec. 19.08. Athletics.

- (1) *Golf and archery.* No person shall use golf or archery equipment within any County park or parkway except upon golf facilities or archery ranges established by the Commission.
- (2) *Roller skates, skateboards, and scooters.* No person shall ride, push or travel upon roller skates, in-line skates, skateboards, or scooters within any public buildings or on any facilities not specifically intended for such use including, but not limited to: tennis courts, benches, tables, bleachers or on docks and piers adjacent to any boat landing within any County park, except in designated areas and in accordance with posted regulations.
- (3) *Ice skating.* No person shall play or practice hockey, broomball or any other games or sports that may interfere with casual ice skaters, when casual skaters are present on outdoor ice skating rinks established by the Commission, except hockey and broomball may be played on designated hockey rinks.
- (4) *Hiking, walking or running on groomed ski, fat tire bike and snowshoe trails.* No person shall hike, walk or run on any designated groomed cross-country ski, fat tire bike or ~~and~~ snowshoe trails during that period of the year when such trails are open or being groomed for opening for cross-country skiing, fat tire biking or snowshoeing unless in the case of an emergency or injury.

(a) Definitions. The following terms shall have the meaning indicated:²

1. Fat tire bike. Any bike that has tires that are 3.8 inches wide or larger

2. Snowshoe. A flat device resembling a racket, which is attached to the sole of a boot and used for walking on snow.

(O-7-01; O-8-03; O-05-21; O-38-22)

### Sec. 19.09. Beaches.

- (1) *Food and beverage.* No person shall carry or consume any food or beverages on any bathing beach or in the water adjacent to any bathing beach in any County park except in designated areas.
- (2) *Boundary buoys.* No person shall disturb or molest a bathing beach boundary buoy or marker in any swimming beach in any County park or moor or cause to be within that area of water enclosed by boundary buoys any boat, raft or craft used to transport persons.

- 
- (3) *Beach athletics.* Except in locations designated for such purpose, no person shall engage in any athletic game or sport or in any activity upon a bathing beach or in the water when injury or inconvenience to others might result therefrom.
  - (4) *Bathing dress.* No swimmer or bather shall enter the water or onto any bathing beach unless clothed in a suitable bathing dress or suit.
  - (5) *Changing clothing.* No person shall change clothes, except in beach houses or other enclosed places.
  - (6) *Fishing.* No person may fish in any marked swimming beach area.
  - (7) *Glass containers.* Container made of glass or other shatterable material are prohibited.
- (O-7-01; O-05-21)

**Sec. 19.10. Camping.**

- (1) *Definitions.* The following terms shall have the meanings indicated:
  - Campground, designated.* Any tract of land designated exclusively for camping.
  - Campground, general.* Any tract of land designated for camping by camping parties.
  - Campground, group.* A campground which may be reserved for use by an assemblage of one or more families, nonfamily groups or juvenile groups.
  - Camping or camp.* The use of a shelter such as a tent, trailer, motor vehicle, tarpaulin, bedroll or sleeping bag for temporary residence or sleeping purposes.
  - Camping party.* Any individual, family, or nonfamily group occupying a campsite.
  - Camping unit.* Any single shelter except bedrolls and sleeping bags used for a camp by a camping party.
  - Campsite.* A segment of a campground which is designated for camping use by a camping unit or camping party.
  - Closed shelter.* Any building or structure capable of being closed to public access and reserved for public or private group activities.
  - Family.* A camping party composed of a parent or parents with their unemancipated children.
  - Individual group.* A camping party of not more than five unrelated persons occupying one camp site.
  - Juvenile group.* A camping party composed of not more than ten juveniles under the leadership of an adult.
  - Nonfamily group.* A camping party composed of five or less persons who do not meet the definition of family.
- (2) *Camping regulations.*
  - (a) *Camping prohibited.* Camping is prohibited in all County parks, except at designated campgrounds, or other areas authorized by the Commission.
  - (b) *Designated campgrounds.* Designated campgrounds are those general and group campgrounds in Big Eau Pleine, Dells of the Eau Claire and Marathon Parks.
  - (c) *Camping permit.* No person shall set up camp prior to completing and displaying a camping permit. All camping fees shall be prepaid for the permit period prior to occupying the campsite as provided in subsection 19.01(5)(a) of this chapter relating to a fee or charge established by the Commission.

- 
- (d) *Camping limited, designated campgrounds.* No person shall camp and no camping unit shall remain in a designated campground for a period greater than 14 consecutive days. The camping unit shall be removed from the property for at least 7 days before being eligible to return.
  - (e) *Campsite occupancy.*
    - 1. No more than one camping party shall occupy a single campsite.
    - 2. No camping party consisting of a nonfamily group shall exceed five persons.
  - (f) *Campsite changes.* No camping party shall move from its assigned campsite to another campsite without prior approval.
  - (g) *Camping permit expiration.* All camping permits expire at 3 p.m. on the last day of the permit period.
  - (h) *Camping permit extensions.* Extensions within the 14 day limit may be granted on camping permits. Extensions shall be obtained prior to 10 a.m. on the expiration date of the permit.
  - (i) *Campsite entry hours.* No camping party shall start setting up or taking down its camping unit between the hours of 11 p.m. and 6 a.m.
  - (j) *Campsite parking.* No person shall park any motor vehicle outside the parking area designated at each campsite and not more than two motor vehicles are permitted to any campsite except that as many as five motorcycles are permitted for members of a camping party registered as a nonfamily group.
  - (k) *Campsite reservations.* Campsite reservations will be accepted only for group campgrounds and designated campsites within a general campground.
  - (l) *Camping party membership.* No person shall obtain a camping permit for use by a camping party of which he is not a member in a general campground.
  - (m) *Campsite capacity.* No more than two sleeping units may occupy a campsite. Two units may consist of one travel trailer, pickup truck camper or motor home and one tent or two tents with no camper. Pickup campers or motor homes towing a trailer shall be treated as a single unit.
  - (n) *Camping contrary to posted notice.* No person shall camp on any lands under the management, supervision or control of the Commission contrary to posted notice.
  - (o) *Camping violations.* Violation of any State law or any rules of the Commission by a member of a camping party is cause for revocation of the camping permit.
  - (p) *Campground quiet hours.* No person shall make or cause to be made any unreasonable sounds or noises in or adjacent to any designated campground as provided in subsection 19.03(3) of this chapter between the hours of 10:00 p.m. and 6:00 a.m. Beaches and shelters are closed after park hours except in cases of emergency.

(O-7-01; O-8-03; O-16-13; O-05-21; O-38-22)

### **Sec. 19.11. Boating.**

- (1) *Mission Lake boating regulations.*
  - (a) *Speed limit.* No person shall operate any watercraft in excess of five mph on Mission Lake, Town of Reid.
  - (b) *Mooring.* No person shall moor any watercraft for more than 24 hours on the water adjacent to or on the shore of Mission Lake Park.

---

Created: 2023-06-12 09:30:48 [EST]

(Supp. No. 50)



- (2) *Motorboats, Sunny Vale Lake.* No person shall operate a motorboat of any kind in any manner on Sunny Vale Lake within Sunny Vale Park.
- (3) *State boating and water safety laws adopted.* The statutory provisions describing and defining regulations with respect to water traffic, boats, boating and related water activities and safety found in § 30.68, Wis. Stats., Restricted Areas, are hereby adopted and by reference made a part of this section.

**Sec. 19.12. Jurisdiction over minors and underage persons.**

Any and all County ordinances conferring jurisdiction on the Circuit Court for persons 12 years of age or older, including all subsequent amendments and/or revisions thereto, are hereby adopted and by reference made a part of this section.

(O-7-01)

**Sec. 19.13. Legal action.**

- (1) *Civil action.* Whenever an arrest shall have been made or any violation shall occur, the District Attorney shall prosecute as provided by law.
- (2) *Arrest powers.* Any law enforcement officer of the County or any of its municipal subdivisions may without a warrant arrest any offender whom he may detect in the violation of any of the provisions of this chapter and take the person so arrested immediately before a magistrate having competent jurisdiction and he shall have at all times the right to enter the premises of any building, structure or enclosure in any park or parkway, including such grounds, buildings, structures or enclosures which may be leased or set aside for private or exclusive use of any individual or group of individuals for the purpose of arresting violators and may use all necessary means to attain that end.
- (3) *Citation.*
  - (a) *Authority to issue.* Citations for violations of this chapter may be issued by any law enforcement officer or by the Director and those administrative, supervisory or managerial Wausau and Marathon County Parks, Recreation, and Forestry Department personnel delegated by the Director and listed below:  
[Assistant Director of Operations;](#)  
 Assistant [Parks and Recreation](#) Directors [of Community Services;](#)  
 Facility Managers;  
 Motorized Recreation Coordinator.
  - (b) *Format.* The citation issued for violations of this chapter shall be Parks, Recreation and Forestry Department Form P-451, "Uniform Citation" or equivalent, except for certain violations of §§ 19.12 and 19.23, where State Form GF-116, "Wisconsin Uniform Citation Underage Alcohol Offenses or Harassment" or current equivalent, shall be used.

(O-7-01; O-8-03; O-16-13; O-12-15; O-05-21)

**Sec. 19.14. Schedule of cash deposits, County parks.**

Section	Title	Deposit
19.01(4)	Closing Hours	\$30.00
19.01(5)	Fees, Charges and Deposits	20.00

Created: 2023-06-12 09:30:48 [EST]

(Supp. No. 50)

19.01(6)(a)	Additional Rules	20.00
19.01(7)(b)	Private Construction	50.00
19.02(1)	Public Meetings	40.00
19.02(2)	Sales	40.00
19.02(3)	Soliciting Boat Rides	40.00
19.02(4)	Posting Bills or Advertising	40.00
19.03(1)	Personal Conduct	40.00
19.03(2)	Property of Others	50.00
19.03(3)	Unreasonable Noise	20.00
19.03(4)	Jumping and Diving	20.00
19.03(5)	Swimming and Wading	10.00
19.03(6)	Docks and Piers	10.00
19.03(7)	Obstructing	40.00
19.04(1)(a)	Deface, Remove or Destroy (Plus Restitution for Damages)	50.00
19.04(1)(b)	Prospecting Prohibited	50.00
19.04(1)(c)	Entry and Manipulation	30.00
19.04(2)(a)	Washing	20.00
19.04(2)(b)	Fish and Game Cleaning	20.00
19.04(2)(c)	Refuse	50.00
19.04(2)(d)	Dispensing Beverages	50.00
19.05(1)	Vehicular Traffic	40.00
19.05(3)	Abandoned Vehicles	40.00
19.06(1)	Fires	30.00
19.06(2)	Fireworks	30.00
19.06(3)	Firearms	50.00
19.06(4)	Shooting Range Park	50.00
19.06(5)	Throwing or Shooting Projectiles	30.00
19.07(1)	Animals in Public Facilities	10.00
19.07(2)	Animals Running at Large	10.00
19.07(3)	Howling Animals	10.00
19.07(4)	Animal Feces	10.00
19.07(5)	Horses	10.00
19.07(6)	Hunting and Trapping	50.00
19.08	Athletics	10.00
19.09(1)	Food and Beverage	10.00
19.09(2)	Boundary Buoys	50.00
19.09(3)	Beach Athletics	10.00
19.09(4)	Bathing Dress	10.00
19.09(5)	Changing Clothing	10.00
19.10(2)(a)	Camping Prohibited	20.00
19.10(2)(c)	Camping Limited, Camping Permit	20.00

Created: 2023-06-12 09:30:49 [EST]

(Supp. No. 50)

19.10(2)(d)	Camping Limited, Designated Campgrounds	20.00
19.10(2)(e)	Campsite Occupancy	20.00
19.10(2)(f)	Campsite Changes	10.00
19.10(2)(g)	Camping Permit Expiration	10.00
19.10(2)(i)	Campsite Entry Hours	10.00
19.10(2)(j)	Campsite Parking	10.00
19.10(2)(l)	Camping Party Membership	10.00
19.10(2)(m)	Campsite Capacity	10.00
19.10(2)(n)	Camping Contrary to Posted Notice	20.00
19.10(2)(p)	Campground Quiet Hours	20.00
19.11(1)	Mission Lake Boating Regulations	30.00
19.11(2)	Motor Boats, Sunny Vale Lake	30.00
19.11(3)	State Boating and Water Safety Laws Adopted	50.00

(O-7-01; O-8-03; O-16-13; O-17-15; O-4-19)

# D.C. Everest County Park

Imm St.

3RD St.

Cottage St.

Picnic Area

Lake Wausau

Lake Wausau



## Legend

Park Roads

**P** - Parking

- Boat Launch

- Open Shelters

- Restroom

- Grand Stands

0 75 150 300  
 Feet

Revised Oct. 2019

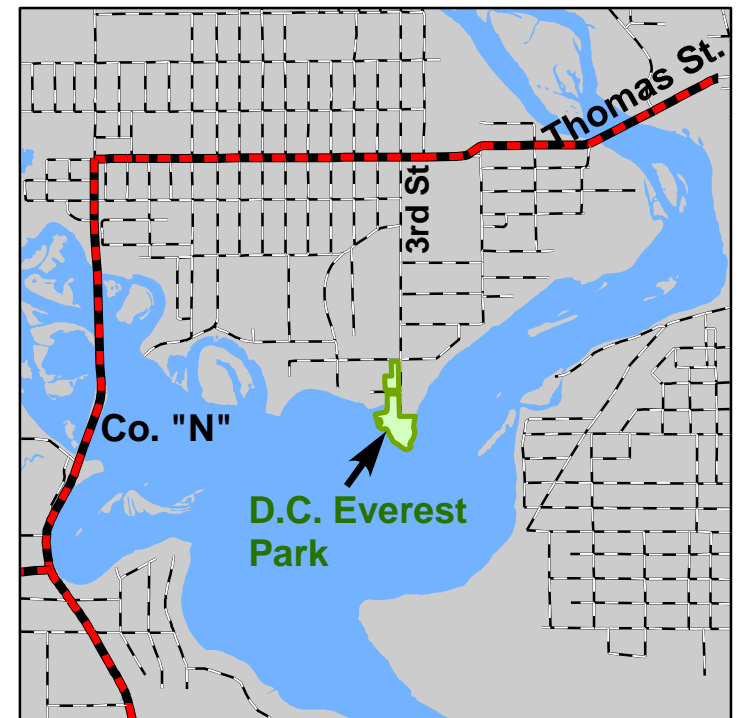

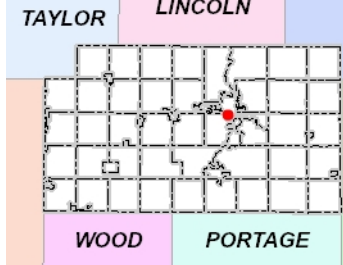

### Legend

- Road Names
- Parcels
- Parcel Lot Lines
- Section Lines/Numbers
- Right Of Ways
- Named Places
- Municipalities
- 2020 Orthos Countywide
  - Red: Band\_1
  - Green: Band\_2
  - Blue: Band\_3

150.11 0 150.11 Feet



NAD\_1983\_HARN\_WISCRS\_Marathon\_County\_Feet

**DISCLAIMER:** The information and depictions herein are for informational purposes and Marathon County-City of Wausau specifically disclaims accuracy in this reproduction and specifically admonishes and advises that if specific and precise accuracy is required, the same should be determined by procurement of certified maps, surveys, plats, Flood Insurance Studies, or other official means. Marathon County-City of Wausau will not be responsible for any damages which result from third party use of the information and depictions herein or for use which ignores this warning.  
**THIS MAP IS NOT TO BE USED FOR NAVIGATION**

### Notes

DC Everest Park



TO ACQUIRE TWO PARCELS OF PROPERTY ADJACENT TO  
D.C. EVEREST PARK BY PURCHASE/GIFT

WHEREAS, the Marathon County Park Department and Marathon County Park Commission have entered into discussions with the owner of two parcels of real estate adjacent to D.C. Everest Park as set forth in the attached map entitled Exhibit "A", having a legal description as further set forth herein; and

WHEREAS, Firststar Bank., N.A. is the titleholder to said property as Trustee for members of the Buska family; and

WHEREAS, an offer has been made to the Marathon County Park Department and Marathon County Park Commission to purchase the southern parcel for \$52,000.00 and the northern parcel would be donated as a gift to Marathon County without reservations, covenants, or restrictions on clear title of any type whatsoever; and

WHEREAS, acquisition of said property would allow increased parking and expanded park and recreation areas at D.C. Everest Park; and

WHEREAS, the acquisition of said property has been reviewed and recommended for approval by both the Marathon County Park Commission and the Finance and Property Committee.

NOW, THEREFORE, the County Board of Supervisors of the County of Marathon does hereby ordain and resolve as follows: To acquire the following parcel of property adjacent to D.C. Everest Park, namely:

That part of Lots four (4) and ten (10) in Block three (3) of Williams and Emter's Outlots, in the Town of Rib Mountain (now City of Wausau), Marathon County, Wisconsin, included in Certified Survey Map No. 2372 recorded in the office of the Register of Deeds for Marathon County, Wisconsin, in volume 9 of Certified Survey Map on page 156; being a part of Lots four (4) and ten (10) in Block three (3) of Williams and Emter's Outlots, in the Town of Rib Mountain (now City of Wausau), Marathon County, Wisconsin.

Tax Key: 2807-021-189 PIN: 37-291-4-2807-021-0189

Parcel one (1) of Certified Survey Map No. 11813 recorded in the office of the Register of Deeds for Marathon County, Wisconsin, in Volume 50 of Certified Survey Maps on page 101; being a part of Lot five (5) in Block five (5) and the South twenty-five (25) feet of vacated Cottage Street, all in Williams and Emter's Outlots in the Town of Rib Mountain (now City of Wausau); and part of Government Lot two (2) in Section two (2), Township twenty-eight (28) North, Range seven (7) East, in the City of Wausau, Marathon County, Wisconsin; subject to easements of record.

Tax Key: 2807-021-191 PIN: 37-291-4-2807-021-0191

Said property to be acquired for the total purchase price of \$52,000.00 for the southern parcel and the northern parcel to be deeded to Marathon County as a gift without reservations, covenants or restrictions on clear title of any type whatsoever.

BE IT FURTHER RESOLVED that the County Administrator, County Clerk, Park Department Director and other appropriate County officials are authorized to execute any and all documents necessary to complete this acquisition under the terms set forth herein.

BE IT FURTHER RESOLVED that the County Clerk is directed to issue checks pursuant to this resolution and the Treasurer to honor said checks.

Dated this 23<sup>rd</sup> day of July, 2002.

FINANCE AND PROPERTY COMMITTEE

<u><i>Jary Wynor</i></u>	_____
<u><i>Frank Gebel</i></u>	_____
<u><i>JCS</i></u>	<u><i>Elmer Berg</i></u>
<u><i>Robert W. ...</i></u>	_____

MARATHON COUNTY PARK COMMISSION

<u><i>Jary Wynor</i></u>	_____
_____	_____
<u><i>Robert W. ...</i></u>	<u><i>Elroy Zinke</i></u>

**Fiscal Impact Estimate:** No tax levy budgetary impact. Purchase price of \$52,000.00 will be taken from the segregated Park Land and Products Account.

TPF:cmk  
Attachment  
a:\cobd#4/everestpark.res





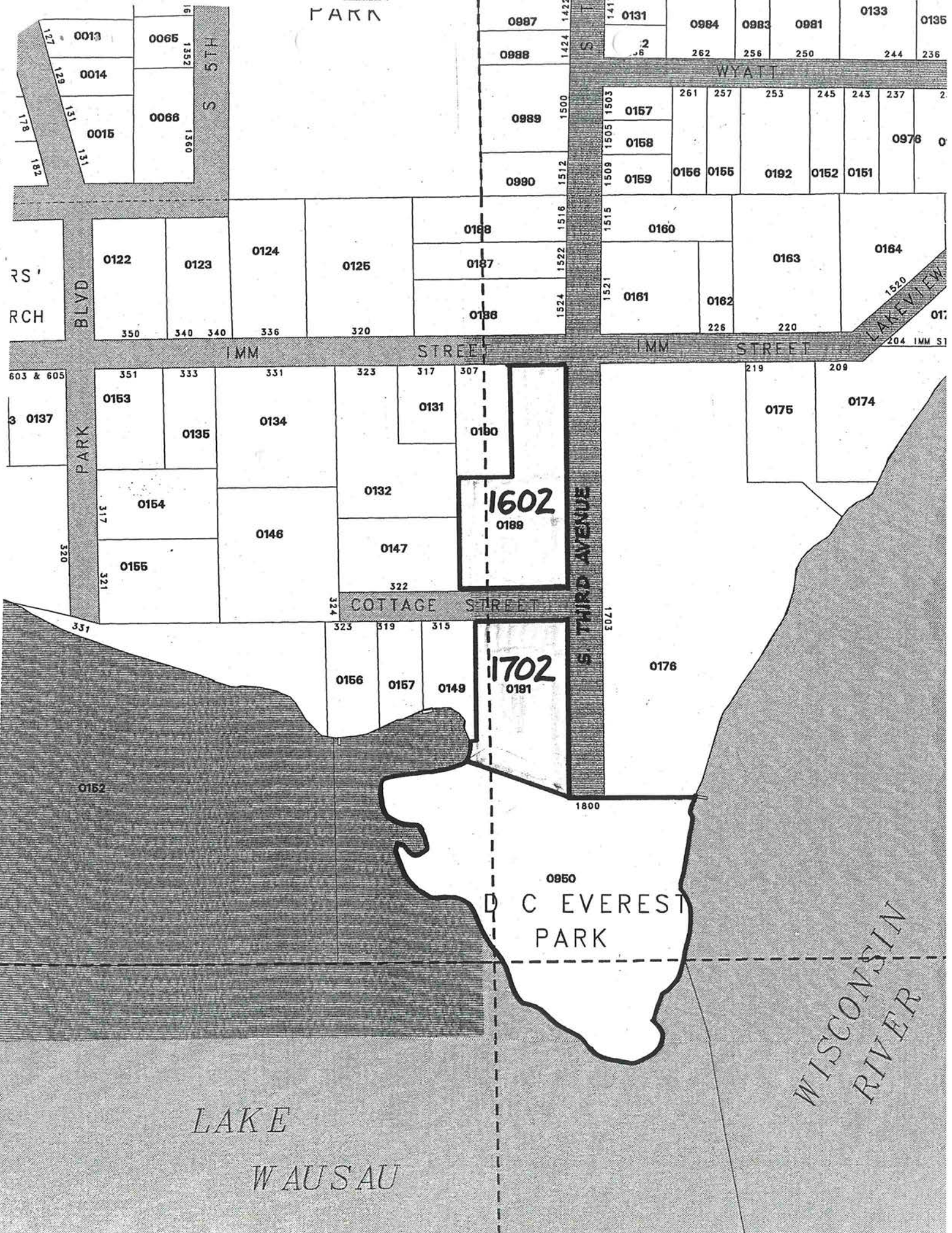

PARK

0987

0131

0984

0983

0981

0133

0135

0013

0065

0988

WYATT

0014

0086

0989

0157

261

257

253

245

243

237

2

0015

0158

0976

0

0990

0159

0156

0155

0192

0152

0151

0122

0123

0124

0125

0188

0160

0163

0164

0123

0187

0161

0162

0161

0124

0186

226

220

350

340

340

336

320

017

350

340

340

336

320

204

IMM ST

IMM

STREET

IMM

STREET

603 & 605

351

333

331

323

317

307

219

209

0137

0153

0135

0134

0131

0130

0175

0174

0154

0135

0134

0132

0131

0130

0155

0146

0147

0147

0160

317

0154

0146

0147

0147

0160

0155

0146

0147

0147

0160

320

0155

0146

0147

0147

0160

321

0155

0146

0147

0147

0160

324

0155

0146

0147

0147

0160

331

0155

0146

0147

0147

0160

337

0155

0146

0147

0147

0160

337

0155

0146

0147

0147

0160

337

0155

0146

0147

0147

0160

337

0155

0146

0147

0147

0160

337

0155

0146

0147

0147

0160

337

0155

0146

0147

0147

0160

337

0155

0146

0147

0147

0160

337

0155

0146

0147

0147

0160

337

0155

0146

0147

0147

0160

337

0155

0146

0147

0147

0160

337

0155

0146

0147

0147

0160

337

0155

0146

0147

0147

0160

337

0155

0146

0147

0147

0160

337

0155

0146

0147

0147

0160

337

0155

0146

0147

0147

0160

337

0155

0146

0147

0147

0160

337

0155

0146

0147

0147

0160

337

0155

0146

0147

0147

0160

337

0155

0146

0147

0147

0160

337

0155

0146

0147

0147

0160

337

0155

0146

0147

0147

0160

337

0155

0146

0147

0147

0160

337

0155

0146

0147

0147

0160

337

0155

0146

0147

0147

0160

337

0155

0146

0147

0147

0160

1602  
0189  
1702  
0181  
D C EVEREST  
PARK

WISCONSIN  
RIVER

LAKE  
WAUSAU





### **Designation of July as Park and Recreation Month**

WHEREAS parks and recreation is an integral part of communities throughout this country, including Marathon County; and

WHEREAS parks and recreation promotes health and wellness, improving the physical and mental health of people who live near parks; and

WHEREAS parks and recreation promotes time spent in nature, which positively impacts mental health by increasing cognitive performance and well-being, and alleviating illnesses such as depression, attention deficit disorders, and Alzheimers; and

WHEREAS parks and recreation encourages physical activities by providing space for popular sports, hiking trails, swimming pools and many other activities designed to promote active lifestyles; and

WHEREAS park and recreation programming and education activities, such as out- of-school time programming, youth sports and environmental education, are critical to childhood development; and

WHEREAS parks and recreation increases a community's economic prosperity through increased property values, expansion of the local tax base, increased tourism, the attraction and retention of businesses, and crime reduction; and

WHEREAS parks and recreation is fundamental to the environmental well-being of our community; and

WHEREAS parks and recreation is essential and adaptable infrastructure that makes our communities resilient in the face of natural disasters and climate change; and

WHEREAS our parks and natural recreation areas ensure the ecological beauty of our community and provide a place for children and adults to connect with nature and recreate outdoors; and

WHEREAS the U.S. House of Representatives has designated July as Parks and Recreation Month; and

WHEREAS Marathon County recognizes the benefits derived from parks and recreation resources.

NOW THEREFORE, BE IT RESOLVED BY the Marathon County Park Commission that July is recognized as Park and Recreation Month in the county of Marathon.

Signed this 27th day of June, 2023 by the President of the Marathon County Park Commission,

---

Rick Seefeldt, President



# MARATHON COUNTY SPORTING HERITAGE YOUTH DAY

*PASSING ALONG OUTDOOR TRADITIONS*

June 20, 2023

Marathon County Parks Department  
Attention: Jamie Polley  
212 River Drive  
Wausau, WI 54401

Subject: Sporting Heritage Youth Day

Dear Jamie:

I am delivering this letter to thank you and the Park's Department for all your help with last August's Sporting Heritage Youth Day. For the 17<sup>th</sup> year we did our best to get kids involved in the outdoors and the involvement of the Park's Department was very much appreciated. The Park's Department allowing us to use the three ranges at Shooting Range Park is key to the success of our event. The kids that attend the event would have little or no exposure to the shooting sports if not for the use of your ranges. I usually use the first paragraph of the yearly thank you letter to tell you a good story about the day. That is a little harder after last year's event with the rain that continued for the entire event and caused us to shut things down two hours early. However, I just want to say that the thing that impressed me is how the kids hung in there and kept going even though they were wet and cold. I did not have one adult question the decision the close down early but the kids complained that they wanted to keep going. I did not think that was possible as some kids were not dressed for the cold and rain and I was afraid we would have some problems if we kept going.

To give you a rundown on the 2022 event, we had 190 kids sign up. We were on pace to have our largest event ever. However, with the rain, we had 41 no-shows, meaning we had 149 youth that attended. When we had our raffle at the end of the day, 120 kids were there to claim a raffle prize so only 29 left early because of the rain (and I am guessing that was more of a parental decision than that of the kids).

Again, there were an amazing number of instructors who willingly donated their time to the kids. The stations for 2022 included: **WI Trapper's Association**, trapping demonstrations; **National Wild Turkey Federation**, turkey hunting clinic and BB gun shoot; **Wausau School District**, .22 range; **Weston Hit and Miss Trap Club**, trap shooting range; **Weston Safety Instructors**, tree stand safety station; **Rib Mountain Bowmen**, archery range; **Elks Lodge #248**, drug awareness trailer; **Wausau Noon Optimists**, GPS instruction; **Bill's Musky Club**, bait casting instruction and contest; **Rocky Mountain Elk Foundation's** optics demonstration; **RMEF's** muzzleloader shoot; **WI Conservation Warden Association**, laser shot; **The**





Page 2

**Kayak Guys** hands-on kayaks, **Golden Sands** invasive species station; **Pheasants Forever**, shoot/don't shoot, habitat display and corn give-away **Wisconsin Hunter Education Instructor's Association**, pellet gun range, **K9 Detective Agency's** bloodhound tracking and the **BetterLife** bike give-away.

As a sponsor for our 2022 event, I again want to thank you for all your help. The event was again free to the kids and their families. I sincerely hope that you will continue to be involved in the future. The date for the 2023 event will be August 26<sup>th</sup>, which would be our 18th event. Hopefully you all can be able to help with "*Passing along Outdoor Traditions*" in 2023.

If you have any question, please give me a call or email me at [randyf@mtc.net](mailto:randyf@mtc.net).

Thank you.

Sincerely,

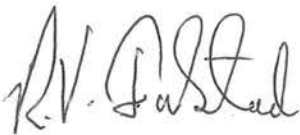

Randy Falstad  
Coordinator

